

WICHITA BRANCH

CONFIDENTIAL

KANSAS DRILLERS LOG

S. 31 T. 16 R. 7 E
Center SW SE

API No. 15 - 127 - 20222
County Number

County Morris

Operator
Benson Mineral Group, Inc.
Address
1400 Metro Bank Bldg., 475 17th St., Denver, CO 80202

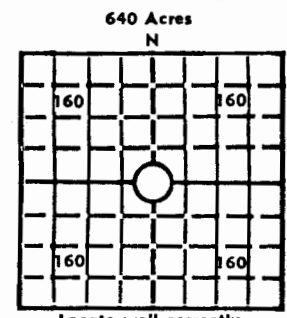

Well No. 2-31 Lease Name Dwyer

Footage Location
feet from (N) (S) line feet from (E) (W) line

Principal Contractor B & N Drilling Company Geologist Charlie Sturdavant

Spud Date 8/2/77 Total Depth 775' P.B.T.D.

Date Completed 8/3/77 Oil Purchaser

Elev.: Gr. _____
DF _____ KB _____

CASING RECORD

Report of all strings set — surface, intermediate, production, etc.

Purpose of string	Size hole drilled	Size casing set (in O.D.)	Weight lbs/ft.	Setting depth	Type cement	Sacks	Type and percent additives
Surface	8 3/4"	7"		20'			
Production	5 1/4"	2 1/2"		769'	Regular	60	
Gamma Ray/ Neutron/ Perforate log attached herewith							

LINER RECORD

PERFORATION RECORD

Top, ft.	Bottom, ft.	Sacks cement	Shots per ft.	Size & type	Depth interval
TUBING RECORD			1	12 gram	640-649'
Size	Setting depth	Packer set at			

ACID, FRACTURE, SHOT, CEMENT SQUEEZE RECORD

Amount and kind of material used	Depth interval treated

INITIAL PRODUCTION

Date of first production <u>No commercial production - probably recomplete</u>	Producing method (flowing, pumping, gas lift, etc.)
RATE OF PRODUCTION PER 24 HOURS	Oil Gas Water Gas-oil ratio
bbls. MCF bbls. CFPB	
Disposition of gas (vented, used on lease or sold)	Producing interval (s)

INSTRUCTIONS: As provided in KCC Rule 82-2-125, within 90 days after completion of a well, one completed copy of this Drillers Log shall be transmitted to the State Geological Survey of Kansas, 4150 Monroe Street, Wichita, Kansas 67209. Copies of this form are available from the Conservation Division, State Corporation Commission, 3830 So. Meridian (P.O. Box 17027), Wichita, Kansas 66217. Phone AC 316-522-2206. If confidential custody is desired, please note Rule 82-2-125. Drillers Logs will be on an open file in the Oil and Gas Division, State Geological Survey of Kansas, Lawrence, Kansas

DESIGNATE TYPE OF COMP.: OIL, GAS,
 DRY HOLE, SWDW, ETC.:

21-16-7E

Benson Mineral Group, Inc.

Well No.

Lease Name

2-31

Dwyer

S 31 T 16 R 7 E
 *X

WELL LOG

Show all important zones of porosity and contents thereof; cored intervals, and all drill-stem tests, including depth interval tested, cushion used, time tool open, flowing and shut-in pressures, and recoveries.

SHOW GEOLOGICAL MARKERS, LOGS RUN,
 OR OTHER DESCRIPTIVE INFORMATION.

FORMATION DESCRIPTION, CONTENTS, ETC.	TOP	BOTTOM	NAME	DEPTH
soil	0	4		
shale	4	12		
lime	12	25		
shale	25	57		
lime	57	80		
shale	80	105		
lime	105	119		
shale	119	123		
lime	123	137		
lime/shale	137	149		
sand/shale	149	161		
lime	161	216		
lime/shale	216	583		
shale	583	640		
lime	640	647		
shale	647	700		
lime	700	705		
shale	705	745		
lime	745	754		
shale	754	762		
lime	762	765		
shale	765	775		

USE ADDITIONAL SHEETS, IF NECESSARY, TO COMPLETE WELL RECORD.

Date Received

Courtney E Cook
 Signature

Production Manager

Title

9/19/77

Date