

14-18-22E
 State Geological Survey
 S. 14 WICHITA BRANCH
 150' E of W boundary &
 Loc. 200' S of Pottawatomie
 creek
 County Miami

**WELL COMPLETION REPORT AND
 DRILLER'S LOG**

API No. 15 — Miami County — 121-21,783 Number

Operator TANL Corporation

Address Box 302, Osawatomie, KS 66064

Well No. TANL #14 Lease Name Robinson

Footage Location
200 feet from (N) ST line 150 feet from (E) W line

Principal Contractor Blue Valley Drilling Geologist _____

Spud Date 6-19-80 Date Completed 06-30-80 Total Depth 300' P.B.T.D. _____

Directional Deviation _____ Oil and/or Gas Purchaser _____

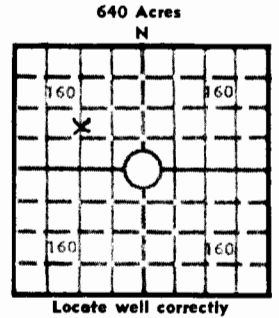

Elev.: Gr. _____
 DF _____ KB _____

CASING RECORD

Report of all strings set — surface, intermediate, production, etc.

| Purpose of string | Size hole drilled | Size casing set (in O.D.) | Weight lbs/ft. | Setting depth | Type cement | Sacks | Type and percent additives |
|-------------------|-------------------|---------------------------|----------------|---------------|-------------|-------|----------------------------|
| Surface | 8" | 6" | | 21' | | | |
| | | | | | | | |
| | | | | | | | |
| | | | | | | | |

LINER RECORD

PERFORATION RECORD

| Top, ft. | Bottom, ft. | Sacks cement | Shots per ft. | Size & type | Depth interval |
|----------|-------------|--------------|---------------|-------------|----------------|
| | | | | | |
| | | | | | |

| TUBING RECORD | | |
|---------------|---------------|---------------|
| Size | Setting depth | Packer set at |
| 2" | 300' | |

ACID, FRACTURE, SHOT, CEMENT SQUEEZE RECORD

| Amount and kind of material used | Depth interval treated |
|----------------------------------|------------------------|
| | |
| | |
| | |

INITIAL PRODUCTION

Date of first production _____ Producing method (flowing, pumping, gas lift, etc.) _____

| RATE OF PRODUCTION PER 24 HOURS | Oil | Gas | Water | Gas-oil ratio |
|--|-------|-----|------------------------|---------------|
| | bbls. | MCF | bbls. | CFPB |
| Disposition of gas (vented, used on lease or sold) | | | Producing interval (s) | |

INSTRUCTIONS: As provided in KCC Rule 82-2-125, within 90 days after completion of a well, one completed copy of this Drillers Log shall be transmitted to the State Geological Survey of Kansas, 4150 Monroe Street, Wichita, Kansas 67209. Copies of this form are available from the Conservation Division, State Corporation Commission, 245 No. Water, Wichita, Kansas 67202. Phone AC 316-522-2206. If confidential custody is desired, please note Rule 82-2-125. Drillers Logs will be on open file in the Oil and Gas Division, State Geological Survey of Kansas, Lawrence, Kansas 66044.

Operator TANL Corporation

DESIGNATE TYPE OF COMP.: OIL, GAS, DRY HOLE, SWDW, ETC.:

| | | |
|--|------------------------|-----|
| Well No. TANL #14 | Lease Name Robinson | Oil |
| S 14 T 18 R 22 ^E / _W | | |

WELL LOG

Show all important zones of porosity and contents thereof; cored intervals, and all drill-stem tests, including depth interval tested, cushion used, time tool open, flowing and shut-in pressures, and recoveries.

SHOW GEOLOGICAL MARKERS, LOGS RUN, OR OTHER DESCRIPTIVE INFORMATION.

| FORMATION DESCRIPTION, CONTENTS, ETC. | TOP | BOTTOM | NAME | DEPTH |
|---------------------------------------|-------------------|-------------------|------|-------|
| Top soil | 0 | 4 | | |
| Brown & tan shale | 4 | 25 | | |
| Lime | 25 | 26 | | |
| Shale | 26 | 27 | | |
| Lime & shale layers | 27 | 28 | | |
| Shale | 28 | 30 | | |
| Lime | 30 | 34 | | |
| Shale | 34 | 46 | | |
| Lime | 46 | 48 | | |
| Shale | 48 | 51 | | |
| Lime | 51 | 58 | | |
| Shale | 58 | 58 | | |
| Lime | 58 | 75 | | |
| Shale | 75 | 78 | | |
| Bk. slate | 78 | 80 | | |
| Shale | 80 | 83 | | |
| Lime | 83 | 104 | | |
| Shale | 104 | 105 | | |
| Slate | 105 | 107 | | |
| Lime | 107 | 110 | | |
| Shale | 110 | 111 | | |
| Lime | 111 | 112 | | |
| Shale | 112 | 115 | | |
| Lime | 115 | 122 | | |
| Shale | 122 | 127 $\frac{1}{2}$ | | |
| Lime | 127 $\frac{1}{2}$ | 129 | | |
| Shale | 129 | 264 $\frac{1}{2}$ | | |
| Broken oil sand | 264 $\frac{1}{2}$ | 266 | | |
| Shale | 266 | 268 | | |
| Broken oil sand | 268 | 272 | | |
| Lime | 272 | 273 | | |
| Broken sand | 273 | 275 | | |
| Black oil sand | 275 | 286 | | |
| Shale | 286 | 291 | | |
| Lime | 291 | 298 | | |
| Shale | 298 | 299 | | |
| Lime | 299 | 308 | | |
| Shale | 308 | 322 | | |

USE ADDITIONAL SHEETS, IF NECESSARY, TO COMPLETE WELL RECORD.

| | |
|---------------|--|
| Date Received |  |
| | Signature |
| | Owner, Blue Valley Drilling |
| | Title |
| | November 24, 1980 |
| | Date |

100-1000