

KANSAS

**WELL COMPLETION REPORT AND DRILLER'S LOG**

ST 26 T. 18 S. R. 26 E. S. 26 E.

WICHITA BRANCH  
 Loc. NW 1/4 of SW 1/4  
 100' SNL 550' EWL  
 County Miami

API No. 15 — Miami — 15-121-22,365  
 County Number

Operator  
Gerald Strader

Address  
Blue Rapids, Kansas 66411

Well No. 7 Lease Name Iowa College

Footage Location NW 1/4 of SW 1/4 100' SNL 550' EWL  
 feet from (N) (S) line feet from (E) (W) line

Principal Contractor Blue Valley Drilling Geologist

Spud Date 12-05-80 Date Completed 12-07-80 Total Depth 374' P.B.T.D.

Directional Deviation Oil and/or Gas Purchaser

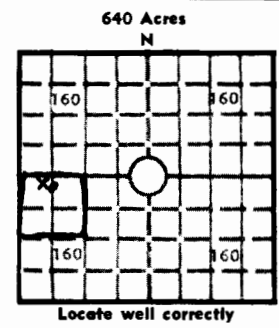

Locate well correctly  
 Elev.: Gr. \_\_\_\_\_  
 DF \_\_\_\_\_ KB \_\_\_\_\_

**CASING RECORD**

Report of all strings set — surface, intermediate, production, etc.

Purpose of string	Size hole drilled	Size casing set (in O.D.)	Weight lbs/ft.	Setting depth	Type cement	Sacks	Type and percent additives
Surface	5/8" 6"	6"		21'			

**LINER RECORD**

**PERFORATION RECORD**

Top, ft.	Bottom, ft.	Sacks cement	Shots per ft.	Size & type	Depth interval

**TUBING RECORD**

Size	Setting depth	Packer set at
2"	347'	

**ACID, FRACTURE, SHOT, CEMENT SQUEEZE RECORD**

Amount and kind of material used	Depth interval treated

**INITIAL PRODUCTION**

Date of first production	Producing method (flowing, pumping, gas lift, etc.)				
<b>RATE OF PRODUCTION PER 24 HOURS</b>	Oil	Gas	Water	Gas-oil ratio	
	bbls.	MCF	bbls.	CFPB	
Disposition of gas (vented, used on lease or sold)			Producing interval(s)		

INSTRUCTIONS: As provided in KCC Rule 82-2-125, within 90 days after completion of a well, one completed copy of this Drillers Log shall be transmitted to the State Geological Survey of Kansas, 4150 Monroe Street, Wichita, Kansas 67209. Copies of this form are available from the Conservation Division, State Corporation Commission, 245 No. Water, Wichita, Kansas 67202. Phone AC 316-522-2206. If confidential custody is desired, please note Rule 82-2-125. Drillers Logs will be on open file in the Oil and Gas Division, State Geological Survey of Kansas, Lawrence, Kansas 66044.

Operator **Gerald Strader** DESIGNATE TYPE OF COMP.: OIL, GAS, DRY HOLE, SWDW, ETC.:  
 Well No. **7** Lease Name **Iowa College** Oil  
 S 26 T 18 R 22 E  
~~22K~~

**WELL LOG**

Show all important zones of porosity and contents thereof; cored intervals, and all drill-stem tests, including depth interval tested, cushion used, time tool open, flowing and shut-in pressures, and recoveries.

SHOW GEOLOGICAL MARKERS, LOGS RUN, OR OTHER DESCRIPTIVE INFORMATION.

FORMATION DESCRIPTION, CONTENTS, ETC.	TOP	BOTTOM	NAME	DEPTH
Top soil	0	2		
Brown & tan clay	2	8		
Lime	8	12		
Shale	12	13		
Lime	13	38		
shale	38	53		
Lime	53	59		
Shale	59	104		
Lime	104	106		
Shale	106	107		
Lime	107	108		
Shale	108	109		
Lime	109	114		
Shale	114	124		
Lime	124	156		
Shale	156	158		
Slate	158	160		
Shale	160	162		
Lime	162	184		
Shale	184	186		
Slate	186	188		
Lime	188	190		
Shale	190	191		
Lime	191	191 $\frac{1}{2}$		
Shale	191 $\frac{1}{2}$	192 $\frac{1}{2}$		
Lime	192 $\frac{1}{2}$	193		
Shale	193	196		
Lime	196	200		
Shale	200	204		
Lime	204	207		
Shale	207	309		
Broken oil sand	309	315		
Shale	315	331		
Slate	331	340 $\frac{1}{2}$		
Shale	340 $\frac{1}{2}$	343 $\frac{1}{2}$		
Dry oil sand	343 $\frac{1}{2}$	344		
Lime	344	345		
Oil sand	344	345		
Cored to 372	345			

USE ADDITIONAL SHEETS, IF NECESSARY, TO COMPLETE WELL RECORD.

Date Received \_\_\_\_\_  
 Signature Gerald Strader  
 Owner - Gerald Strader  
 Title \_\_\_\_\_  
 Date December 30, 1980  
 Date \_\_\_\_\_

292832