

KANSAS

WELL COMPLETION REPORT AND DRILLER'S LOG

State Geological Survey WICHITA BRANCH

SEP 26 18 22 East 1/2 of the SW 1/4 100 NSL 160 EWL

API No. 15 - Miami - 121-22,769 County Number

Operator Sharp Oil Co. & Gerald Strader

Address Blue Rapids, KS. 66411

Well No. 1 Lease Name Banks

Footage Location 100 NSL feet from (N) (S) line 160 EWL feet from (E) (W) line

Principal Contractor Blue Valley Drilling Geologist

Spud Date 09-20-81 Date Completed 09-24-81 Total Depth 371' P.B.T.D.

Directional Deviation Oil and/or Gas Purchaser

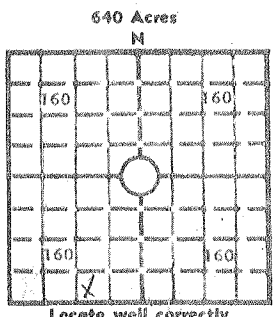

Elev.: Gr. DF KB

CASING RECORD

Report of all strings set - surface, intermediate, production, etc.

Table with 8 columns: Purpose of string, Size hole drilled, Size casing set (in O.D.), Weight lbs/ft., Setting depth, Type cement, Sacks, Type and percent additives. Row 1: Surface, 6 1/2", 6 1/2", 21'

LINER RECORD

PERFORATION RECORD

Table with 6 columns: Top, ft., Bottom, ft., Sacks cement, Shots per ft., Size & type, Depth interval. Row 1: 2 1/2", 356', Packer set at

TUBING RECORD

ACID, FRACTURE, SHOT, CEMENT SQUEEZE RECORD

Table with 2 columns: Amount and kind of material used, Depth interval treated

INITIAL PRODUCTION

Table with 4 columns: Date of first production, Producing method (flowing, pumping, gas lift, etc.), RATE OF PRODUCTION PER 24 HOURS (Oil, Gas, Water), Gas-oil ratio, Disposition of gas (vented, used on lease or sold), Producing interval (s)

INSTRUCTIONS: As provided in KCC Rule 82-2-125, within 90 days after completion of a well, one completed copy of this Drillers Log shall be transmitted to the State Geological Survey of Kansas, 4150 Monroe Street, Wichita, Kansas 67209. Copies of this form are available from the Conservation Division, State Corporation Commission, 245 No. Water, Wichita, Kansas 67202. Phone AC 316-522-2206. If confidential custody is desired, please note Rule 82-2-125. Drillers Logs will be on open file in the Oil and Gas Division, State Geological Survey of Kansas, Lawrence, Kansas 66044.

DESIGNATE TYPE OF COMP.: OIL, GAS, DRY HOLE, SWDW, ETC.:

Operator

Well No.

Lease Name

S 21^E T 18 R 22^W

WELL LOG

Show all important zones of porosity and contents thereof; cored intervals, and all drill-stem tests, including depth interval tested, cushion used, time tool open, flowing and shut-in pressures, and recoveries.

SHOW GEOLOGICAL MARKERS, LOGS RUN, OR OTHER DESCRIPTIVE INFORMATION.

| FORMATION DESCRIPTION, CONTENTS, ETC. | TOP | BOTTOM | NAME | DEPTH |
|---------------------------------------|-----|--------|------|-------|
| Top soil | 0 | 3 | | |
| Yellow clay | 3 | 8 | | |
| Lime | 8 | 21 | | |
| Gray shale | 21 | 44 | | |
| Green shale | 44 | 51 | | |
| Lime | 51 | 55 | | |
| Gray shale | 55 | 60 | | |
| Green shale | 60 | 81 | | |
| Shale | 81 | 102 | | |
| Lime | 102 | 110 | | |
| Shale | 110 | 123 | | |
| Lime | 123 | 137 | | |
| Shale | 137 | 140 | | |
| Lime | 140 | 151 | | |
| Shale | 151 | 152 | | |
| Lime | 152 | 153 | | |
| Coal | 153 | 159 | | |
| Lime | 159 | 179 | | |
| Coal | 179 | 183 | | |
| Lime | 183 | 186 | | |
| Shale | 186 | 192 | | |
| Lime | 192 | 195 | | |
| Shale | 195 | 199 | | |
| Lime | 199 | 200 | | |
| Green Shale | 200 | 210 | | |
| Gray shale | 210 | 216 | | |
| Gray sand | 216 | 221 | | |
| Green sand | 221 | 231 | | |
| Sandy gray shale | 231 | 243 | | |
| Shale | 243 | 302 | | |
| Black shale | 302 | 307 | | |
| White shale | 307 | 309 | | |
| Green shale | 309 | 310 | | |
| Oil sand | 310 | 320 | | |
| Green shale | 320 | 324 | | |
| Gray shale | 324 | 338 | | |
| Black shale | 335 | 338 | | |
| White shale | 338 | 343 | | |
| green shale | 343 | 356 | | |

Cont'd

USE ADDITIONAL SHEETS, IF NECESSARY, TO COMPLETE WELL RECORD.

Date Received

Signature

Title

Date

26-18-275

SEP

DESIGNATE TYPE OF COMP.: OIL, GAS, DRY HOLE, SWDW, ETC.:

Oil

Operator Sharp Oil Co. & Gerald Strader

Well No. 1 Lease Name Banks

P1

S 26 T 18 R 22 E W

WELL LOG

SHOW GEOLOGICAL MARKERS, LOGS RUN, OR OTHER DESCRIPTIVE INFORMATION.

Show all important zones of porosity and contents thereof; cored intervals, and all drill-stem tests, including depth interval tested, cushion used, time tool open, flowing and shut-in pressures, and recoveries.

| FORMATION DESCRIPTION, CONTENTS, ETC. | TOP | BOTTOM | NAME | DEPTH |
|---------------------------------------|---------|---------|------|-------|
| Page " 2 " | | | | |
| Lime | 356 | 357 | | |
| Sandy lime | 357 | 357 1/2 | | |
| Good oil sand | 357 1/2 | 360 | | |
| Broken oil sand | 360 | 363 | | |
| Lime | 363 | 371 | | |

USE ADDITIONAL SHEETS, IF NECESSARY, TO COMPLETE WELL RECORD.

Date Received

Gerald Strader
Signature

Gerald Strader - owner
Title

11-02-81
Date

Date