

KANSAS

WELL COMPLETION REPORT AND DRILLER'S LOG

*State Geological Survey
WICHITA BRANCH*

20 T. 18 R. 24 E
W

API No. 15 — 121 — 21,167
County Number

Loc. C SW NE

Operator
W. D. Oil Co.

County Miami

Address
127 West 10th, #430 Kansas City, Mo. 64105

Well No. #1 Lease Name
Joe Koopman

Footage Location
feet from (N) (S) line feet from (E) (W) line

Principal Contractor Geologist
Jayhawk Drilling Co. Leigh Raymond

Spud Date Date Completed Total Depth P.B.T.D.
12-79 3-31-80 482'

Directional Deviation Oil and/or Gas Purchaser
Koch La Jet, Inc.

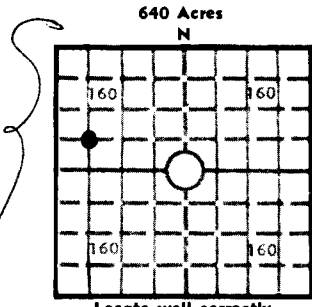

Elev.: Gr. _____
BF _____ KB _____

CASING RECORD

Report of all strings set — surface, intermediate, production, etc.

Purpose of string	Size hole drilled	Size casing set (in O.D.)	Weight lbs/ft.	Setting depth	Type cement	Sacks	Type and percent additives
oil	57/8th	4½		482'	30sx		

LINER RECORD

PERFORATION RECORD

Top, ft.	Bottom, ft.	Sacks cement	Shots per ft.	Size & type	Depth interval

TUBING RECORD

Size	Setting depth	Packer set at

ACID, FRACTURE, SHOT, CEMENT SQUEEZE RECORD

Amount and kind of material used	Depth interval treated

INITIAL PRODUCTION

Date of first production april 1980	Producing method (flowing, pumping, gas lift, etc.) pumping
RATE OF PRODUCTION PER 24 HOURS Oil 2½ bbls. MCF 2½ bbls. Gas-oil ratio CFPB	Disposition of gas (vented, used on lease or sold) Producing interval(s) Squirrel sand

INSTRUCTIONS: As provided in KCC Rule 82-2-125, within 90 days after completion of a well, one completed copy of this Drillers Log shall be transmitted to the State Geological Survey of Kansas, 4150 Monroe Street, Wichita, Kansas 67209. Copies of this form are available from the Conservation Division, State Corporation Commission, 245 No. Water, Wichita, Kansas 67202. Phone AC 316-522-2206. If confidential custody is desired, please note Rule 82-2-125. Drillers Logs will be on open file in the Oil and Gas Division, State Geological Survey of Kansas, Lawrence, Kansas 66044.

Operator

DESIGNATE TYPE OF COMP.: OIL, GAS,
DRY HOLE, SWDW, ETC.:

WD Oil Co., Inc.

Well No.

Lease Name

1

Joe Koopman

OIL

S 20 T18 R 24 ^E_{NE}

NE SW

WELL LOG

Show all important zones of porosity and contents thereof; cored intervals, and all drill-stem tests, including depth interval tested, cushion used, time tool open, flowing and shut-in pressures, and recoveries.

SHOW GEOLOGICAL MARKERS, LOGS RUN,
OR OTHER DESCRIPTIVE INFORMATION.

FORMATION DESCRIPTION, CONTENTS, ETC.	TOP	BOTTOM	NAME	DEPTH
soil		3		
clay		14		
lime		51		
sh dk		56		
lime		77		
sh dk		82		
lime hd		94		
sh lt sdy, lt wt		104		
sh		133		
sh sdy, sh of oil		139		
sh		245		
red bed		250		
lime sdy		273		
sh gray		293		
lime		303		
sh		311		
lime		313		
sh blk		316		
sh dk gray		319		
sh white		328		
sh gray		334		
lime sdy, lt. gas		345		
sh blk, more gas		351		
sh dk		358		
sd, show of oil		364		
lime		376		
sh		378		
lime		385		
sh light		455		
sh dk		468		
sd, show of oil		474		
sh dk		482	T.D.	

USE ADDITIONAL SHEETS, IF NECESSARY, TO COMPLETE WELL RECORD.

Date Received

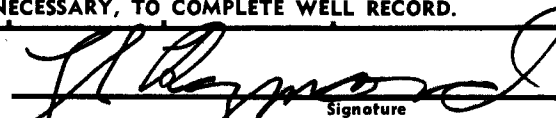

Signature

Leigh Raymond-Geologic Consultant

Title

June 5, 1980

Date