

STATE CORPORATION COMMISSION OF KANSAS  
OIL & GAS CONSERVATION DIVISION  
WELL COMPLETION OR RECOMPLETION FORM  
ACO-1 WELL HISTORY  
DESCRIPTION OF WELL AND LEASE

Operator: License # 7524  
Name Ludovic L. Christopher, Jr.  
Address P.O. Box 71  
Rantoul, Kansas  
City/State/Zip Kansas 66079

Purchaser Enren and Eureka Couds

Operator Contact Person Ludovic L. Christopher Jr.  
Phone 816-942-8646

Contractor: License # 5666  
Name Fiach Drilling, Inc.

Wellsite Geologist None  
Phone

Designate Type of Completion

New Well     Re-Entry     Workover  
 Oil     SWD     Temp Abd  
 Gas     Inj     Delayed Comp.  
 Dry     Other (Core, Water Supply etc.)

If **OWNO**: old well info as follows:

Operator  
Well Name  
Comp. Date

WELL HISTORY

Drilling Method:  
 Mud Rotary     Air Rotary     Cable  
6-18-85    6-22-85    9-14-87  
Spud Date    Date Reached TD    Completion Date

641'    628'  
Total Depth    PBTD

Amount of Surface Pipe Set and Cemented at 21 feet  
Multiple Stage Cementing Collar Used?  Yes  No  
If yes, show depth set.....feet

If alternate 2 completion, cement circulated from 628 feet depth to Surface 65 SX cmt  
Cement Company Name Consolidated Oil Well  
Invoice # 26542

SIDE ONE

API NO. 15-059-23574  
County Franklin

W. NW NW Sec. 4 Twp. 18 Rge. 21

4815' Ft North from Southeast Corner of Section  
5115' Ft West from Southeast Corner of Section  
(Note: Locate well in section plat below)

Lease Name Oram Lease Well # 11

Field Name Paola - Rantoul

Producing Formation 1st Squirrel

Elevation: Ground 970' KB

Section Plat

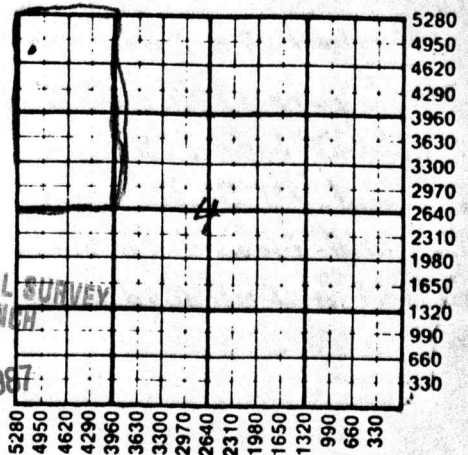

WATER SUPPLY INFORMATION

Disposition of Produced Water: Hauled Disposal 1  
Docket # ..... Repressuring

Questions on this portion of the ACO-1 call:

Water Resources Board (913) 296-3717

Source of Water: None  
Division of Water Resources Permit #.....

Groundwater.....Ft North from Southeast Corner  
(Well) .....Ft West from Southeast Corner of  
Sec Twp Rge East West

Surface Water.....Ft North from Southeast Corner  
(Stream, pond etc).....Ft West from Southeast Corner  
Sec Twp Rge East West

Other (explain).....  
(purchased from city, R.W.D. #)

INSTRUCTIONS: This form shall be completed in triplicate and filed with the Kansas Corporation Commission, 200 Colorado Derby Building, Wichita, Kansas 67202, within 120 days of the spud date of any well. Rule 82-3-130, 82-3-107 and 82-3-106 apply.

Information on side two of this form will be held confidential for a period of 12 months if requested in writing and submitted with the form. See rule 82-3-107 for confidentiality in excess of 12 months. One copy of all wireline logs and drillers time log shall be attached with this form. Submit CP-4 form with all plugged wells. Submit CR-111 form with all temporarily abandoned wells.

4-18-21E

Operator Name Ludovic L. Christopher, Jr. Lease Name Green Lease Well # 11

Sec. 4 Twp. 18 Rge. 21  East  West County Franklin

Estimated Production Per 24 Hours	Oil	Gas	Water	Gas-Oil Ratio	Gravity
	3 Bbls	MCF	3 Bbls	10 PSI	27°

METHOD OF COMPLETION

Disposition of gas:  Vented  Open Hole  Perforation  
 Sold  Other (Specify) \_\_\_\_\_  
 Used on Lease

Samples Sent to Geological Survey  Yes  No  
 Cores Taken  Yes  No

Formation Description

Log  Sample

Name	Top	Bottom
1st Squirrel Sand	598'	609'

Drilled to Font Scott Line.  
 1st Squirrel about 6' below base of  
 Ft Scott Line, (598')  
 Cored 1st Sq. (15') only.  
 No fluid flowed to surface but a trace  
 of oil in Drill Mud.  
 TD, 641'

CASING RECORD  New  Used

Report all strings set-conductor, surface, intermediate, production, etc.

Purpose of String	Size Hole Drilled	Size Casing Set (in O.D.)	Weight Lbs/Ft.	Setting Depth	Type of Cement	#Sacks Used	Type and Percent Additives
Surface Casing	8"	6 1/2"		21'	Portland	2	
Well Casing	5 1/2"	2 1/4"		628'	Pack	65	2% Gel
Pumping String		1"		601'			

PERFORATION RECORD

Acid, Fracture, Shot, Cement Squeeze Record

Shots Per Foot	Specify Footage of Each Interval Perforated	(Amount and Kind of Material Used)	Depth
2	2 shots 595' to 600'	Sat. Acid then Fractured	
12	12 shots 601' to 607'	100 lbs. of Gelled Water	
		2 1/2" Pipe Cemented top	
		to Bottom T.D. = 628'	628'

TUBING RECORD Size 2 1/2" ID Set At 628 Packer at Cemented AH2 Liner Run  Yes  No

Date of First Production 9-14-87 Producing Method  Flowing  Pumping  Gas Lift  Other (explain) \_\_\_\_\_

COPY

SIDE ONE

STATE CORPORATION COMMISSION OF KANSAS  
OIL & GAS CONSERVATION DIVISION  
WELL COMPLETION FORM  
ACO-1 WELL HISTORY  
DESCRIPTION OF WELL AND LEASE

Operator: License # 7524  
Name: Ludovic L. Christopher Jr  
Address P.O. Box 71  
Rantoul, Kansas, 66079  
City/State/Zip \_\_\_\_\_  
Purchaser: Coude Marketing  
Operator Contact Person: Same  
Phone (816) 942-8646  
Contractor: Name: Finch Drilling  
License: 5666  
Wellsite Geologist: No

Designate Type of Completion  
 New Well  Re-Entry  Workover  
 Oil  SWD  Temp. Abd.  
 Gas  Inj  Delayed Comp.  
 Dry  Other (Core, Water Supply, etc.)

If **OWO**: old well info as follows:  
Operator: \_\_\_\_\_  
Well Name: \_\_\_\_\_  
Comp. Date \_\_\_\_\_ Old Total Depth \_\_\_\_\_

Drilling Method:  
 Mud Rotary  Air Rotary  Cable  
6-18-84 6-22-84 9-14-87  
Spud Date Date Reached TD Completion Date

API NO. 15- 059-23574  
County Franklin  
NW NW NW Sec. 4 Twp. 18 Rge. 21  East  West  
4815 Ft. North from Southeast Corner of Section  
5115 Ft. West from Southeast Corner of Section  
(NOTE: Locate well in section plat below.)  
Lease Name Oram Well # 11  
Field Name Paolo-Rantoul  
Producing Formation First Spacial  
Elevation: Ground 950' KB \_\_\_\_\_  
Total Depth 627.9 PBTD \_\_\_\_\_

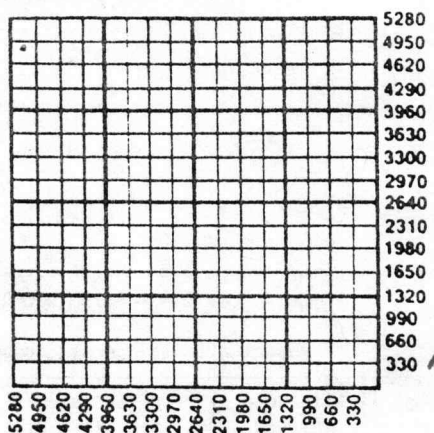

Amount of Surface Pipe Set and Cemented at 21 Feet  
Multiple Stage Cementing Collar Used? Yes  No  
If yes, show depth set \_\_\_\_\_ Feet  
If Alternate II completion, cement circulated from 628  
feet depth to 0 w/ 72 sx cmt.

**INSTRUCTIONS:** This form shall be completed in triplicate and filed with the Kansas Corporation Commission, 200 Colorado Derby Building, Wichita, Kansas 67202, within 120 days of the spud date of any well. Rule 82-3-130, 82-3-107 and 82-3-106 apply. Information on side two of this form will be held confidential for a period of 12 months if requested in writing and submitted with the form. See rule 82-3-107 for confidentiality in excess of 12 months. One copy of all wireline logs and drillers time log shall be attached with this form. ALL CEMENTING TICKETS MUST BE ATTACHED. Submit CP-4 form with all plugged wells. Submit CP-111 form with all temporarily abandoned wells. Any recompletion, workover or conversion of a well requires filing of ACO-2 within 120 days from commencement date of such work.

All requirements of the statutes, rules and regulations promulgated to regulate the oil and gas industry have been fully complied with and the statements herein are complete and correct to the best of my knowledge.

Signature Ludovic L. Christopher Jr  
Title Owner Date 8-23-90  
Subscribed and sworn to before me this \_\_\_\_\_ day of \_\_\_\_\_  
19\_\_\_\_\_.  
Notary Public \_\_\_\_\_  
Date Commission Expires \_\_\_\_\_

RECEIVED  
STATE CORPORATION COMMISSION  
AUG 27 1990  
CONSERVATION DIVISION  
Wichita, Kansas

K.C.C. OFFICE USE ONLY  
F  Letter of Confidentiality Attached  
C  Wireline Log Received  
C  Drillers Timelog Received  
Distribution  
 KCC  SWD/Rep  NGPA  
 KGS  Plug  Other  
(Specify)

SIDE TWO

Operator Name Ludovic, Christopher Jr Lease Name Oram Well # 11  
 Sec. 4 Twp. 18 Rge. 21  East  West  
 County Franklin

INSTRUCTIONS: Show important tops and base of formations penetrated. Detail all cores. Report all drill stem tests giving interval tested, time tool open and closed, flowing and shut-in pressures, whether shut-in pressure reached static level, hydrostatic pressures, bottom hole temperature, fluid recovery, and flow rates if gas to surface during test. Attach extra sheet if more space is needed. Attach copy of log.

Drill Stem Tests Taken (Attach Additional Sheets.)	<input type="checkbox"/> Yes <input checked="" type="checkbox"/> No	<p style="text-align: center;"><b>Formation Description</b></p> <input type="checkbox"/> Log <input type="checkbox"/> Sample Name                      Top                      Bottom <u>First Squarrel</u> <u>598' to 608'</u>
Samples Sent to Geological Survey	<input type="checkbox"/> Yes <input checked="" type="checkbox"/> No	
Cores Taken	<input checked="" type="checkbox"/> Yes <input type="checkbox"/> No	
Electric Log Run (Submit Copy.)	<input checked="" type="checkbox"/> Yes <input type="checkbox"/> No	

CASING RECORD <input type="checkbox"/> New <input type="checkbox"/> Used							
Report all strings set-conductor, surface, intermediate, production, etc.							
Purpose of String	Size Hole Drilled	Size Casing Set (In O.D.)	Weight Lbs./Ft.	Setting Depth	Type of Cement	# Sacks Used	Type and Percent Additives
<u>Surface Casing</u>	<u>8"</u>	<u>6 1/4"</u>		<u>21'</u>		<u>2</u>	<u>none</u>
<u>Casing</u>	<u>5 1/2"</u>	<u>2 3/4"</u>		<u>628'</u>		<u>72</u>	<u>Perm Gel</u>
PERFORATION RECORD				Acid, Fracture, Shot, Cement Squeeze Record			
Shots Per Foot	Specify Footage of Each Interval Perforated			(Amount and Kind of Material Used)		Depth	
<u>1 to 2</u>	<u>10 shot in 8 ft.</u>			<u>Spot 50 gal Acid</u>		<u>628'</u>	
				<u>Fractured with 90 B/s</u>			
				<u>Gel Water</u>			
TUBING RECORD				Liner Run <input type="checkbox"/> Yes <input type="checkbox"/> No			
<u>Pumping String 1"</u>	Size	Set At	Packer At				
		<u>600'</u>					
Date of First Production	Producing Method <input type="checkbox"/> Flowing <input checked="" type="checkbox"/> Pumping <input type="checkbox"/> Gas Lift <input type="checkbox"/> Other (Explain)						
<u>9-14-87</u>							
Estimated Production Per 24 Hours	Oil Bbls.	Gas Mcf	Water Bbls.	Gas-Oil Ratio		Gravity	
	<u>2 1/2</u>					<u>26.5</u>	

Disposition of Gas:  Vented  Sold  Used on Lease (If vented, submit ACO-18.)

METHOD OF COMPLETION:  Open Hole  Perforation  Dually Completed  Commingled  Other (Specify) \_\_\_\_\_

Production Interval: Top 600'  
Bottom 610'