

KANSAS

State Geological Survey

WELL COMPLETION REPORT AND DRILLER'S LOG

S. 9 T. 19 S. R. 5 E

Loc. G/SW-SW

County Marion

API No. 15 - 115 - 20716
County Number

Operator DAMSON OIL CORPORATION

Address Box 4391, Houston, Texas 77210

Well No. 2 Lease Name Melvin Jewett

Footage Location 660 feet from (N) (S) line 660 feet from (E) (W) line

Principal Contractor Inland Drilling Co. Geologist

Spud Date 30-81 Date Completed 2-4-81 Total Depth 2325 P.B.T.D. 2288

Directional Deviation Oil and/or Gas Purchaser Cities Service

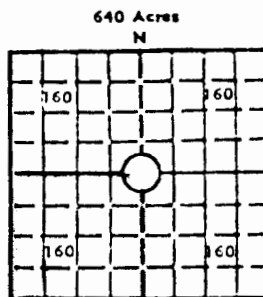

Locate well correctly

Elev.: Gr. 1493

DF KB 1498

CASING RECORD

Report of all strings set—surface, intermediate, production, etc.

Purpose of string	Size hole drilled	Size casing set (in O.D.)	Weight lbs/ft.	Setting depth	Type cement	Sacks	Type and percent additives
Production	6 1/4	4 1/2	9.50#	2325	50:50 POZ	150	10% Salt

LINER RECORD

PERFORATION RECORD

Top, ft.	Bottom, ft.	Sacks cement	Shots per ft.	Size & type	Depth interval
			One		2224-2268

TUBING RECORD

Size	Setting depth	Packer set at
2-3/8	2208	--

ACID, FRACTURE, SHOT, CEMENT SQUEEZE RECORD

Amount and kind of material used	Depth interval treated
10 Barrels gelled 3% HCL	2224-2268

INITIAL PRODUCTION

Date of first production	Producing method (flowing, pumping, gas lift, etc.)
	Flowing
RATE OF PRODUCTION PER 24 HOURS	Oil 0 bbls. Gas 36 MCF Water 0 bbls. Gas-oil ratio - CFPB
Disposition of gas (vented, used on lease or sold)	Producing interval (s)
VENTED - WILL POTENTIAL AFTER HOOK-UP	2224-2268

INSTRUCTIONS: As provided in KCC Rule 82-2-125, within 90 days after completion of a well, one completed copy of this Drillers Log shall be transmitted to the State Geological Survey of Kansas, 4150 Monroe Street, Wichita, Kansas 67209. Copies of this form are available from the Conservation Commission, State Corporation Commission, 245 No. Water, Wichita, Kansas 67202. Phone AC 316-522-2206. If confidential custody is desired, please note...

Operator
 DAMSON OIL CORPORATION

DESIGNATE TYPE OF COMP.: OIL, GAS,
 DRY HOLE, SWDW, ETC.:

Well No. 2 Lease Name MELVIN JEWETT

GAS

S 9 T 19SR 5 ^(E) W

WELL LOG

Show all important zones of porosity and contents thereof; cased intervals, and all drill-stem tests, including depth interval tested, cushion used, time tool open, flowing and shut-in pressures, and recoveries.

SHOW GEOLOGICAL MARKERS, LOGS RUN,
 OR OTHER DESCRIPTIVE INFORMATION.

FORMATION DESCRIPTION, CONTENTS, ETC.	TOP	BOTTOM	NAME	DEPTH
SHALE	1750	2100		
LIME	2100	2195		
LIME AND SHALE	2195	2224		
MISS. CHAT	2224	2325		
			Miss. Chat	2224-2325
			Ran CN & CD	
			Log	

USE ADDITIONAL SHEETS, IF NECESSARY, TO COMPLETE WELL RECORD.

Date Received

A. R. Lemming Jr.
 Signature

Staff Engineer
 Title

April 30, 1981
 Date