

KANSAS DRILLERS LOG

S. 28 T. 19 R. 5 E W

API No. 15 _____
County _____ Number _____

Loc. APP E2 NW SW
County Marion

Operator
R. L. Burns

Address
Box 277 Marion, Kansas 66861

Well No. 2 Lease Name Gilbert

Footage Location 1980 1680
feet from (N) (S) line feet from (E) (W) line

Principal Contractor Kan Go, Inc. Geologist Frank S. Mize

Spud Date 3-11-77 Total Depth 2345 P.B.T.D. 2311

Date Completed 3-15-77 Oil Purchaser Summit

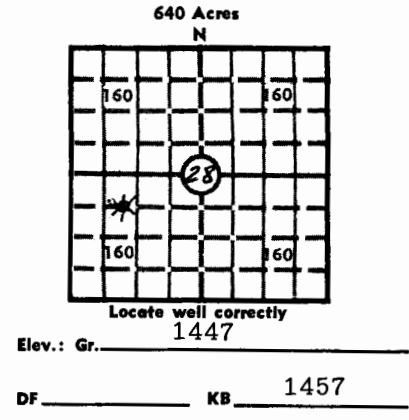

CASING RECORD

Report of all strings set— surface, intermediate, production, etc.

Purpose of string	Size hole drilled	Size casing set (in O.D.)	Weight lbs/ft.	Setting depth	Type cement	Sacks	Type and percent additives
Surface	12 1/4	8 5/8		217 K.B.	Class A	175	4% ca cl
Production	7 7/8	4 1/2"	9 1/2#	2323 K.B.	Class A	150	

LINER RECORD

PERFORATION RECORD

Top, ft.	Bottom, ft.	Sacks cement	Shots per ft.	Size & type	Depth interval
			1	3 1/8" D.P.C.G.	2228-48

TUBING RECORD

Size	Setting depth	Packer set at
2 3/8	2207 G.L.	

ACID, FRACTURE, SHOT, CEMENT SQUEEZE RECORD

Amount and kind of material used	Depth interval treated
200 sx 20-40 sand; 400 sx 10-20 sand; 600# LFW-40; 10# TCC-1 breaker	Interval perferd

INITIAL PRODUCTION

Date of first production <u>4-16-77</u>	Producing method (flowing, pumping, gas lift, etc.) <u>Flowing</u>
RATE OF PRODUCTION PER 24 HOURS	Oil <u>0</u> bbls. Gas <u>345</u> MCF Water <u>0</u> bbls. Gas-oil ratio _____ CFPB
Disposition of gas (vented, used on lease or sold) <u>Sold</u>	Producing interval (s) <u>Mississippi Chat</u>

INSTRUCTIONS: As provided in KCC Rule 82-2-125, within 90 days after completion of a well, one completed copy of this Drillers Log shall be transmitted to the State Geological Survey of Kansas, 4150 Monroe Street, Wichita, Kansas 67209. Copies of this form are available from the Conservation Division, State Corporation Commission, 3830 So. Meridian (P.O. Box 17027), Wichita, Kansas 66217. Phone AC 316-522-2206. If confidential custody is desired, please note Rule 82-2-125. Drillers Logs will be on open file in the Oil and Gas Division, State Geological Survey of Kansas, Lawrence, Kansas 66044.

Operator

R. L. Burns

DESIGNATE TYPE OF COMP.: OIL, GAS, DRY HOLE, SWDW, ETC.:

Well No.

2

Lease Name

Gilbert

S 28 T 19 R 5 E W

WELL LOG

Show all important zones of porosity and contents thereof; cored intervals, and all drill-stem tests, including depth interval tested, cushion used, time tool open, flowing and shut-in pressures, and recoveries.

SHOW GEOLOGICAL MARKERS, LOGS RUN, OR OTHER DESCRIPTIVE INFORMATION.

FORMATION DESCRIPTION, CONTENTS, ETC.	TOP	BOTTOM	NAME	DEPTH
Lansing	1723		Welex IEL and comp. density	From T.D.- surface pipe
Base Kansas City		2074		
Mississippi Chat	2226	2282		
Mississippi Lime	2282	2311		
Kinderhook Shale	2311			

USE ADDITIONAL SHEETS, IF NECESSARY, TO COMPLETE WELL RECORD.

Date Received

Frank J. Szyja
Signature

GEOLOGIST
Title

4-25-77
Date