

**KANSAS DRILLERS LOG WICHITA BRANCH**

S. 27 T. 19S R. 7E <sup>E</sup> <sub>W</sub>  
Loc. SW SW  
County Chase

API No. 15 — 017 — 20092  
County Number

Operator  
Benson Mineral Group, Inc.

Address  
1400 Metrobank Building, Denver, Colorado 80202

Well No. 1-27 Lease Name Thurston

Footage Location  
feet from (N) (S) line feet from (E) (W) line

Principal Contractor B & N Drilling Geologist

Spud Date 1-28-78 Total Depth 1185 P.B.T.D.

Date Completed 1-30-78 Oil Purchaser

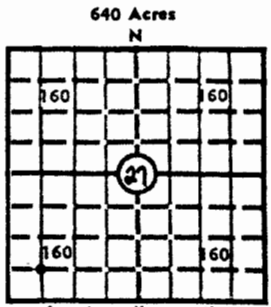

Elev.: Gr. \_\_\_\_\_  
DF \_\_\_\_\_ KB \_\_\_\_\_

**CASING RECORD**

Report of all strings set— surface, intermediate, production, etc.

Purpose of string	Size hole drilled	Size casing set (in O.D.)	Weight lbs/ft.	Setting depth	Type cement	Sacks	Type and percent additives
Surface	8-3/4	7"		108			
Production	6 1/4						

**LINER RECORD**

**PERFORATION RECORD**

Top, ft.	Bottom, ft.	Sacks cement	Shots per ft.	Size & type	Depth interval
None			None		

**TUBING RECORD**

Size	Setting depth	Packer set at
None		

**ACID, FRACTURE, SHOT, CEMENT SQUEEZE RECORD**

Amount and kind of material used	Depth interval treated
None	

**INITIAL PRODUCTION**

Date of first production <u>TA</u>	Producing method (flowing, pumping, gas lift, etc.)
RATE OF PRODUCTION PER 24 HOURS	Oil bbls. Gas MCF Water bbls. Gas-oil ratio CFPB
Disposition of gas (vented, used on lease or sold)	Producing interval (s)

INSTRUCTIONS: As provided in KCC Rule 82-2-125, within 90 days after completion of a well, one completed copy of this Driller's Log shall be transmitted to the State Geological Survey of Kansas, 4150 Monroe Street, Wichita, Kansas 67209. Copies of this form are available from the Conservation Division, State Corporation Commission, 3830 So. Meridian (P.O. Box 17027), Wichita, Kansas 66217. Phone AC 316-522-2206. If confidential custody is desired, please note Rule 82-2-125. Drillers Logs will be on open file in the Oil and Gas Division, State Geological Survey of Kansas, Lawrence, Kansas 66044.

operator

DESIGNATE TYPE OF COMP.: OIL, GAS,  
DRY HOLE, SWDW, ETC.:

Benson Mineral Group, Inc.

Well No. 1-27	Lease Name Thurston	27-19-7E		
S 27 T 19S R 7E E W				
<b>WELL LOG</b>		SHOW GEOLOGICAL MARKERS, LOGS RUN, OR OTHER DESCRIPTIVE INFORMATION.		
Show all important zones of porosity and contents thereof; cored intervals, and all drill-stem tests, including depth interval tested, cushion used, time tool open, flowing and shut-in pressures, and recoveries.				
FORMATION DESCRIPTION, CONTENTS, ETC.	TOP	BOTTOM	NAME	DEPTH
soil	0	5		
clay	5	10		
shale	10	25		
sand	25	40		
lime	40	42		
shale	42	75		
lime	75	77		
sandy shale	77	108		
lime	108	111		
shale	111	284		
broken lime & shale	284	540		
lime	540	547		
sandy shale	547	551		
lime	551	569		
sandy shale	569	573		
lime	573	585		
sandy shale	585	613		
lime	613	639		
sandy shale	639	668		
lime	668	675		
sandy shale	675	698		
lime	698	710		
sandy shale	710	719		
lime	719	742		
sandy shale	742	757		
lime	757	775		
shale/lime	775	779		
sandy shale	779	784		
shale/lime	784	827		
lime	827	859		
shale	859	863		
lime	867	883		
shale	883	904		
lime	904	906		
sand/shale	906	1017		
lime	1017	1021		
sandy shale	1021	1128		
lime	1128	1150		
shale	1150	1185		
USE ADDITIONAL SHEETS, IF NECESSARY, TO COMPLETE WELL RECORD.				
Date Received	<i>Paul C. Edlison (pos)</i> Signature <i>Vice President</i> Title <i>Sept. 21, 1981</i> Date			

584501