

KANSAS DRILLERS LOG WICHITA BRANCH

S. 20 T. 20S R. 7E ^E/_W

API No. 15 — 017 — 20105
 County Number

Loc. C SE SW
 County Chase

Operator
 Benson Mineral Group, Inc.

Address
 1400 Metrobank Bldg, 475 Seventeenth St, Denver, CO, 80202

Well No. Lease Name
 1-20 Outpost Cattle Company

Footage Location
 feet from (N) (S) line feet from (E) (W) line

Principal Contractor Geologist
 B & N Drilling Company

Spud Date Total Depth P.B.T.D.
 2/15/78 1359

Date Completed Oil Purchaser
 2/17/78

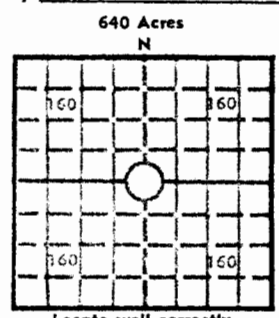

Locate well correctly
 Elev.: Gr. 1362 (Est)

DF _____ KB _____

CASING RECORD

Report of all strings set — surface, intermediate, production, etc.

Purpose of string	Size hole drilled	Size casing set (in O.D.)	Weight lbs/ft.	Setting depth	Type cement	Sacks	Type and percent additives
Surface	9-7/8"	7"		57'			
Production	Plugged & Abandon on 2/18/78						
Inclosure: Induction Electric Log and Compensated Density							

LINER RECORD

PERFORATION RECORD

Top, ft.	Bottom, ft.	Sacks cement	Shots per ft.	Size & type	Depth interval
TUBING RECORD			Not perforated		
Size	Setting depth	Packer set at			

ACID, FRACTURE, SHOT, CEMENT SQUEEZE RECORD

Amount and kind of material used	Depth interval treated
None	

INITIAL PRODUCTION

Date of first production None	Producing method (flowing, pumping, gas lift, etc.)				
RATE OF PRODUCTION PER 24 HOURS	Oil	Gas	Water	Gas-oil ratio	
	bbls.	MCF	bbls.	CFPB	
Disposition of gas (vented, used on lease or sold)			Producing interval (s)		

INSTRUCTIONS: As provided in KCC Rule 82-2-125, within 90 days after completion of a well, one completed copy of this Drillers Log shall be transmitted to the State Geological Survey of Kansas, 4150 Monroe Street, Wichita, Kansas 67209. Copies of this form are available from the Conservation Division, State Corporation Commission, 3830 So. Meridian (P.O. Box 17027), Wichita, Kansas 66217. Phone AC 316-522-2206. If confidential custody desired, please note Rule 82-2-125. Drillers Logs will be on an open file in the Oil and Gas Division, State Geological Survey of Kansas, Lawrence, Kansas 644.

20-20-7E

DESIGNATE TYPE OF COMP.: OIL, GAS, DRY HOLE, SWDW, ETC.:

Benson Mineral Group, Inc.

Well No. 1-20	Lease Name Outpost Cattle Company	Plugged & Abandon
------------------	--------------------------------------	-------------------

S20 T 20SR 7E ^E_W

WELL LOG

Show all important zones of porosity and contents thereof; cored intervals, and all drill-stem tests, including depth interval tested, cushion used, time tool open, flowing and shut-in pressures, and recoveries.

SHOW GEOLOGICAL MARKERS, LOGS RUN, OR OTHER DESCRIPTIVE INFORMATION.

FORMATION DESCRIPTION, CONTENTS, ETC.	TOP	BOTTOM	NAME	DEPTH
soil/shale	0	10		
lime/shale	10	12		
lime	12	20		
shale	20	25		
lime	25	30		
shale	30	33		
lime	33	34		
shale	34	50		
lime	50	53		
shale	53	56		
lime	56	59		
shale	59	60		
lime/shale	60	71		
lime	71	75		
shale/lime	75	178		
shale	178	188		
lime	188	190		
shale	190	198		
lime	198	200		
shale	200	239		
lime	239	241		
shale	241	276		
lime	276	278		
shalew/lime streaks	278	447		
lime	447	452		
shale	452	480		
lime	480	491		
shale	491	502		
lime	502	505		
shale	505	522		
shale/lime	522	533		
lime	533	542		
shale	542	552		
lime	552	559		
shale	559	625		
shale/lime	625	671		
lime	671	682		
shale	682	738		
lime	738	744		
lime/shale	744	747		

USE ADDITIONAL SHEETS, IF NECESSARY, TO COMPLETE WELL RECORD.

Date Received	<i>Coastney E Cook</i>
	Signature
	Production Manager
	Title
	3/8/78
	Date

20-20-7E

Benson Mineral Group, Inc.
Outpost Cattle Company
Well No. 1-20
Well Log
Page 2 of 2

lime	747	760
shale	760	770
lime	770	780
shale	780	807
lime	807	817
shale	817	835
lime	835	841
shale	841	852
lime	852	854
shale	854	866
lime	866	873
shale	873	903
lime	903	906
lime/shale	906	917
lime	917	941
lime/shale	941	968
lime	968	976
shale	976	1017
lime	1017	1053
shale	1053	1056
lime	1056	1059
shale	1059	1064
lime	1064	1077
shale	1077	1094
lime	1094	1100
shale/lime	1100	1236
lime	1236	1239
shale	1239	1318
Lansing	1318	1359