

KANSAS DRILLERS LOG

IMPORTANT
Kans. Geo. Survey request
samples on this well.

State Geological Survey
WICHITA BRANCH
SEP 8 0 1979

S. 32 T. 21 R. 12 E
W

API No. 15 — 111 — 20,272
County Number

Loc. C NE NE
County Lyon

Operator
Liberty Enterprises, Inc.

Address
308 West Mill Plainville, Kansas 67663

Well No. #2 Lease Name Nuessen

Footage Location
C NE NE
feet from (N) (S) line feet from (E) (W) line

Principal Contractor Geologist
Jackman & Jackman Bill Johnson

Drill Date Total Depth P.B.T.D.
8-20-79 1937' 1932'

Date Completed Oil Purchaser
9-07-79 Cities Service

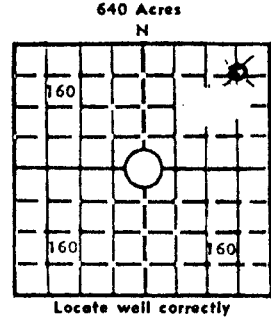

Locate well correctly
Elev.: Gr. 1189'
DF 1192' KB 1194'

CASING RECORD

Report of all strings set — surface, intermediate, production, etc.

Purpose of string	Size hole drilled	Size casing set (in O.D.)	Weight lbs./ft.	Setting depth	Type cement	Socks	Type and percent additives
surface	12 1/4"	8 5/8"	28#	87'	Common	75	
prod. string	7 7/8"	4 1/2"	9.5#	1936'	Poz mix	100	60-40 poz

LINER RECORD

PERFORATION RECORD

Top, ft.	Bottom, ft.	Sacks cement	Shots per ft.	Size & type	Depth interval
			20 holes	3/8"	1880-1901

TUBING RECORD

Size	Setting depth	Packer set at
2" EVE	1925'	

ACID, FRACTURE, SHOT, CEMENT SQUEEZE RECORD

Amount and kind of material used	Depth interval treated
Frac 5000# sand 300 barrel water	Bartlesville 1880'-1901

INITIAL PRODUCTION

Date of first production	Producing method (flowing, pumping, gas lift, etc.)
11-30-79	Pumping
RATE OF PRODUCTION PER 24 HOURS	Gas-oil ratio
Oil 4 bbls. Gas MCF 90 bbls. Water CFPB	
Disposition of gas (vented, used on lease or sold)	Producing interval(s)
No gas	1880'-1901' Bartlesville

INSTRUCTIONS: As provided in KCC Rule 82-2-125, within 90 days after completion of a well, one completed copy of this Drillers Log shall be transmitted to the State Geological Survey of Kansas, 4150 Monroe Street, Wichita, Kansas 67209. Copies of this form are available from the Conservation Division, State Corporation Commission, 1110 So. Meridian (P.O. Box 17027), Wichita, Kansas 67217. Phone: 620-316-5333.

147041

Operator
Liberty Enterprises, Inc.

DESIGNATE TYPE OF COMP.: OIL,
DRY HOLE, SWDW, ETC.:
oil

Well No.
#2

Lease Name
Nuessen

S 32 T 21SR 12 XX
W

WELL LOG

Show all important zones of porosity and contents thereof; cored intervals, and all drill-stem tests, including depth interval tested, cushion used, time tool open, flowing and shut-in pressures, and recoveries.

SHOW GEOLOGICAL MARKERS, LOGS RUN,
OR OTHER DESCRIPTIVE INFORMATION.

FORMATION DESCRIPTION, CONTENTS, ETC.	TOP	BOTTOM	NAME	DEPTH

USE ADDITIONAL SHEETS, IF NECESSARY, TO COMPLETE WELL RECORD.

Date Received

Charles D. Farris
Signature

Production Superintendent
Title

February 20, 1980
Date

107

32-21-12E

WELL LOG

State Geological Survey
WICHITA, BRANCH

Company Liberty Enterprises, Inc.
 Farm Nuessen
 Well # 2
 Location C - NE - NE 32 - 21S - 12E Lyon County, Kansas
 Commenced August 20, 1979
 Completed August 23, 1979
 Casing 87' of 8 5/8" cemented with 45 sacks
 1936' of 4 1/2" cemented with 75 sacks
 Contractor Jackman & Jackman
 Production Testing
 Total Depth 1937'

Soil & Clay	0	-	3
Lime & Shale	3		42
Shale & Shells	42		70
Plug & Cement	70		88
Shale & Shells	88		540
Shale & Shells	540		769
Lime	769		771
Water Sand	771		940
Lime	940		1094
Shale	1094		1179
Lime	1179		1360
Shale & Shells	1360		1875
Core #1	1875		1902
Sandy Shale	1902		1937

0' is 4' above ground level.

35-91-19E

147041