

T. G. WRIGHT

Consulting Geologist

620 FOURTH FINANCIAL CENTER

WICHITA, KANSAS 67202

March 4, 1975

GEOLOGICAL WELL REPORT

Gear Operating Co. #1 Wilson "A"

SW SW NE Section 1-T21S-R13E

Coffey County, Kansas

Contractor: Triangle Drilling Co.

Spud: February 19, 1975

8 5/8" Surface Casing @ 48'

Completed as dry hole: March 1, 1975

Total Depth: 2238'

2234' (GRN Log through drill pipe)

Gear Operating Co.
514 Union Center
Wichita, Kansas 67202

Gentlemen:

Listed below are the pertinent geological tops, an evaluation of the porosities encountered, and a record of all drill stem tests. The hole was logged by GRN Log 0-2234, through drill pipe, that data included herein.

I arrived at the location at a depth of 1090' and witnessed the drilling from that point to 1765 where the rig was shut down for weather. I returned at 1995' and witnessed the drilling from that point to 2238' TD. Samples were examined from 600-2238 TD.

Enclosed herewith is a copy of the plotted drilling time log from 100-2238 TD which also includes lithology, geologic tops, porous zones and other pertinent data.

GRN LOG TOPS

ELEVATION	1122 KB
HEEBNER	348 (+ 774)
DOUGLAS	384 (+ 738)
LANSING	690 (+ 436)
KANSAS CITY	967 (+ 155)
BASE OF KANSAS CITY	1090 (+ 32)
ALTAMONT	1259 (- 137)
PAWNEE	1320 (- 198)

T. G. WRIGHT
CONSULTING GEOLOGIST
WICHITA, KANSAS

CHEROKEE	1370 (- 248)	
U. SQUIRREL SAND	1375-96	
		Fine, dirty, micaceous sandstone well stained with dark oil. Poor porosity.
L. SQUIRREL SAND	1440-58	
1440-49		Dirty, micaceous sandstone, poor porosity no show.
1449-58		Fair clean sandstone fair porosity, no show.
MISSISSIPPIAN LIMESTONE	1790 (- 622)	
OSAGE	1881 (- 759)	
CHOTEAU	1970 (- 848)	
KINDERHOOK SHALE	2076 (- 954)	
BASE OF CHATTANOOGA SHALE-VIOLA	2159 (-1037)	
2159-65		Dolomite white, medium to coarsely crystalline, scattered good porosity with trace of free oil and well stained. Much white tripolitic chert with no show.

DRILL STEM TEST #1 AT 2157-65

Tool open 30 mins., very weak intermittent blow, shut in 30 mins.
Tool open 30 mins., weak intermittent blow throughout, shut in 30 mins.

Recovered: 30 feet mud, no show of oil, gas or water.

First Open FP 62-52
IBHP 156#/30 mins.
BH Temperature 93 °F

Second Open FP 62-62
FBHP 104#/30 mins.

SIMPSON SAND	2165 (-1042)	
2165-75		Sandstone, white, medium grained, rounded, clustered, porous to tightly lime cemented. Scattered free oil and good staining dry.

DRILL STEM TEST #2 AT 2162-70

Tool open 30 mins., weak blow throughout, shut in 30 mins.
Tool open 30 mins., weak intermittent blow throughout, shut in 30 mins.

Recovered: 20 feet of mud, heavy scum of oil on top and in tool.

First Open FP 10#	Second Open FP 10#
IBHP 699#/30 mins.	FBHP 699#/30 mins.
BH Temperature 101 °F	

DRILL STEM TEST #3 AT 2165-75

Tool open 30 mins., 2 1/2" weak blow throughout, shut in 30 mins.
Tool open 30 mins., 2 1/2" weak blow throughout, shut in 30 mins.

Recovered: 5' watery mud, 120' muddy water, no show of oil, gas.

First Open FP 10-31#	Second Open FP 62-73#
IBHP 772#/30 mins.	FBHP 772#/30 mins.
BH Temperature 101 °F	

2175-2221 Sandstone, white, rounded, medium grained to medium coarse, loosely cemented to loose grains. Porous, no show.

ARBUCKLE

2221 (-1099)

2221-38 Dolomite, tan to brown and pinkish, dense to coarsely crystalline. Streaks of good cavernous porosity; no show. Very cherty in upper portion, oolitic chert in part.

TOTAL DEPTH

2238 GRN Log to 2234 through drill pipe

Conclusions and Recommendations

The subject well appears about normal structurally with reference to dry holes in Section 11, recently drilled, being 24 feet lower than the highest dry hole, the Dunne #1 Bluma, at the base of the Chattanooga. However the subject well is 9 feet higher at the base of the Chattanooga than the Stanolind #1 Butler 1/2 mile south. This is a normal relationship, however.

In the 6 feet of Viola found in this well some good cavernous porosity exists with oil staining and a trace of free oil. A major portion of the Viola is composed of white tripolitic chert with visible porosity but no show. The Viola was condemned by drill stem test #1.

March 4, 1975

In the upper portion of the Simpson Sand good porosities were encountered in a clean, clustered sand which carried scattered good staining and a trace of free oil. Much of the sand was tightly cemented over drill stem test #2 but a small amount of free, live oil was observed in the test, not considered commercial.

The Upper Squirrel Sand carried a show of black heavy oil but the section was considered too fine, dirty and micaceous to be commercial.

As no shows of oil with commercial value were observed it was recommended that the well be abandoned as a dry hole.

Very truly yours,

T. G. Wright

TGW:bf

BIT RECORD

REED (Retip)	48- 440
SECURITY S-84 (Rerun)	440-1765
SECURITY S-88 (Rebuilt)	1765-2165
SECURITY S-88 (Rebuilt)	2165-2238 TD

DRILLING PROGRESS

2/19/75	Spud
2/20	180
2/21	905
2/22	1490
2/23	Shut Down - Storm
2/24	1765
2/25	1935
2/26	2080
2/27	2165
2/28	2175
3/1/75	2238 TD D&A

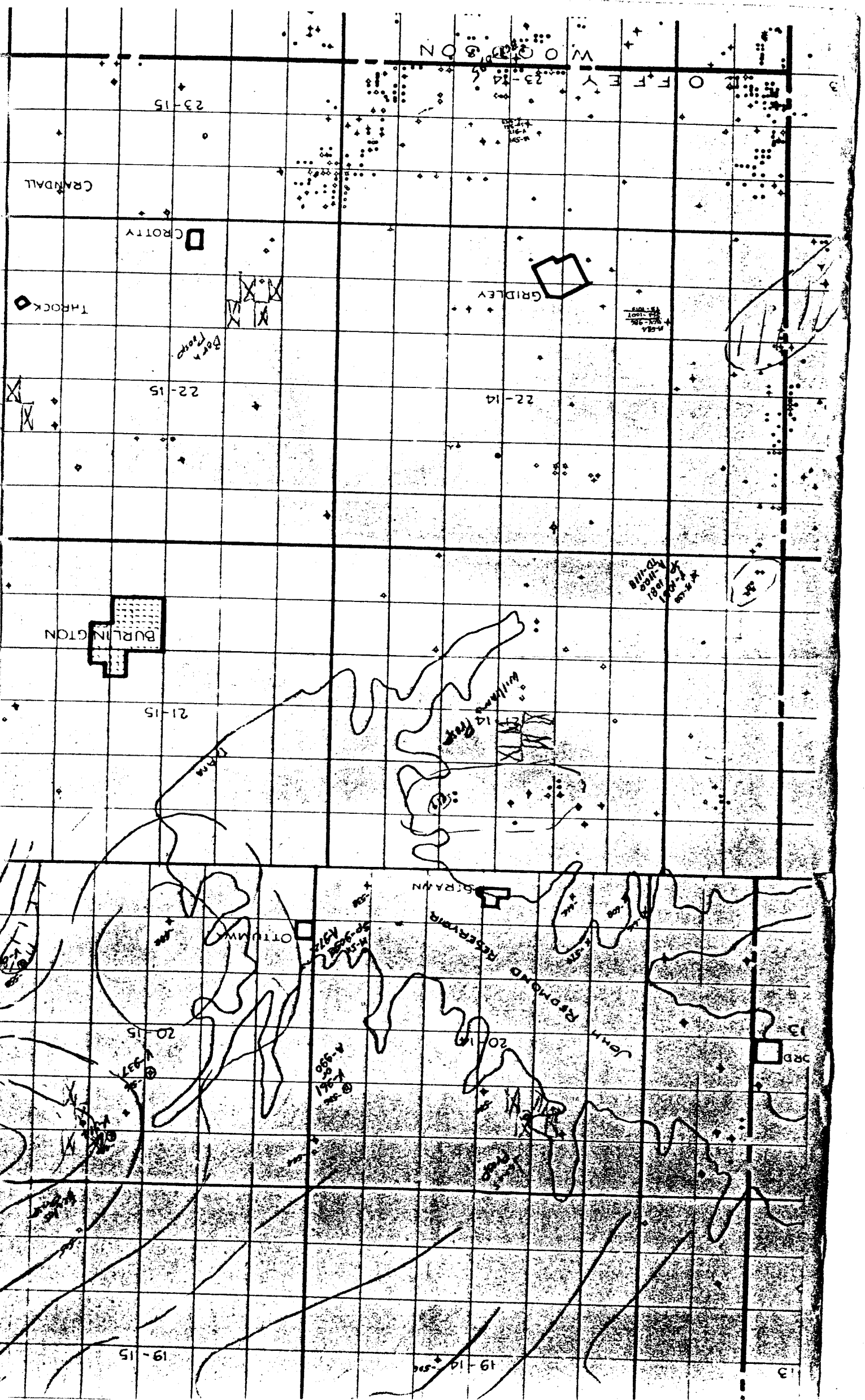



P. O. BOX 793 PHONE 793-7903
GREAT BEND, KANSAS

WESTERN TESTING CO., INC.
FORMATION TESTING

TICKET 21341

Formation Viola Elevation 1122 KB Eff. Pay _____ Ft.

District Augusta Date 2-27-75 Customer Order No. _____

COMPANY NAME Good Operating Inc

ADDRESS 514 UNION Center Bldg, Wichita, Kansas 67202

LEASE AND WELL NO. Wilson A #1 COUNTY Coffey STATE Kans Sec. 1 Twp. 21 Rge. 13E

Mail Inv. To Same Co. Name _____ Address _____ No. Copies Requested usual

Mail Charts To Same Address _____ No. Copies Requested usual

Formation Test No. 1 O.K. Misrun _____ Interval Tested From 2157 to 2165 Total Depth 2165

Size Main Hole 7 7/8 Rat Hole _____ Conv. _____ B.T. _____ Damaged _____ Yes _____ No Conv. _____ B.T. Damaged _____ Yes No

Top Packer Depth _____ Ft. Size _____ Bottom Packer Depth 2157 Ft. Size 6 3/4

Straddle _____ Conv. _____ B.T. _____ Damaged _____ Yes _____ No Packer Depth _____ Ft. Size _____

Tool Size 5 1/2 00 Tool Joint Size 4 1/2 FH Anchor Length 8 Ft. Size 5 1/2 00 Surface Choke Size 3/4 In. Bottom Choke Size 3/4 In.

RECORDERS Depth 2148 Ft. Clock No. 6859 Depth 2162 Ft. Clock No. 9102

Top Make Kuster Cap. 4200 No. 1559 Bottom Make Kuster Cap. 3150 No. 1565

Below Straddle: Depth _____ Rec. No. _____ Clock No. _____ Depth _____ Ft. Rec. No. _____ Clock No. _____

Time Set Packer 12:05 PM

Tool Open I.F.P. From 12:15 PM to 12:45 PM Hr. 30 Min. From (B) 62 P.S.I. To (C) 52 P.S.I.

Tool Closed I.C.I.P. From 12:45 PM to 1:15 PM Hr. 30 Min. (D) 156 P.S.I.

Tool Open F.F.P. From 1:15 PM to 1:45 PM Hr. 30 Min. From (E) 62 P.S.I. To (F) 62 P.S.I.

Tool Closed F.C.I.P. From 1:45 PM to 2:15 PM Hr. 30 Min. (G) 104 P.S.I.

Initial Hydrostatic Pressure (A) 1444 P.S.I. Final Hydrostatic Pressure (H) 1409 P.S.I. Maximum Temp. 93

INFORMATION

BLOW Very Weak Intermittent Blow about I.F.P
Weak Intermittent about F.F.P.

Did Well Flow Yes No _____ Recovery Total Ft. 30 Ft of D. lg Mud

Reversed Out Yes No _____ Mud Type chem Viscosity 75 Weight 9.2 Water Loss 8.0 cc. Chlorides 14.00

EXTRA EQUIPMENT: Type Circ. Sub. P.N Safety Joint _____ Jars: Size _____ In. Make _____ Ser. No. _____

Dual Packers NO Did Packers Hold? yes Did Tool Plug? NO Where? _____

DRILLING CONTRACTOR Triangle D. lg Co Length Drill Pipe 1799 ft. I.D. Drill Pipe 3.8 In. Tool Joint Size 4 1/2 FH

Length Weight Pipe _____ ft. I.D. Weight Pipe _____ In. Tool Joint Size _____ In. Length Drill Collars 336 ft. I.D. Drill Collars 2 1/4 In.

Tool Joint Size 4" H-90 In. Length D.S.T. Tool 30 ft.

Remarks Sled Tool 3 FT To Bottom

Inside Recorder Clock Quite
Real outside Recorder

COMPANY TERMS
Western Testing Co., Inc., shall not be liable for damage of any kind to the property or personnel of the one for whom a test is made or for any loss suffered or sustained directly or indirectly through the use of its equipment, or its statements or opinion concerning the results of any test. Tools lost or damaged in the hole shall be paid at cost by the party for whom the test is made.
All charges subject to 10% interest after 60 days from date of invoice. Any expense incurred for collection will be added to the original amount.

INVOICE SECTION	
Open Hole Test	\$ 285.00
Straddle Test	\$
Jars	\$
Selective Zone	\$
Safety Joint	\$
Misrun	\$
Evaluation	\$
Packer	\$
Circ. Sub.	\$
Total	\$ 285.00

Test Approved By _____ Western Representative Forest Penell

Signature of Customer or his Authorized Representative _____ Operator's Time _____ Hrs.



WESTERN TESTING CO., INC.
FORMATION TESTING

TICKET 21342

P. O. BOX 793 PHONE 793-7903

GREAT BEND, KANSAS

Formation Simpson Elevation 1122 KB Eff. Pay _____ Ft.

District Augusta Date 2-27-75 Customer Order No. _____

COMPANY NAME Gear Operating Inc.

ADDRESS 514 UNION CENTER BLDG. WICHITA, KANSAS 67202

LEASE AND WELL NO. Wilson A #1 COUNTY COFFEY STATE KANSAS Sec. 1 Twp. 21 Rge. 13E

Mail Inv. To Same Co. Name _____ Address _____ No. Copies Requested Usual

Mail Charts To Same Co. Name _____ Address _____ No. Copies Requested Usual

Formation Test No. #2 O.K. Misrun _____ Interval Tested From 2163 to 2170 Total Depth 2170

Size Main Hole 7 7/8 Rat Hole _____ Conv. _____ B.T. _____ Damaged _____ Yes _____ No Conv. _____ B.T. Damaged _____ Yes No

Top Packer Depth _____ Ft. Size _____ Bottom Packer Depth 2163 Ft. Size 6 3/4

Straddle _____ Conv. _____ B.T. _____ Damaged _____ Yes _____ No Packer Depth _____ Ft. Size _____

Tool Size 5 200 Tool Joint Size 4 1/2 FH Anchor Length 8 Ft. Size 5 200 Surface Choke Size 3/4 In. Bottom Choke Size 3/4 In.

RECORDERS Depth 2157 Ft. Clock No. 6800 Depth 2167 Ft. Clock No. 9102

Top Make Kuster Cap. 4200 No. 1559 Inside Bottom Make Kuster Cap. 3150 No. 1565 Inside

Below Straddle: Depth _____ Rec. No. _____ Clock No. _____ Inside Depth _____ Ft. Rec. No. _____ Clock No. _____ Inside

Time Set Packer 9:25 PM

Tool Open I.F.P. From 9:30 PM to 10:00 PM Hr. 30 Min. From (B) 10 P.S.I. To (C) 10 P.S.I.

Tool Closed I.C.I.P. From 10:00 PM to 10:30 PM Hr. 30 Min. (D) 699 P.S.I.

Tool Open F.F.P. From 10:30 PM to 11:00 PM Hr. 30 Min. From (E) 20 P.S.I. To (F) 20 P.S.I.

Tool Closed F.C.I.P. From 11:00 PM to 11:30 PM Hr. 30 Min. (G) 699 P.S.I.

Initial Hydrostatic Pressure (A) 1043 P.S.I. Final Hydrostatic Pressure (H) 1043 P.S.I. Maximum Temp. 101

INFORMATION

BLOW Weak 1/4 in Blow shutout I.F.P. decreasing to a very weak

intermittent Blow shutout F.F.P.

Did Well Flow _____ Yes No _____ Recovery Total Ft. 20 FT OF THIN OILY MUD WITH SUCRAFOIL

Headge SUCRA FOIL ON TOOL

Reversed Out _____ Yes No _____ Mud Type Chena Viscosity 73 Weight 9.1 Water Loss 8.0 cc. Chlorides 1400

EXTRA EQUIPMENT: Type Circ. Sub. PIN Safety Joint NO Jars: Size _____ In. Make _____ Ser. No. _____

Dual Packers NO Did Packers Hold? yes Did Tool Plug? NO Where? _____

DRILLING CONTRACTOR Triangle Drilling Co Length Drill Pipe 1804 ft. I.D. Drill Pipe 3.8 In. Tool Joint Size 4 1/2 FH In.

Length Weight Pipe _____ ft. I.D. Weight Pipe _____ In. Tool Joint Size _____ In. Length Drill Collars 336 ft. I.D. Drill Collars 2 1/4 In.

Tool Joint Size 4 H-59 In. Length D.S.T. Tool 30 ft.

Remarks outside Recorder clock test

INVOICE SECTION

Open Hole Test	\$ 285.00
Straddle Test	\$
Jars	\$
Selective Zone	\$
Safety Joint	\$
Misrun	\$
Evaluation	\$
Packer	\$
Circ. Sub.	\$
Total	\$ 285.00

COMPANY TERMS

Western Testing Co., Inc., shall not be liable for damage of any kind to the property or personnel of the one for whom a test is made or for any loss suffered or sustained directly or indirectly through the use of its equipment, or its statements or opinion concerning the results of any test. Tools lost or damaged in the hole shall be paid at cost by the party for whom the test is made.

All charges subject to 10% interest after 60 days from date of invoice. Any expense incurred for collection will be added to the original amount.

Test Approved By _____ Western Representative Forest Burnell

Signature of Customer or his Authorized Representative

Operator's Time _____ Hrs.



P. O. BOX 793 PHONE 793-7903
GREAT BEND, KANSAS

WESTERN TESTING CO., INC.
FORMATION TESTING

TICKET 21343

Formation Simpson Elevation 1122 KB Eff. Pay _____ Ft.

District Augusta Date 2-28-75 Customer Order No. _____
COMPANY NAME Gear Operating Inc.
ADDRESS 514 UNION CENTER Bldg Wichita, Kansas 67202
LEASE AND WELL NO. Wilson "A" #1 COUNTY Coffey STATE Kansas Sec. 1 Twp. 21 Rge. 13E
Mail Inv. To Same No. Copies Requested USUAL
Co. Name _____ Address _____
Mail Charts To Same No. Copies Requested USUAL
Address _____

Formation Test No. #3 O.K. Misrun _____ Interval Tested From 2165 to 2175 Total Depth 2175
Size Main Hole 7 3/8 Rat Hole _____ Conv. _____ B.T. _____ Damaged _____ Yes _____ No Conv. _____ B.T. Damaged _____ Yes No
Top Packer Depth _____ Ft. Size _____ Bottom Packer Depth 2165 Ft. Size 6 3/4
Straddle _____ Conv. _____ B.T. _____ Damaged _____ Yes _____ No Packer Depth _____ Ft. Size _____
Tool Size 5 1/2 00 Tool Joint Size 4 1/2 FH Anchor Length 10 Ft. Size 5 1/2 00 Surface Choke Size 3 1/4 In. Bottom Choke Size 3 1/4 In.

RECORDERS Depth 2169 Ft. Clock No. 6800 Depth 2172 Ft. Clock No. 6859
Top Make Kuster Cap. 4200 No. 1559 Inside Outside Bottom Make Kuster Cap. 3150 No. 1565 Inside Outside
Below Straddle: Depth _____ Rec. No. _____ Clock No. _____ Outside Depth _____ Ft. Rec. No. _____ Clock No. _____ Outside

Time Set Packer 8:10 AM
Tool Open I.F.P. From 8:15 AM to 8:45 AM Hr. 30 Min. From (B) 10 P.S.I. To (C) 31 P.S.I.
Tool Closed I.C.I.P. From 8:45 AM to 9:15 AM Hr. 30 Min. (D) 772 P.S.I.
Tool Open F.F.P. From 9:15 AM to 9:45 AM Hr. 30 Min. From (E) 62 P.S.I. To (F) 73 P.S.I.
Tool Closed F.C.I.P. From 9:45 AM to 10:15 AM Hr. _____ Min. (G) 772 P.S.I.
Initial Hydrostatic Pressure (A) 1045 P.S.I. Final Hydrostatic Pressure (H) 1043 P.S.I. Maximum Temp. _____

INFORMATION

BLOW Weak 2 1/2 IN Blow Throat Test
Did Well Flow _____ Yes No _____ Recovery Total Ft. 5 FT Then Drily Mud 120 FT OF Muddy Water

Reversed Out _____ Yes No _____ Mud Type Chem Viscosity 44 Weight 9.8 Water Loss 8.0 cc. Chlorides 1400
EXTRA EQUIPMENT: Type Circ. Sub. PIN Safety Joint _____ Jars: Size _____ In. Make _____ Ser. No. _____
Dual Packers NO Did Packers Hold? yes Did Tool Plug? NO Where? _____

DRILLING CONTRACTOR Triangle Drly Co Length Drill Pipe 1813 ft. I.D. Drill Pipe 3.8 In. Tool Joint Size 4 1/2 FH In.
Length Weight Pipe _____ ft. I.D. Weight Pipe _____ In. Tool Joint Size _____ In. Length Drill Collars 336 ft. I.D. Drill Collars 2 1/4 In.
Tool Joint Size 4" H-90 In. Length D.S.T. Tool 26 ft.

Remarks outside Recorder Drum Jam

INVOICE SECTION

Open Hole Test	\$ 285.00
Straddle Test	\$
Jars	\$
Selective Zone	\$
Safety Joint	\$
Misrun	\$
Evaluation	\$
Packer	\$
Circ. Sub.	\$
Total	\$ 285.00

COMPANY TERMS
Western Testing Co., Inc., shall not be liable for damage of any kind to the property or personnel of the one for whom a test is made or for any loss suffered or sustained directly or indirectly through the use of its equipment, or its statements or opinion concerning the results of any test. Tools lost or damaged in the hole shall be paid at cost by the party for whom the test is made.
All charges subject to 10% interest after 60 days from date of invoice. Any expense incurred for collection will be added to the original amount.

Test Approved By [Signature] Western Representative James Pennell
Signature of Customer or his Authorized Representative _____ Operator's Time _____ Hrs.

