

ORIGINAL SIDE ONE

STATE CORPORATION COMMISSION OF KANSAS
OIL & GAS CONSERVATION DIVISION
WELL COMPLETION FORM
ACO-1 WELL HISTORY
DESCRIPTION OF WELL AND LEASE

Operator: License # 3310
 Name: Vince Kent
 Address: 215 W. 10th
 City/State/Zip: Cornett, Ks
 Purchaser: Enron
 Operator Contact Person: Vince Kent
 Phone: (913) 448-3922
 Contractor: Name: Kent Drilling
 License: 5810
 Wellsite Geologist: Vince Kent

Designate X type of Completion
 New Well Re-Entry Workover
 Oil SWD Temp. Abd.
 Gas Inj Delayed Comp.
 Dry Other (Core, Water Supply, etc.)

If **OWWO**: old well info as follows:
 Operator: _____
 Well Name: _____
 Comp. Date _____ Old Total Depth _____
 Drilling Method: Mud Rotary Air Rotary Cable
9-21-90 9-22-90 9-22-90
 Spud Date Date Reached TD Completion Date

API No. 15- 003-23,128
 County Anderson
N 1/2 S 1/2 NESE Sec. 14 Twp. 21 Rge. 20 East West
1815 Ft. North from Southeast Corner of Section
660 Ft. West from Southeast Corner of Section
 (NOTE: Locate well in section plat below.)
 Lease Name Iowa College Well # 8
 Field Name Bush City Shoestring
 Producing Formation Squirrel
 Elevation: Ground 1040 KB _____
 Total Depth 729 PBTB 718.30

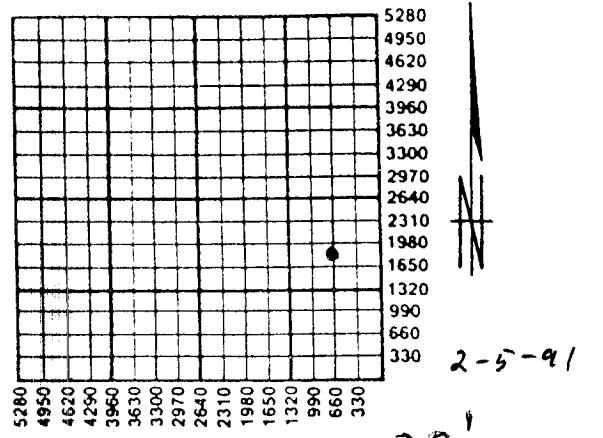

Amount of Surface Pipe Set and Cemented at 20' Feet
 Multiple Stage Cementing Collar Used? Yes No
 If yes, show depth set _____ Feet
 If Alternate II completion, cement circulated from top
 feet depth to bottom w/ 88 sx cmt.

INSTRUCTIONS: This form shall be completed in triplicate and filed with the Kansas Corporation Commission, 200 Colorado Derby Building, Wichita, Kansas 67202, within 120 days of the spud date of any well. Rule 82-3-130, 82-3-107 and 82-3-106 apply. Information on side two of this form will be held confidential for a period of 12 months if requested in writing and submitted with the form. See rule 82-3-107 for confidentiality in excess of 12 months. **One copy of all wireline logs and drillers time log shall be attached with this form. ALL CEMENTING TICKETS MUST BE ATTACHED.** Submit CP-4 form with all plugged wells. Submit CP-111 form with all temporarily abandoned wells. Any recompletion, workover or conversion of a well requires filing of ACO-2 within 120 days from commencement date of such work.

All requirements of the statutes, rules and regulations promulgated to regulate the oil and gas industry have been fully complied with and the statements herein are complete and correct to the best of my knowledge.

Signature Vince J. Kent
 Title Producer-owner Date 11-20-90
 Subscribed and sworn to before me this 20th day of November, 1990.
 Notary Public Loren J. Sayers
 Date Commission Expires 2-25-91
LOREN J. SAYERS
 NOTARY PUBLIC
 State of Kansas
 My Appt. Expires 2-25-91

K.C.C. OFFICE USE ONLY		
F	<input type="checkbox"/>	Letter of Confidentiality Attached
C	<input checked="" type="checkbox"/>	Wireline Log Received
C	<input type="checkbox"/>	Drillers Timelog Received
Distribution		
<input checked="" type="checkbox"/>	KCC	<input type="checkbox"/> SWD/Rep <input type="checkbox"/> NGPA
<input type="checkbox"/>	KGS	<input type="checkbox"/> Plug <input type="checkbox"/> Other (Specify)

SIDE TWO

Operator Name Kent Oil - Vince Kent Lease Name Fowa College Well # 8
 Sec. 14 Twp. 21 Rge. 20 East West
 County Anderson

INSTRUCTIONS: Show important tops and base of formations penetrated. Detail all cores. Report all drill stem tests giving interval tested, time tool open and closed, flowing and shut-in pressures, whether shut-in pressure reached static level, hydrostatic pressures, bottom hole temperature, fluid recovery, and flow rates if gas to surface during test. Attach extra sheet if more space is needed. Attach copy of log.

Drill Stem Tests Taken Yes No
 (Attach Additional Sheets.)
 Samples Sent to Geological Survey Yes No
 Cores Taken Yes No
 Electric Log Run Yes No
 (Submit Copy.)

Formation Description		
Name	Top	Bottom
KC	0	288
FT Scott	589	600
Squirrel	600	695

CASING RECORD <input type="checkbox"/> New <input checked="" type="checkbox"/> Used							
Report all strings set-conductor, surface, intermediate, production, etc.							
Purpose of String	Size Hole Drilled	Size Casing Set (In O.D.)	Weight Lbs./Ft.	Setting Depth	Type of Cement	# Sacks Used	Type and Percent Additives
Surface	9 7/8	6 5/8	14.00	201	#1 port	5	None
PERFORATION RECORD				Acid, Fracture, Shot, Cement Squeeze Record			
Shots Per Foot	Specify Footage of Each Interval Perforated			Amount and Kind of Material Used		Depth	
one	675 to 685			Well fract with 155 BBL of gelled water		718.30	
	690 to 694			# 500 bag 7% acid carrying 60 sacks #12 sand			
TUBING RECORD				Liner Run <input type="checkbox"/> Yes <input checked="" type="checkbox"/> No			
Date of First Production	Size	Set At	Packer At				
10-1-90	3 1/2	718.30	none				
Producing Method	<input type="checkbox"/> Flowing <input checked="" type="checkbox"/> Pumping <input type="checkbox"/> Gas Lift <input type="checkbox"/> Other (Explain)						
Estimated Production Per 24 Hours	Oil Bbls.	Gas Mcf	Water Bbls.	Gas-Oil Ratio		Gravity	
	1/2 BBL	none	none				

Disposition of Gas: Vented Sold Used on Lease (If vented, submit ACO-18.)

METHOD OF COMPLETION Open Hole Perforation Dually Completed Commingled Other (Specify) _____

Production Interval _____

Sept. 30, 1990

ORIGINAL

KENT OIL
IOWA COLLEGE NO. 8

79 Soil & shale
 26 Lime
 40 Shale
 11 Lime
 25 Shale
 107 Lime
 173 Shale
 16 Lime
 112 Shale & shells
 11 Lime
 60 Shale
 35 Oil sand
 34 Shale

79 7" set @ 20' & cemented to surface.
 105 3 1/2" set @ 718.30 & cemented to surface.
 145 663 to 675 badly broken gas sand.
 156 675 to 685 broken oil sand good bleeding.
 181 685 to 688 shale.
 288 690 to 695 broken oil sand good bleeding.
 461
 477 Perforate 675 to 685, 690 to 694.
 589
 600
 660
 695
 729 T.D.

NOV 28 1990

STATION Oilwell OPERATOR F. C. Miller

P.O. Box 884
 Charlotte, Kansas 66720
 Phone (316) 431-9210

Ticket 79226

CONSOLIDATED OIL WELL SERVICES, INC.

ORIGINAL

Date <u>1-24-90</u>	Customer's Acct. No. <u>4648</u>	Sec. <u>14</u>	Twp. <u>21</u>	Range <u>20</u>	Well No. & Farm <u>Town College #3</u>	Place or Destination <u>Boyer City</u>
Charge To <u>Kent Oil Co.</u>			Owner <u>Village Mount.</u>			County <u>Anderson</u>
Mailing Address <u>215 W 6th</u>			Contractor <u>Kent Drilling</u>			State <u>KS</u>
City & State <u>Boyer City, MS. 66032</u>			Well Owner Operator Contractor			

CEMENTING SERVICE DATA

TYPE OF JOB		CASING		HOLE DATA		PLUGS AND HEAD		PRESSURE		CEMENT LEFT IN CASING	
Surface		New		Bore Size	<u>5 7/8</u>	Bottom	<u>1-5W</u>	Circulating	<u>200</u>	Requested	
Production	<u>-</u>	Used	<u>-</u>	Total Depth	<u>122'</u>	Top		Minimum		Necessity	
Squeeze		Size	<u>3 1/2</u>	Cable Tool		Head	<u>PC</u>	Maximum	<u>500</u>	Measured	
Pumping		Weight		Rotary	<u>-</u>	FLOAT EQUIPMENT		Sacks Cement	<u>38</u>		
Other		Depth	<u>712'</u>					Type & Brand	<u>Portland A-5 1/2 50 lb</u>		
		Type	<u>TRD EVE</u>					Admixes	<u>2% Gel / Gel / Hard</u>		

FRACTURING - ACIDIZING SERVICE DATA

Type of Job	At Intervals of						
Bbls Fracturing Fluid	Breakdown Pressure from		psi to		psi		
Treating Pressures: Maximum	psi	Minimum	psi	Avg. Pump Rate	<u>0</u>	GPM/BPM	Close In
Sand	Gals. Treating Acid		Type		<u>0</u>	Open Hole Diameter	
Well Treating Through: Tubing	Casing	Annulus		Size		Weight	
Remarks:							
No. Perforations	Pay Formation Name			Depth of Job		Ft.	

CEMENTING

INVOICE SECTION

FRACTURING - ACIDIZING

Pumping Charge	<u>1 well</u>	Office Use	\$	Pumping Charge		Office Use	\$
Pumping Charge	@		\$	Pumping Charge	@		\$
<u>88</u> Sacks Bulk Cement	@	<u>1111</u>		12x30 Sand	@		
Ton Mileage on Bulk Cement	<u>30</u>	@		10x20 Sand	@		
<u>45x</u> Premium Gel	@	<u>221</u>		x Sand	@		
Flo-Seal	@			Ton Mileage	@		
Calcium Chloride	@			Gals. Acid	@		
<u>1-3/8</u> Plug Rubber	@	<u>1106</u>	<u>1100</u>	Chemicals	@		
Equipment	@				@		
	@				@		
	@				@		
	@				@		
	@				@		
	@			Potassium Chloride	@		
	@			Rock Salt	@		
Granulated Salt	@			Water Gel	@		
Transport Truck (Hrs.)	@			Transport Truck (Hrs.)	@		
Vac Truck (Hrs.)	@			Vac Truck (Hrs.)	@		
<u>2000</u> Water	@				@		
		Tax	<u>2.10</u>			Tax	

A Finance Charge computed at 1 1/4% per month (annual percentage rate of 21%) will be added to balance over 30 days.

Total \$ 155.30

Total \$

NOV 28 1990