

STATE CORPORATION COMMISSION OF KANSAS
OIL & GAS CONSERVATION DIVISION

WELL COMPLETION OR RECOMPLETION FORM
ACO-1 WELL HISTORY

DESCRIPTION OF WELL AND LEASE

Operator: License # 5618
Name L&L Enterprises, Inc.
Address P.O. Box 85
City/State/Zip Derby, KS 67037

Purchaser.....

Operator Contact Person Bill D. Ham
Phone 316-263-8138

Contractor: License # 5830
Name Exploration, Inc.

Wellsite Geologist.....
Phone.....

Designate Type of Completion
 New Well Re-Entry Workover
 Oil SWD Temp Abd
 Gas Inj Delayed Comp.
 Dry Other (Core, Water Supply etc.)

If OWWO: old well info as follows:
Operator
Well Name
Comp. Date Old Total Depth.....

WELL HISTORY

Drilling Method:
 Mud Rotary Air Rotary Cable
3-20-85 3-21-85 3-21-85
Spud Date Date Reached TD Completion Date
490
Total Depth PBD

Amount of Surface Pipe Set and Cemented at 20 feet
Multiple Stage Cementing Collar Used? Yes No
If yes, show depth set.....feet
If alternate 2 completion, cement circulated
from.....feet depth to.....w/.....SX cmt

API NO. 15-107-22471
County Linn
Approx CSW SW Sec 7 Twp 21S Rge 22 East West
760 Ft North from Southeast Corner of Section
3290 Ft West from Southeast Corner of Section
(Note: Locate well in section plat below)
Lease Name Florence Gorrell Well # 7
Field Name Centerville
Producing Formation Squirrel Sand
Elevation: Ground +901 KB

JUL 01 1985
State Geological Survey
WICHITA BRANCH

RECEIVED
STATE CORPORATION COMMISSION
STATE
JUL 01 1985
CONSERVATION DIVISION
Wichita, Kansas

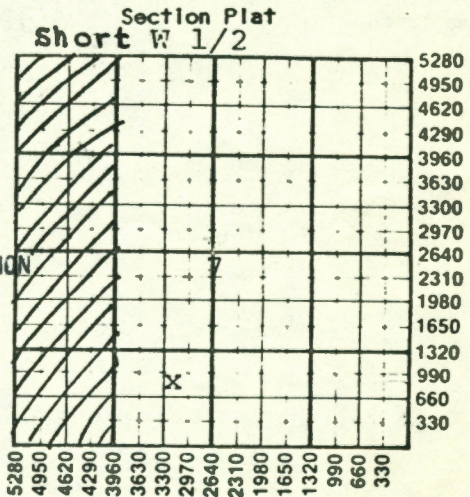

WATER SUPPLY INFORMATION

Disposition of Produced Water: Disposal Repressuring
Docket #

Questions on this portion of the ACO-1 call:
Water Resources Board (913) 296-3717

Source of Water:
Division of Water Resources Permit #.....
 Groundwater.....Ft North from Southeast Corner (Well)Ft West from Southeast Corner of Sec Twp Rge East West
 Surface Water.....Ft North from Southeast Corner (Stream, pond etc).....Ft West from Southeast Corner Sec Twp Rge East West
 Other (explain) Parker, KS
(purchased from city, R.W.D. #)

INSTRUCTIONS: This form shall be completed in duplicate and filed with the Kansas Corporation Commission, 200 Colorado Derby Building, Wichita, Kansas 67202, within 90 days after completion or recompletion of any well. Rule 82-3-130 and 82-3-107 apply.
Information on side two of this form will be held confidential for a period of 12 months if requested in writing and submitted with the form. See rule 82-3-107 for confidentiality in excess of 12 months.
One copy of all wireline logs and drillers time log shall be attached with this form. Submit CP-4 form with all plugged wells. Submit CP-111 form with all temporarily abandoned wells.

All requirements of the statutes, rules and regulations promulgated to regulate the oil and gas industry have

SIDE TWO

Operator Name L & L Enterprises, Inc. Lease Name Florence Gorrell Well #...7...

Sec. 7 Twp. 21S Rge. 22 East West County Linn

WELL LOG

INSTRUCTIONS: Show important tops and base of formations penetrated. Detail all cores. Report all drill stem tests giving interval tested, time tool open and closed, flowing and shut-in pressures, whether shut-in pressure reached static level, hydrostatic pressures, bottom hole temperature, fluid recovery, and flow rates if gas to surface during test. Attach extra sheet if more space is needed. Attach copy of log.

Drill Stem Tests Taken [] Yes [X] No
Samples Sent to Geological Survey [] Yes [X] No
Cores Taken [] Yes [X] No

Formation Description [X] Log [] Sample

Table with 3 columns: Name, Top, Bottom. Rows include B/Kc, Marm, Alt., Paw., Ft.S, Chero with corresponding depth values.

CASING RECORD [] New [X] Used

Report all strings set-conductor, surface, intermediate, production, etc.

Table with 8 columns: Purpose of String, Size Hole Drilled, Size Casing Set (in O.D.), Weight Lbs/Ft., Setting Depth, Type of Cement, #Sacks Used, Type and Percent Additives. Row 1: Surface, 8 3/4, 6 1/4, 14, 20', Portland, 4.

PERFORATION RECORD

Acid, Fracture, Shot, Cement Squeeze Record

Table with 4 columns: Shots Per Foot, Specify Footage of Each Interval Perforated, (Amount and Kind of Material Used), Depth.

TUBING RECORD Size Set At Packer at Liner Run [] Yes [] No

Date of First Production Producing Method [] Flowing [] Pumping [] Gas Lift [] Other (explain).....