

NE NE NE SW
KCC

S. 31 T. 21 R. 24 E
Loc. 165 SNL & 165 WEL SW/4
County Linn

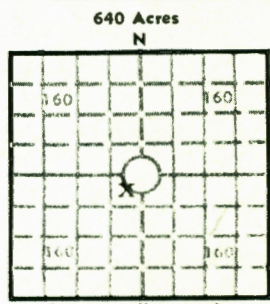

Elev.: Gr. 860
DF _____ KB _____

KANSAS DRILLERS Log State Geological Survey
WICHITA, BRANCH
API No. 15 — 107 — 20,549
County Number

Operator
Layton Oil Company

Address
Box 263, Independence, KS 67301

Well No. CTI-31 Lease Name Shinkle

Footage Location
165 feet from (N) line 165 feet from (E) line SW/4

Principal Contractor Layton Oil Company Geologist

Spud Date 8/5/75 Total Depth 882 P.B.T.D.

Date Completed 8/9/75 Oil Purchaser

CASING RECORD

Report of all strings set — surface, intermediate, production, etc.

Purpose of string	Size hole drilled	Size casing set (in O.D.)	Weight lbs/ft.	Setting depth	Type cement	Sacks	Type and percent additives
Surface	9"	7"		22	Mud Laden Fluid-Circulated		

LINER RECORD

PERFORATION RECORD

Top, ft.	Bottom, ft.	Sacks cement	Shots per ft.	Size & type	Depth interval

TUBING RECORD

Size	Setting depth	Packer set at

ACID, FRACTURE, SHOT, CEMENT SQUEEZE RECORD

Amount and kind of material used	Depth interval treated

INITIAL PRODUCTION

Date of first production Dry Producing method (flowing, pumping, gas lift, etc.)

RATE OF PRODUCTION PER 24 HOURS	Oil	Gas	Water	Gas-oil ratio
	bbis.	MCF	bbis.	CFPB

Disposition of gas (vented, used on lease or sold) Producing interval (s)

INSTRUCTIONS: As provided in KCC Rule 82-2-125, within 90 days after completion of a well, one completed copy of this Drillers Log shall be transmitted to the State Geological Survey of Kansas, 4150 Monroe Street, Wichita, Kansas 67209. Copies of this form are available from the Conservation Division, State Corporation Commission, 3830 So. Meridian (P.O. Box 17027), Wichita, Kansas 66217. Phone AC 316-522-2206. If confidential custody

31-21-24 E

for Layton Oil Company		DESIGNATE TYPE OF COMP.: OIL, GAS, DRY HOLE, SWDW, ETC.:
Well No. CTI-31	Lease Name Shinkle	Dry
S 31 T 21 R 24 E		

WELL LOG

Show all important zones of porosity and contents thereof; cored intervals, and all drill-stem tests, including depth interval tested, cushion used, time tool open, flowing and shut-in pressures, and recoveries.

SHOW GEOLOGICAL MARKERS, LOGS RUN,
OR OTHER DESCRIPTIVE INFORMATION.

FORMATION DESCRIPTION, CONTENTS, ETC.	TOP	BOTTOM	NAME	DEPTH
Top Soil	0	4		
Lime	4	5		
w/water sand & Shale	5	14		
Water Sand	14	16		
Shale	16	62		
Lime	62	73	11	
Shale	73	86		
Lime	86	90		
Black Shale	90	93		
Sdy Shale	93	118		
Black Shale	118	122		
Lime	122	146		
Black Shale	146	148		
Lime	148	152		
Sdy Shale	152	247		
Shale	247	267		
Lime	267	269		
Shale	269	278		
Sand	278	308		
Sdy Shale	308	344		
Sand & Shale	344	352		
Shale	352	378		
Sand	378	403		
Clay	403	404		
Sand & Shale	404	414		
Sdy Shale	414	436		
Lime	436	438		
Shale	438	452		
Sand & Shale	452	458		
Shale Shaly	458	458		
Sandy Shale	458	462		
Lime & Shale	462	465		
Lime	465	516		
Sand & Lime	516	525		

USE ADDITIONAL SHEETS, IF NECESSARY, TO COMPLETE WELL RECORD.

Date Received	Signature
	Engineer
	Title
	8/18/75
	Date

31-21-24C

Director

DESIGNATE TYPE OF COMP.: OIL, GAS,
DRY HOLE, SWDW, ETC.:

Layton Oil Company

Well No.

CTI-31

Lease Name

Shinkle

Dry

S31 T21 R24 E
97

WELL LOG

Show all important zones of porosity and contents thereof; cored intervals, and all drill-stem tests, including depth interval tested, cushion used, time tool open, flowing and shut-in pressures, and recoveries.

SHOW GEOLOGICAL MARKERS, LOGS RUN,
OR OTHER DESCRIPTIVE INFORMATION.

FORMATION DESCRIPTION, CONTENTS, ETC.	TOP	BOTTOM	NAME	DEPTH
Chat & Lime	525	555		
w/chert Sdy-Lime	555	588		
Lime	588	629		
w Sand/Lime	629	632		
Lime	632	669		
Dark Gray Lime	669	706		
Gray Lime	706	733		
Shale	733	737		
Chert Lime	737	785		
Gray Lime	785	882		
	TD	882		

USE ADDITIONAL SHEETS, IF NECESSARY, TO COMPLETE WELL RECORD.

Date Received

B. R. ...

Signature

Engineer

Title

8/18/75

Date