

KANSAS

**IMPORTANT**  
 Kans. Geo. Survey request  
 samples on this well.

**WELL COMPLETION REPORT AND  
DRILLER'S LOG**

API No. 15 — 107 County — 20,957 Number

Operator  
Protal Resources, Inc.

Address  
5600 N. E. Antioch Road Kansas City, Mo. 64119

Well No. 6-8 Lease Name  
#12-8 Carbon

Footage Location 170 1980  
feet from (N) (S) line feet from (E) (W) line

Principal Contractor McGown Drilling Geologist

Spud Date Jan. 20, 1981 Date Completed Jan. 21, 1981 Total Depth 501 P.B.T.D.

Directional Deviation None Oil and/or Gas Purchaser None

S. 8 T. 22 R. 24 <sup>E</sup>/<sub>W</sub>

Loc. 1980' EWL & 170' SNL

County Linn

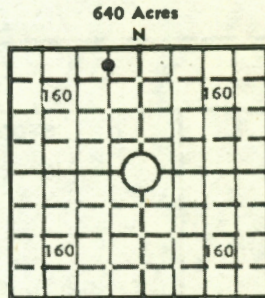

Locate well correctly

Elev.: Gr. N/A

DF KB

**CASING RECORD**

Report of all strings set — surface, intermediate, production, etc.

Purpose of string	Size hole drilled	Size casing set (in O.D.)	Weight lbs/ft.	Setting depth	Type cement	Sacks	Type and percent additives
Surface	8 5/8	7	23	70	Portland	12	
Production	6 1/8	4 1/2	10.5	495	Portland	60	

**LINER RECORD**

**PERFORATION RECORD**

Top, ft.	Bottom, ft.	Sacks cement	Shots per ft.	Size & type	Depth interval
			3	3 1/2 alum	447-452
			3	3 1/2 alum	454-460

**TUBING RECORD**

**ACID, FRACTURE, SHOT, CEMENT SQUEEZE RECORD**

Amount and kind of material used	Depth interval treated
4000 lbs. 20-40 sand	447-452 & 454-460
1000 lbs. 10-20 sand	
10 gal. L53WG clay control agent	130 barrels of water

**INITIAL PRODUCTION**

Date of first production <u>This well did not produce</u>	Producing method (flowing, pumping, gas lift, etc.)			
<b>RATE OF PRODUCTION PER 24 HOURS</b>	Oil	Gas	Water	Gas-oil ratio
	bbls.	MCF	bbls.	CFPB
Disposition of gas (vented, used on lease or sold)			Producing interval (s)	

INSTRUCTIONS: As provided in KCC Rule 82-2-125, within 90 days after completion of a well, one completed copy of this Drillers Log shall be transmitted to the State Geological Survey of Kansas, 4150 Monroe Street, Wichita, Kansas 67209. Copies of this form are available from the Conservation Division, State Corporation Commission, 245 No. Water, Wichita, Kansas 67202. Phone AC 316-522-2206. If confidential custody is desired, please note rule 82-2-125. Drillers Logs will be on an open file in the Oil and Gas Division, State Geological Survey of Kansas, Lawrence, Kansas 66044.

Well No. 6-8 Lease Name Carbon Oil

S 8 T 22 R 24 E W

**WELL LOG**

Show all important zones of porosity and contents thereof; cored intervals, and all drill-stem tests, including depth interval tested, cushion used, time tool open, flowing and shut-in pressures, and recoveries.

SHOW GEOLOGICAL MARKERS, LOGS RUN, OR OTHER DESCRIPTIVE INFORMATION.

FORMATION DESCRIPTION, CONTENTS, ETC.	TOP	BOTTOM	NAME	DEPTH
			Altamont	84
			Peru	104
			Ft. Scott	132
			U Squirrel	164
			L Squirrel	202
			Ardmore	330
			Bartlesville	392
			Burgess	444
			Mississippian	494

USE ADDITIONAL SHEETS, IF NECESSARY, TO COMPLETE WELL RECORD.

Date Received	Signature <i>Dr. Fetterly</i>
	Title <i>President</i>
	Date <i>April 2, 1981</i>