

KANSAS

**IMPORTANT**  
Kans. Geo. Survey request  
samples on this well.

**WELL COMPLETION REPORT AND  
DRILLER'S LOG**

11-22-24E  
State Geological Survey  
S. 11 T. 22 R. 24 E  
WICHITA, MISSOURI  
Loc. 2265' ~~N~~NL & 1635' ~~E~~FWL  
County Linn

API No. 15 — 107 County — 20,955 Number

Operator  
Protogal Resources, Inc.

Address  
5600 N. E. Antioch Road Kansas City, Mo. 64119

Well No. #27-11 Lease Name Troth

Footage Location  
2265 feet from (N) (S) line 1635 feet from (E) (W) line

Principal Contractor McGown Drilling Geologist

Spud Date Jan 15, 1981 Date Completed Jan 19, 1981 Total Depth 601 P.B.T.D.

Directional Deviation None Oil and/or Gas Purchaser None

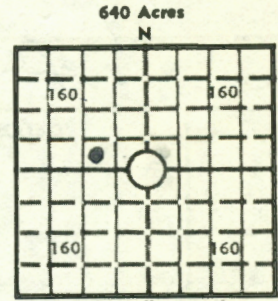

Locate well correctly  
Elev.: Gr. N/A  
DF \_\_\_\_\_ KB \_\_\_\_\_

**CASING RECORD**

Report of all strings set — surface, intermediate, production, etc.

Purpose of string	Size hole drilled	Size casing set (in O.D.)	Weight lbs/ft.	Setting depth	Type cement	Sacks	Type and percent additives
Surface	8 7/8	7	23	75	Portland	15	
Production	6 1/4	4 1/2	10.5	594	Portland	80	

**LINER RECORD**

**PERFORATION RECORD**

Top, ft.	Bottom, ft.	Sacks cement	Shots per ft.	Size & type	Depth interval
			3	3 1/2 alum	152-155
			3	3 1/2 alum	157-167

**TUBING RECORD**

**ACID, FRACTURE, SHOT, CEMENT SQUEEZE RECORD**

Amount and kind of material used	Depth interval treated
7000 lbs. 20-40 sand	152-155 & 157-167
10 gal. 253 WG Clay control agent	
164 Barrels of water	

**INITIAL PRODUCTION**

Date of first production	Producing method (flowing, pumping, gas lift, etc.)				
This well did not produce					
RATE OF PRODUCTION PER 24 HOURS	Oil	Gas	Water	Gas-oil ratio	
	bbls.	MCF	bbls.	CFPB	
Disposition of gas (vented, used on lease or sold)			Producing interval (s)		

INSTRUCTIONS: As provided in KCC Rule 82-2-125, within 90 days after completion of a well, one completed copy of this Drillers Log shall be transmitted to the State Geological Survey of Kansas, 4150 Monroe Street, Wichita, Kansas 67209. Copies of this form are available from the Conservation Division, State Corporation Commission, 245 No. Water, Wichita, Kansas 67202. Phone AC 316-522-2206. If confidential custody is desired, please note Rule 82-2-125. Drillers Logs will be on open file in the Oil and Gas Division, State Geological Survey of Kansas, Lawrence, Kansas 66044.

Operator

DESIGNATE TYPE OF COMP.: OIL, GAS, DRY HOLE, SWDW, ETC.:

Protaal Resources, Inc.

Well No.

Lease Name

27-11

Troth

Oil

S 11 T 22 R 24 W

WELL LOG

Show all important zones of porosity and contents thereof; cored intervals, and all drill-stem tests, including depth interval tested, cushion used, time tool open, flowing and shut-in pressures, and recoveries.

SHOW GEOLOGICAL MARKERS, LOGS RUN, OR OTHER DESCRIPTIVE INFORMATION.

FORMATION DESCRIPTION, CONTENTS, ETC.	TOP	BOTTOM	NAME	DEPTH
			Altamont	118
			Peru	154
			Ft. Scott	200
			Bartlesville	502
			Mississippian	584

USE ADDITIONAL SHEETS, IF NECESSARY, TO COMPLETE WELL RECORD.

Date Received

*Les Fetterly*

Signature

*President*

Title

*April 2, 1981*

Date

8EB1HS

1-59-9NR