

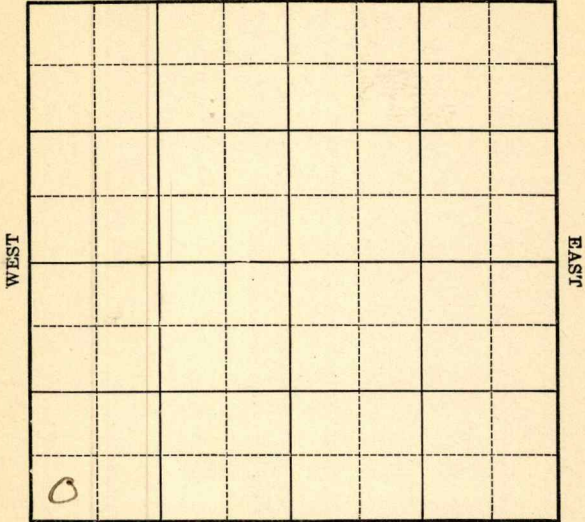

Map No. \_\_\_\_\_ Sec. 24 Twp. 22 R. 12  
 Well No. 5 - Tankhouse Farm  
Darby et al Company

NORTH



Location \_\_\_\_\_

Drilling Remarks \_\_\_\_\_

Rig Up \_\_\_\_\_

Drilling Remarks \_\_\_\_\_

RECORD

Cased \_\_\_\_\_ in. \_\_\_\_\_ ft.

Sand \_\_\_\_\_

Gas \_\_\_\_\_

Oil \_\_\_\_\_

Total Depth \_\_\_\_\_

PRODUCTION

1st 24 hrs. Nat. \_\_\_\_\_

1st 24 hrs. after shot \_\_\_\_\_

Gas \_\_\_\_\_ cu. ft.

Dry Hole \_\_\_\_\_

Abandoned \_\_\_\_\_



21 **KANSAS** *Sherwood*  
 Map No. \_\_\_\_\_ Sec. *24* Twp. *22* R. *12*  
 Well No. *5* *Fonshouser*  
*Darby et al* \_\_\_\_\_ Company  
 \_\_\_\_\_ Contractor

**FIRST REPORTS**

\_\_\_\_\_ Ft. from N. Line

*330* Ft. from S. Line

\_\_\_\_\_ Ft. from E. Line

*330* Ft. from W. Line

**SECTION PLAT**

|          |  |  |  |
|----------|--|--|--|
|          |  |  |  |
|          |  |  |  |
|          |  |  |  |
| <i>0</i> |  |  |  |

Location \_\_\_\_\_ ✓

Rig up \_\_\_\_\_

Drilling and Remarks:

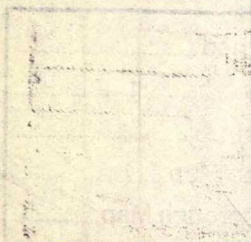

**RECORD**

Cased \_\_\_\_\_ in., \_\_\_\_\_ ft.

Sand \_\_\_\_\_

Gas \_\_\_\_\_

Oil \_\_\_\_\_

Total Depth \_\_\_\_\_

**PRODUCTION**

1st 24 hrs. Nat. \_\_\_\_\_

1st 24 hrs. after shot \_\_\_\_\_

Gas \_\_\_\_\_ Cu. Ft.

Dry Hole \_\_\_\_\_

Abandoned \_\_\_\_\_

Date

NOV 2 - 1927

**CHAS. L. SHERWOOD**

Scout

*Brownwood*

21 **KANSAS** Map No. Sec. *24* Twp. *22* R. *12*

Well No. *5* *Honshauer*

*Larky et al*

Company

Contractor

**COMPLETED**

**SECTION PLAT**

----- Ft. from N. Line

*330* Ft. from S. Line

----- Ft. from E. Line

*330* Ft. from W. Line

|          |  |  |  |
|----------|--|--|--|
|          |  |  |  |
|          |  |  |  |
|          |  |  |  |
|          |  |  |  |
| <i>0</i> |  |  |  |

Location -----

Rig up -----

Drilling and Remarks:

*Key 1610-56*

*200 / 250 lbs.*

**RECORD**

Cased ----- in., ----- ft.

Sand *1598-1666*

Gas -----

Oil -----

Total Depth *1666*

**PRODUCTION**

1st 24 hrs. Nat. -----

1st 24 hrs. after shot -----

Gas ----- Cu. Ft.

Dry Hole -----

Abandoned -----

Date

**NOV 30 1927 CHAS. L. SHERWOOD**

192

Scout