

DRILLING WELL COMPLETION REPORT

Well No. ONE (1) Farm Name P.D. FAIRHOUSER

Date drilling completed May 7, 1928

Description SW/4 Sec. 26-22S-12E

County Greenwood, State Kansas

Initial production Dry bbls. Total depth 1772 feet.

Initial volume _____ cu. ft. _____ lbs. rock pressure

Pipe Line Company _____

Gas Company _____

Remarks Well drilled by T.K. Simmons. See lease purchase agreement.

Well plugged and abandoned.

Tommy

Accounting Dept.

Rental Dept.

Scouting Dept. ✓

Engineering Dept.

Legal Dept.

Lease Inventory Man

Tax Dept.

Geological

File

LOCATION NOTICE

TULSA, OKLA., April 27, 1928 192

WELL NO. ONE (1) ON P.D. FANKHOUSER FARM

WILL BE AS FOLLOWS:

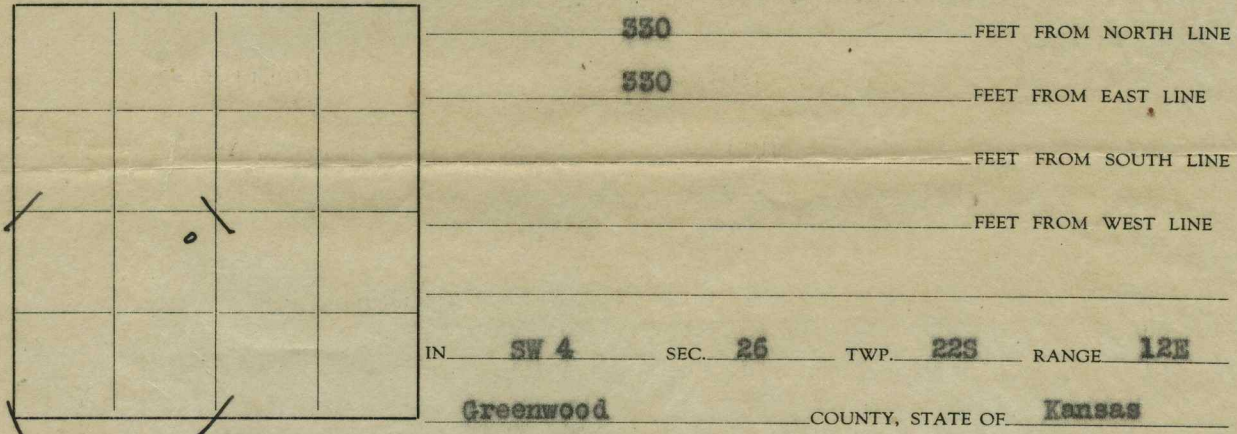

REMARKS: See contract with T.K. Simmons

COPIES TO _____ SIGNED Comody

- DISTRICT SUPT.
- ACCOUNTING DEPT.
- RENTAL DEPT.
- SCOUTING DEPT. ✓
- ENGINEERING DEPT.
- LEGAL DEPT.
- CLAIM DEPT.
- TAX DEPT.
- GEOLOGICAL DEPT.
- FILE