

**IMPORTANT**  
 Kans. Geo. Survey request  
 samples on this well.

SEP

**KANSAS DRILLERS LOG**

S. 31 T. 23 R. 22 E W  
 Loc. 165' FEL & 1660' FSL  
 County Bourbon

API No. 15 — 011 — 20,670  
 County Number

Operator  
Harold Erbert

Address  
422 West Austin Road Iola, Kansas 66749

Well No. #3 Lease Name  
Davis

Footage Location  
 feet from (N) (S) line feet from (E) (W) line

Principal Contractor Geologist

Spud Date Total Depth P.B.T.D.

Date Completed Oil Purchaser

JUL 8 0 1950  
 State Geological Survey  
 WICHITA BRANCH

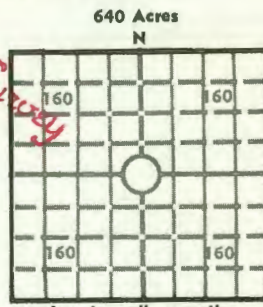

Elev.: Gr. \_\_\_\_\_  
 DF \_\_\_\_\_ KB \_\_\_\_\_

**CASING RECORD**

Report of all strings set — surface, intermediate, production, etc.

Purpose of string	Size hole drilled	Size casing set (in O.D.)	Weight lbs./ft.	Setting depth	Type cement	Sacks	Type and percent additives

**LINER RECORD**

**PERFORATION RECORD**

Top, ft.	Bottom, ft.	Sacks cement	Shots per ft.	Size & type	Depth interval

Size	Setting depth	Packer set at

**ACID, FRACTURE, SHOT, CEMENT SQUEEZE RECORD**

Amount and kind of material used	Depth interval treated

**INITIAL PRODUCTION**

Date of first production		Producing method (flowing, pumping, gas lift, etc.)			
RATE OF PRODUCTION PER 24 HOURS	Oil	Gas	Water	Gas-oil ratio	CFPB
	bbls.	MCF	bbls.		
Disposition of gas (vented, used on lease or sold)			Producing interval (s)		

**INSTRUCTIONS:** As provided in KCC Rule 82-2-125, within 90 days after completion of a well, one completed copy of this Drillers Log shall be transmitted to the State Geological Survey of Kansas, 4150 Monroe Street, Wichita, Kansas 67209. Copies of this form are available from the Conservation Division, State Corporation Commission, 3830 So. Meridian (P.O. Box 17027), Wichita, Kansas 66217. Phone AC 316-522-2206. If confidential custody is desired, please note Rule 82-2-125. Drillers Logs will be on open file in the Oil and Gas Division, State Geological Survey of Kansas, Lawrence, Kansas.

R/ 31-23-22e  
SEP

Erbert Oil Co.

Lease: Davis

Well Number: 3

Location: Bourbon Co., Kansas

Date Started: 2/25/80

Date Completed: 2/27/80

Drilling Log

Bottom of Formation		Thickness of Formation
2	soil	2
5	clay w/limestone	3
15	lime	10
19	red clay	4
122	lime w/shale streaks & shells	103
284	black shale w/lime streaks	162
304	brown lime w/shale streaks	20
370	grey muddy shale w/ lime streaks	66
402	lime w/shale streaks	32
443	shale w/lime shells	41
463	lime w/shale streaks	20
469	black shale or coal	6
475	lime	6
575	shale w/lime shells	100
584	lime w/shale shells	9
588	sand laminations in shale (oil show)	4
652	shale w/lime shells	64
669	sand w/oil show	17
697	shale/grey	28

Casing Record

set 21.50' of 6" surface pipe  
drilled from 21' to 697' with 4 3/4" bit  
cored from 652' to 688'  
set 681.28' of 2" with seating nipple at 656'