

WELL COMPLETION REPORT AND DRILLER'S LOG

API No. 15 — 011 — 20,658
County Number

Operator
Harold Erbert

Address 422 West Austin Road Iola, Ks. 66749

Well No. #1 Lease Name Lickteig

Footage Location
feet from (N) (S) line feet from (E) (W) line

Principal Contractor Geologist

Spud Date Date Completed Total Depth P.B.T.D.

Directional Deviation Oil and/or Gas Purchaser

KANSAS

State Geological Survey
WICHITA BRANCH
JUL 9 0 REC'D

P1

SEP

S. 32 T. 23 R. 22 E
Loc. 165' FWL & 1000' FSL SW
County Bourbon

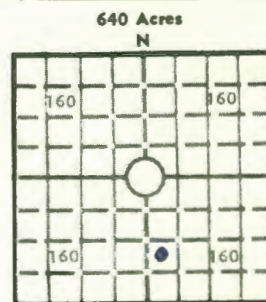

Locate well correctly

Elev.: Gr. _____

DF _____ KB _____

CASING RECORD

Report of all strings set — surface, intermediate, production, etc.

Purpose of string	Size hole drilled	Size casing set (in O.D.)	Weight lbs/ft.	Setting depth	Type cement	Sacks	Type and percent additives

LINER RECORD

PERFORATION RECORD

Top, ft.	Bottom, ft.	Sacks cement	Shots per ft.	Size & type	Depth interval

TUBING RECORD

Size	Setting depth	Packer set at

ACID, FRACTURE, SHOT, CEMENT SQUEEZE RECORD

Amount and kind of material used	Depth interval treated

INITIAL PRODUCTION

Date of first production Producing method (flowing, pumping, gas lift, etc.)

RATE OF PRODUCTION PER 24 HOURS	Oil bbls.	Gas MCF	Water bbls.	Gas-oil ratio CFPB
---------------------------------	-----------	---------	-------------	--------------------

Disposition of gas (vented, used on lease or sold) Producing interval (s)

INSTRUCTIONS: As provided in KCC Rule 82-2-125, within 90 days after completion of a well, one completed copy of this Drillers Log shall be transmitted to the State Geological Survey of Kansas, 4150 Monroe Street, Wichita, Kansas 67209. Copies of this form are available from the Conservation Division, State Corporation Commission, 245 No. Water, Wichita, Kansas 67202. Phone AC 316-522-2206. If confidential custody is desired, please note Rule 82-2-125. Return Log will be on file in the Oil and Gas Division, State Geological Survey of Kansas, Lawrence, Kansas 66044.

P1

Lease: LICKTEIG

Well Number: I

Location: Bourbon Co., Kansas

Date Started: 2/28/80

Date Completed: 3/1/80

Drilling Log

Bottom of Formation

Thickness of Formation

1	soil	1
4	clay w/lime shells	3
120	lime	116
284	shale w/lime shells	164
298	lime	14
369	shale	71
399	lime w/shale streaks	30
441	shale w/lime streaks	42
481	lime w/shale streaks	40
645	shale w/lime streaks	164
651	lime	6
669	sand w/shale streaks	18
761	shale w/black shale & lime streaks	92

Casing Record

set 10.50' of 6" surface pipe
drilled from 10' to 761' with 6 $\frac{1}{4}$ " bit
cored from 651' to 682'
set 703.66' of 2" with seating nipple at 653.48'