

Pr SEP

**IMPORTANT KANSAS**  
Kans. Geo. Survey request samples on this well.

# WELL COMPLETION REPORT AND DRILLER'S LOG

API No. 15 — 011 — 20,672  
County Number

S. 32 T. 23 R. 22 E W  
Loc. 165' FWL & 670' FSL SW  
County Bourbon

Operator  
Harold Erbert

Address  
422 West Austin Road Iola, Kansas 66749

Well No. #3 Lease Name Lickteig

Footage Location  
feet from (N) (S) line \_\_\_\_\_ feet from (E) (W) line \_\_\_\_\_

Principal Contractor \_\_\_\_\_ Geologist \_\_\_\_\_

Spud Date \_\_\_\_\_ Date Completed \_\_\_\_\_ Total Depth \_\_\_\_\_ P.B.T.D. \_\_\_\_\_

Directional Deviation \_\_\_\_\_ Oil and/or Gas Purchaser \_\_\_\_\_

*State Geological Survey*  
*WICHITA BRANCH*  
*JUL 9 0 RECD*

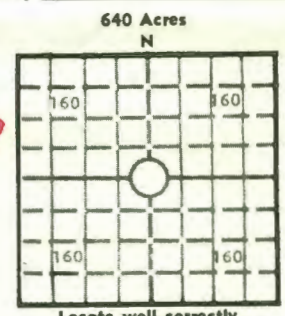

Locate well correctly  
Elev.: Gr. \_\_\_\_\_  
DF \_\_\_\_\_ KB \_\_\_\_\_

## CASING RECORD

Report of all strings set — surface, intermediate, production, etc.

Purpose of string	Size hole drilled	Size casing set (in O.D.)	Weight lbs/ft.	Setting depth	Type cement	Sacks	Type and percent additives

## LINER RECORD

## PERFORATION RECORD

Top, ft.	Bottom, ft.	Sacks cement	Shots per ft.	Size & type	Depth interval

## TUBING RECORD

Size	Setting depth	Packer set at

## ACID, FRACTURE, SHOT, CEMENT SQUEEZE RECORD

Amount and kind of material used	Depth interval treated

## INITIAL PRODUCTION

Date of first production \_\_\_\_\_ Producing method (flowing, pumping, gas lift, etc.) \_\_\_\_\_

RATE OF PRODUCTION PER 24 HOURS	Oil	Gas	Water	Gas-oil ratio
	bbls.	MCF	bbls.	CFPB
Disposition of gas (vented, used on lease or sold) _____			Producing interval (s) _____	

INSTRUCTIONS: As provided in KCC Rule 82-2-125, within 90 days after completion of a well, one completed copy of this Drillers Log shall be transmitted to the State Geological Survey of Kansas, 4150 Monroe Street, Wichita, Kansas 67209. Copies of this form are available from the Conservation Division, State Corporation Commission, 245 No. Water, Wichita, Kansas 67202. Phone AC 316-522-2206. If confidential custody is desired, please note

## Erbert Oil Co.

Lease: Licktieg

Well Number: 3

Location: Bourbon Co., Kansas

Date Started: 3/22/80

Date Completed: 3/26/80

## Drilling Log

Bottom of Formation		Thickness of Formation
1	soil	1
4	clay w/lime shells	3
24	lime w/clay & shale shells	21
120	lime w/black shale streaks & shells	96
285	shale w/lime shells	165
299	lime w/shale shells	14
370	shale w/lime shells	71
399	lime w/shale shells	29
442	shale w/lime shells	43
474	lime w/shale shells	32
646	shale w/lime shells	172
666	sand	20
672	sandy shale	6
679	black slate	7
814	sandy shale w/black shale & lime shells	135
818	lime & chert	4

## Casing Record

set 11' of surface pipe  
drilled from 11' to 120' with 5" bit  
drilled from 120' to 818' with 4 3/4" bit  
cored from 648' to 686'  
plugged with 10 sacks at 120' and 5 sacks at 25'  
well plugged 3/26/80