

29-23-10E

29 - 23 - 10

F. G. Thrall Well No. 20  
Greenwood County, Kansas

surface	5
lime	10
slate	35
lime	40
slate	145
lime	165
slate	365
lime	370
slate	380
lime	390
slate	450
lime	465
slate	545
lime	565
slate	605
lime	615
slate	685
lime	715
slate	775
lime	795
slate	825
lime	855
slate	920
lime	940
slate	990
lime	995
slate	1005
lime	1040
slate	1255
lime	1260
slate	1300
slate	1315
sand	1350
lime	1530
shale	1625
lime	1630
shale	1635
lime	1750
shale	1755
lime	1815
slate	1845
lime	1945
slate	2085
lime	2125
slate	2230
slate	2275
sand	2277
sand Bartlesville OIL	2360
shale	2365

Gift of  
W. L. Stryker Estate  
State Geological Survey of Kansas  
1970

Tubing:  
2" 2355'

Roth-Faurot & Mission Oil Co.

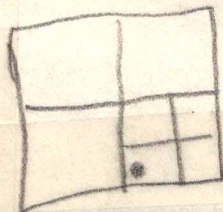

Casing Record:

12 1/2"	390'
10"	1255'
8 1/4"	1440'
6 5/8"	1944'
5 3/16"	2277'