

State Geological Survey

WICHITA BRANCH

KANSAS DRILLERS LOG

15-011-20504

API No. 15 — 011 — 20,309
 County Number

S. 6 T. 24 R. 22 ^E/_W
 Loc. 720' FNL & 2475' FWL

County Bourbon

Operator
Hillenburg Oil Company

Address
116th Street & South Lynn Lane Road Broken Arrow, Okla 74012

Well No. #2 Lease Name B. D. Foose

Footage Location
720 feet from (N) (S) line 2475 feet from (E) (W) line

Principal Contractor Hillenburg Oil Co. Geologist

Spud Date 5-9-77 Total Depth 721' P.B.T.D.

Date Completed 5-18-77 Oil Purchaser

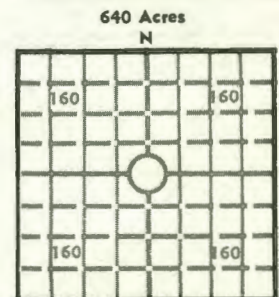

Elev.: Gr. _____

DF _____ KB _____

CASING RECORD

Report of all strings set — surface, intermediate, production, etc.

Purpose of string	Size hole drilled	Size casing set (in O.D.)	Weight lbs/ft.	Setting depth	Type cement	Sacks	Type and percent additives
Surface		7"		25'		5	
Production	6-1/4	4-1/2	9.5	710'	Bulk Portland	110	2 sx gel
							<i>oil Spud 648</i>

LINER RECORD

PERFORATION RECORD

Top, ft.	Bottom, ft.	Sacks cement	Shots per ft.	Size & type	Depth interval
			17 shots		654' to 662'

Size	Setting depth	Packer set at
2-3/8"	675'	

ACID, FRACTURE, SHOT, CEMENT SQUEEZE RECORD

Amount and kind of material used	Depth interval treated
Oil frac - 100 bbls oil, 20 sx 12-30 sand, 5 sx 10-20 sand, 1 drum acid	668'

INITIAL PRODUCTION

Date of first production 6-13-77 Producing method (flowing, pumping, gas lift, etc.) Pumping

RATE OF PRODUCTION PER 24 HOURS	Oil <u>6</u> bbls.	Gas _____ MCF	Water _____ bbls.	Gas-oil ratio _____ CFPB
---------------------------------	--------------------	---------------	-------------------	--------------------------

Disposition of gas (vented, used on lease or sold) _____ Producing interval (s) _____

INSTRUCTIONS: As provided in KCC Rule 82-2-125, within 90 days after completion of a well, one completed copy of this Drillers Log shall be transmitted to the State Geological Survey of Kansas, 4150 Monroe Street, Wichita, Kansas 67209. Copies of this form are available from the Conservation Division, State Corporation Commission, 3830 So. Meridian (P.O. Box 17027), Wichita, Kansas 66217. Phone AC 316-522-2206. If confidential custody is desired, please note Rule 82-2-125. Drillers Logs will be on open file in the Oil and Gas Division, State Geological Survey of Kansas, Lawrence, Kansas 66044.

Operator Hillenburg Oil Co. DESIGNATE TYPE OF COMP.: OIL, GAS, DRY HOLE, SWDW, ETC.:

Well No. 2 Lease Name B.D. Foose Oil

S 6 T24S R 22 E W

WELL LOG

Show all important zones of porosity and contents thereof; cored intervals, and all drill-stem tests, including depth interval tested, cushion used, time tool open, flowing and shut-in pressures, and recoveries.

SHOW GEOLOGICAL MARKERS, LOGS RUN, OR OTHER DESCRIPTIVE INFORMATION.

FORMATION DESCRIPTION, CONTENTS, ETC. TOP BOTTOM NAME DEPTH

Attached

USE ADDITIONAL SHEETS, IF NECESSARY, TO COMPLETE WELL RECORD.

Date Received

Danny Hillenburg Signature

Partner

Title

8-29-77

Date

6-24-22E



HILLENBURG OIL COMPANY
BROKEN ARROW, OKLAHOMA 74012



Foose Lease - Well #2

	From	To		From	To
Top soil & Clay	0'	3'	Sand	113'	117'
Lime	3'	5'	Sandy Lime	117'	121'
Clay	5'	6'	Sand	121'	127'
Lime	6'	8'	Sandy Shale	127'	134'
Shale	8'	10'	Sand	134'	135'
Lime	10'	20'	Shale	135'	229'
Sandy Lime	20'	44'	Sandy Shale	229'	234'
Shale	44'	48'	Shale	234'	267'
Black Shale	48'	50'	Green Shale	267'	271'
Brown Lime	50'	52'	Lime	271'	273'
Sandy Shale	52'	56'	Shale w/lime streaks	273'	291'
Sandy Lime	56'	58'	Lime	291'	297'
Shale	58'	62'	Shale	297'	330'
Sandy Lime	62'	68'	Sandy Shale	330'	370'
Brown Lime	68'	78'	Lime	370'	390'
Black Sand	78'	82'	Shale	390'	391'
Black Shale	82'	83'	Lime	391'	393'
Brown Lime	83'	89'	Shale	393'	396'
Grey Shale	89'	90'	Lime w/shale streaks	396'	400'
Brown Lime	90'	91'	Black Shale	400'	405'
Grey Shale	91'	92'	Grey Shale	405'	419'
Brown Lime	92'	98'	Lime	419'	421'
Sand	98'	99'	Sandy Grey Shale	421'	445'
Sandy Shale	99'	101'	Sandy Lime	445'	463'
Grey Shale	101'	102'	Sandy Shale	463'	468'
Brown Lime	102'	106'	Bl. Shale, lime streaks	468'	469'
Grey Shale	106'	107'	Grey Sandy Shale	469'	470'
Sandy Lime	107'	113'	Lime	470'	475'

6-24-22E



HILLENBURG OIL COMPANY
BROKEN ARROW, OKLAHOMA 74012



Foose #2 Cont'd

	From	To	
Shale	475'	615'	
Lime Streak	615'	625'	
Sandy Shale	625'	645'	
Shale	645'	648'	
Oil Sand	648'	656'	
Sand & SHale	656'	676'	
Sandy Shale	676'	706'	
Shale	706'	721'	TD