

15-011-20295

State Geological Survey

KANSAS DRILLERS LOG

API No. 15 — 011 — 20295
 County Number

Operator
 Gator Oil Co.

Address
 Box 1628 Lake Worth, Florida 33460

Well No. 7 Lease Name Nelson

Footage Location
 feet from (N) (S) line feet from (E) (W) line

Principal Contractor Nance Drilling Co. Geologist Jay Robertson

Spud Date 1-27-77 Total Depth 605' P.B.T.D.

Date Completed 2-1-77 Oil Purchaser

S. 12 T. 24 R. 22 E
 Loc. C NW SW
 County Bourbon

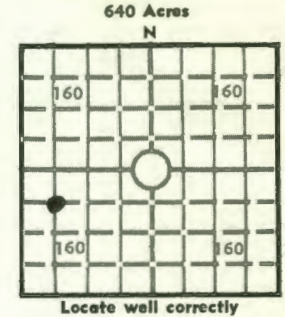

Elev.: Gr. _____
 DF _____ KB _____

CASING RECORD

Report of all strings set — surface, intermediate, production, etc.

Purpose of string	Size hole drilled	Size casing set (in O.D.)	Weight lbs/ft.	Setting depth	Type cement	Sacks	Type and percent additives
Overburden	9"	6 5/8" 80.D.	13	50'			
Production	6 1/8	2 7/8	6.4	602		50	

LINER RECORD

PERFORATION RECORD

Top, ft.	Bottom, ft.	Sacks cement	Shots per ft.	Size & type	Depth interval
			1		570-86

TUBING RECORD

Size	Setting depth	Packer set at

ACID, FRACTURE, SHOT, CEMENT SQUEEZE RECORD

Amount and kind of material used	Depth interval treated
500 Gallons Acid	570-86

INITIAL PRODUCTION

Date of first production		Producing method (flowing, pumping, gas lift, etc.)			
RATE OF PRODUCTION PER 24 HOURS	Oil bbls.	Gas MCF	Water bbls.	Gas-oil ratio CFPB	
Disposition of gas (vented, used on lease or sold)			Producing interval (s)		

INSTRUCTIONS: As provided in KCC Rule 82-2-125, within 90 days after completion of a well, one completed copy of this Drillers Log shall be transmitted to the State Geological Survey of Kansas, 4150 Monroe Street, Wichita, Kansas 67209. Copies of this form are available from the Conservation Division, State Corporation Commission, 3830 So. Meridian (P.O. Box 17027), Wichita, Kansas 66217. Phone AC 316-522-2206. If confidential custody is desired, please note Rule 82-2-125. Drillers Logs will be on open file in the Oil and Gas Division, State Geological Survey of Kansas, Lawrence, Kansas 66044.

Operator **Gator Oil Co.** DESIGNATE TYPE OF COMP.: OIL, GAS, DRY HOLE, SWDW, ETC.: **GAS**

Well No. **7** Lease Name **Nelson**

S 12 T 24 R 22 **E**

WELL LOG

Show all important zones of porosity and contents thereof; cored intervals, and all drill-stem tests, including depth interval tested, cushion used, time tool open, flowing and shut-in pressures, and recoveries.

SHOW GEOLOGICAL MARKERS, LOGS RUN, OR OTHER DESCRIPTIVE INFORMATION.

FORMATION DESCRIPTION, CONTENTS, ETC.	TOP	BOTTOM	NAME	DEPTH
Overburden	0	12		
Grey Shale	12	45		
Grey Shale	45	60		
Grey Shale	60	125		
Brown Lime	125	145		
Black Shale	145	148		
Brown Lime	148	155		
Black Shale	155	160		
Grey Shale	160	199		
Brown Lime	199	215		
Grey Shale	215	220		
Brown Lime	220	235		
Grey Shale	235	250		
Grey Shale	250	300		
Black Shale	300	320		
Grey Shale	320	395		
Grey Shale	395	423		
Dark Grey Shale	423	550		
Black Shale	550	569		
		569	Top Of Miss.	
Brown Lime	569	605		
		605	T.D.	

USE ADDITIONAL SHEETS, IF NECESSARY, TO COMPLETE WELL RECORD.

Date Received	<i>[Signature]</i>
	Vice President
	6-28-77

6619ES