

State Geological Survey

15-011-20375

WICHITA BRANCH KANSAS DRILLERS LOG

S. 6 T. 24 R. 24 ^E_W

Loc. 91 FEL & 345' FSL SE NE NW

County Bourbon

API No. 15 — 011 — 20,375
County Number

Operator
AMM, Inc.

Address
Route #2, Box 46A Mapleton, Kansas 66754

Well No. #AM-6 Lease Name R & V Feagins

Footage Location
345 feet from (N) (S) line 99 feet from (E) (W) line

Principal Contractor Van Michael Geologist -

Spud Date 12/24/77 Total Depth 166' P.B.T.D. -

Date Completed 12/24/77 Oil Purchaser -

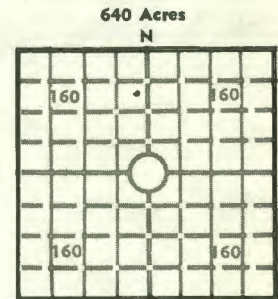

Elev.: Gr. +857

DF - KB -

CASING RECORD

Report of all strings set — surface, intermediate, production, etc.

Purpose of string	Size hole drilled	Size casing set (in O.D.)	Weight lbs/ft.	Setting depth	Type cement	Sacks	Type and percent additives
Surface	8 1/4	7"	16#	25'	Portland	3	None
Production	5 1/4	2"	3.4	143'	Portland	10	None

LINER RECORD

Top, ft.	Bottom, ft.	Sacks cement
-	-	-

PERFORATION RECORD

Shots per ft.	Size & type	Depth interval
-	-	-

TUBING RECORD

Size	Setting depth	Packer set at
-	-	-

ACID, FRACTURE, SHOT, CEMENT SQUEEZE RECORD

Amount and kind of material used	Depth interval treated
Suspended awaiting final completion 3/1/77	

INITIAL PRODUCTION

Date of first production <u>12/30/77</u>		Producing method (flowing, pumping, gas lift, etc.) <u>Build up in 2"</u>			
RATE OF PRODUCTION PER 24 HOURS	Oil <u>0.5</u> bbls.	Gas <u>-</u> MCF	Water <u>-</u> bbls.	Gas-oil ratio <u>-</u>	CFPB <u>-</u>
Disposition of gas (vented, used on lease or sold) <u>vented</u>			Producing interval (s) <u>140 - T D</u>		

INSTRUCTIONS: As provided in KCC Rule 82-2-125, within 90 days after completion of a well, one completed copy of this Drillers Log shall be transmitted to the State Geological Survey of Kansas, 4150 Monroe Street, Wichita, Kansas 67209. Copies of this form are available from the Conservation Division, State Corporation Commission, 3830 So. Meridian (P.O. Box 17027), Wichita, Kansas 66217. Phone AC 316-522-2206. If confidential custody is desired, please note Rule 82-2-125. Drillers Logs will be on open file in the Oil and Gas Division, State Geological Survey of Kansas, Lawrence, Kansas 66044.

Operator **AMM, INC.** DESIGNATE TYPE OF COMP.: OIL, GAS, DRY HOLE, SWDW, ETC.:

Well No. **AM - 6** Lease Name **R. & V. Feagins** **011**

S 6 T 24 R 24 E

WELL LOG

Show all important zones of porosity and contents thereof; cored intervals, and all drill-stem tests, including depth interval tested, cushion used, time tool open, flowing and shut-in pressures, and recoveries.

SHOW GEOLOGICAL MARKERS, LOGS RUN, OR OTHER DESCRIPTIVE INFORMATION.

FORMATION DESCRIPTION, CONTENTS, ETC.	TOP	BOTTOM	NAME	DEPTH
Soil	0	3		
Clay	3	7		
Shale	7	28		
Coal	28	30		
Shale	30	41		
Lime	41	553		
Shale	53	55		
Lime	55	62		
Slate	62	64		
Shale	64	91		
Lime	91	94		
Shale	94	102		
Slate	102	103		
Shale	103	104		
Lime	104	119		
Shale	119	135		
Shaley sand	135	141		
Sand & Shale	141	162		
Shale	162	166		

USE ADDITIONAL SHEETS, IF NECESSARY, TO COMPLETE WELL RECORD.

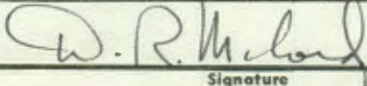
Date Received	 Signature D. R. McCord
	Title Vice President
	Date March 1, 1978
	Date

97L9ES