

**KANSAS DRILLERS LOG**

S. 16 T. 26S R. 2E <sup>E</sup>/<sub>WX</sub>  
 Loc. SW. NE. NW.  
 County Sedgwick

API No. 15 —                      County                      Number                     

Operator Petroleum, Inc.

Address 800 R.H. Garvey Bldg., 300 W. Douglas, Wichita, Ks 67206

Well No. 1 Lease Name Builders, Inc.

Footage Location 990' feet from (N) ~~XX~~ line 1650 feet from ~~XX~~ (W) line

Principal Contractor Brandt Drlg. Co., Inc. Geologist Kenneth Johnson

Spud Date 3-12-77 Total Depth 2961' P.B.T.D.                     

Date Completed 3-21-77 Oil Purchaser                     

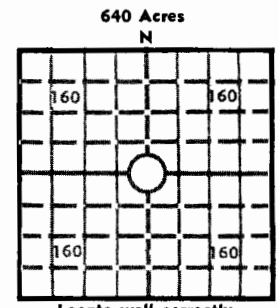

Locate well correctly  
 Elev.: Gr. 1377  
 DF 1379 KB 1382

**CASING RECORD**

Report of all strings set — surface, intermediate, production, etc.

Purpose of string	Size hole drilled	Size casing set (in O.D.)	Weight lbs/ft.	Setting depth	Type cement	Sacks	Type and percent additives
Surface	12 1/2"	8 5/8	20#	225'	Common	150	3% gel.

**LINER RECORD**

**PERFORATION RECORD**

Top, ft.	Bottom, ft.	Sacks cement	Shots per ft.	Size & type	Depth interval

**TUBING RECORD**

Size	Setting depth	Packer set at

**ACID, FRACTURE, SHOT, CEMENT SQUEEZE RECORD**

Amount and kind of material used	Depth interval treated

**INITIAL PRODUCTION**

Date of first production <u>                    </u>		Producing method (flowing, pumping, gas lift, etc.) <u>                    </u>			
RATE OF PRODUCTION PER 24 HOURS	Oil <u>                    </u> bbls.	Gas <u>                    </u> MCF	Water <u>                    </u> bbls.	Gas-oil ratio <u>                    </u>	CFPB <u>                    </u>
Disposition of gas (vented, used on lease or sold) <u>                    </u>			Producing interval (s) <u>                    </u>		

INSTRUCTIONS: As provided in KCC Rule 82-2-125, within 90 days after completion of a well, one completed copy of this Drillers Log shall be transmitted to the State Geological Survey of Kansas, 4150 Monroe Street, Wichita, Kansas 67209. Copies of this form are available from the Conservation Division, State Corporation Commission, 3830 So. Meridian (P.O. Box 17027), Wichita, Kansas 66217. Phone AC 316-522-2206. If confidential custody is desired, please note Rule 82-2-125. Drillers Logs will be on open file in the Oil and Gas Division, State Geological Survey of Kansas, Lawrence, Kansas 66044.

Operator Petroleum, Inc. DESIGNATE TYPE OF COMP.: OIL, GAS, DRY HOLE, SWDW, ETC.:

Well No. 1 Lease Name Builders, Inc. Dry

S 16 T 16SR 2 <sup>E</sup><sub>XW</sub>

**WELL LOG**

Show all important zones of porosity and contents thereof; cored intervals, and all drill-stem tests, including depth interval tested, cushion used, time tool open, flowing and shut-in pressures, and recoveries. SHOW GEOLOGICAL MARKERS, LOGS RUN, OR OTHER DESCRIPTIVE INFORMATION.

FORMATION DESCRIPTION, CONTENTS, ETC.	TOP	BOTTOM	NAME	DEPTH
DST #1 2875-2912 Misrun.			E.L. TOPS	
DST #2 2870-2912 Op. 30', Wk blow for 15 min. SI 60', 2nd Open no blow. Rec. 30' mud. FF 39-39#, ISIP 822#			K.C. 2456 B/K.C. 2623 Marm. 2687 Cong.Sd. 2898 Miss. 2914 LTD 2952	(-1074) (-1241) (-1305) (-1516) (-1532)

USE ADDITIONAL SHEETS, IF NECESSARY, TO COMPLETE WELL RECORD.

Date Received	<div style="font-family: cursive; font-size: 1.5em; margin-bottom: 5px;">J. Sentes</div> <hr/> <div style="font-size: 0.8em; margin-bottom: 5px;">Signature</div> <hr/> <div style="margin-bottom: 5px;">District Geologist</div> <hr/> <div style="font-size: 0.8em; margin-bottom: 5px;">Title</div> <hr/> <div style="margin-bottom: 5px;">4-11-77</div> <hr/> <div style="font-size: 0.8em; margin-bottom: 5px;">Date</div>
---------------	---

119471

10-90-95