

15-26-285 

SIDE ONE

STATE CORPORATION COMMISSION OF KANSAS  
OIL & GAS CONSERVATION DIVISION

WELL COMPLETION OR RECOMPLETION FORM  
ACO-1 WELL HISTORY

DESCRIPTION OF WELL AND LEASE

Operator: License # 7097  
Name American Shallow Development  
Address 7633 E. 63rd Pl., Suite 420  
Tulsa, OK 74133  
City/State/Zip

Purchaser n/a

Operator Contact Person Byron E. Brown  
Phone 918/252-9541

Contractor: License # 5831  
Name Mokat Drilling Company

Wellsite Geologist n/a  
Phone

Designate Type of Completion

- New Well
- Re-Entry
- Workover
- Oil
- Gas
- Dry-Plugged
- SWD
- Inj
- Other (Core, Water Supply etc.)
- Temp Abd
- Delayed Comp.

If OWWO: old well info as follows:

Operator  
Well Name  
Comp. Date Old Total Depth

WELL HISTORY

Drilling Method:

- Mud Rotary
- Air Rotary
- Cable

11/14/83	11/14/83	4/22/85
.....	.....	.....
Spud Date	Date Reached TD	Completion Date
336'		
.....		
Total Depth	PBDT	

Amount of Surface Pipe Set and Cemented at 20 feet  
 Multiple Stage Cementing Collar Used?  Yes  No  
 If yes, show depth set.....feet  
 If alternate 2 completion, cement circulated  
 from 20 feet depth to surface, 10 SX cmt

API NO. 15-011-22,091

County Bourbon

C E/2 SW Sec. 15 Twp. 26S Rge. 23  East  West

1320 Ft North from Southeast Corner of Section  
3300 Ft West from Southeast Corner of Section

(Note: Locate well in section plat below)

Lease Name Griffith Well # 34

Field Name n/a

Producing Formation

Elevation: Ground KB

Section Plat

JUN 26 1985  
 State Geological Survey  
 WICHITA BRANCH  
 JUN 25 1985  
 STATE CORPORATION COMMISSION  
 Conservation Division  
 Wichita Kansas

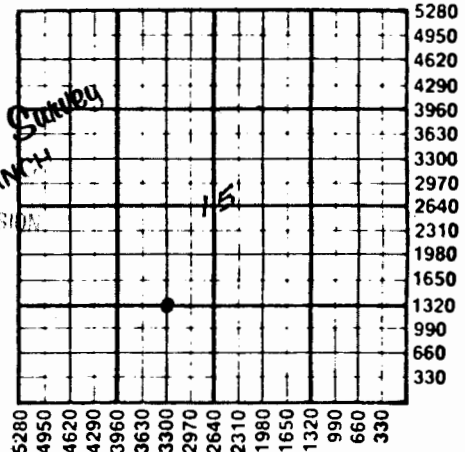

WATER SUPPLY INFORMATION

Disposition of Produced Water:  Disposal  Repressuring  
Docket #

Questions on this portion of the ACO-1 call:  
Water Resources Board (913) 296-3717

Source of Water:  
Division of Water Resources Permit #

Groundwater.....Ft North from Southeast Corner (Well) .....Ft West from Southeast Corner of Sec Twp Rge  East  West

Surface Water.....Ft North from Southeast Corner (Stream, pond etc).....Ft West from Southeast Corner Sec Twp Rge  East  West

Other (explain)..... (purchased from city, R.W.D. #)

INSTRUCTIONS: This form shall be completed in duplicate and filed with the Kansas Corporation Commission, 200 Colorado Derby Building, Wichita, Kansas 67202, within 90 days after completion or recompletion of any well. Rule 82-3-130 and 82-3-107 apply.  
 Information on side two of this form will be held confidential for a period of 12 months if requested  
 submitted with the form. See rule 82-3-107 for confidentiality in excess of 12 months.

386-26-21

SIDE TWO

Operator Name American Shallow Development Lease Name Griffith Well # 34

Sec. 15 Twp. 26S Rge. 23  East  West County Bourbon

WELL LOG

INSTRUCTIONS: Show important tops and base of formations penetrated. Detail all cores. Report all drill stem tests giving interval tested, time tool open and closed, flowing and shut-in pressures, whether shut-in pressure reached static level, hydrostatic pressures, bottom hole temperature, fluid recovery, and flow rates if gas to surface during test. Attach extra sheet if more space is needed. Attach copy of log.

Drill Stem Tests Taken  Yes  No  
 Samples Sent to Geological Survey  Yes  No  
 Cores Taken  Yes  No

Formation Description  
 Log  Sample

	Top	Bottom
Soil	0	4
Lime	4	35
Shale	35	70
Sandy Shale	70	78
Shale	78	86
Lime	86	104
Shale	104	110
Lime	110	117
Shale	117	119
Coal	119	120
Shale	120	123
Sand	123	125
Sandy Shale	125	137
Shale	137	155
Sand	155	160
Sandy Shale	160	207

Name	Top	Bottom
Coal	207	209
Shale	209	230
Lime	230	232
Shale	232	250
Sandy Shale	250	254
Sand (odor 257)	254	269
Shale	269	279
Shale	279	281
Sand	281	284
Shale	284	336

CASING RECORD <input checked="" type="checkbox"/> New <input type="checkbox"/> Used							
Report all strings set-conductor, surface, intermediate, production, etc.							
Purpose of String	Size Hole Drilled	Size Casing Set (in O.D.)	Weight Lbs/Ft.	Setting Depth	Type of Cement	#Sacks Used	Type and Percent Additives
Surface	6 1/2"	7"	17#	20'	Portland	10	Calc. Chlor.
PERFORATION RECORD				Acid, Fracture, Shot, Cement Squeeze Record			
Shots Per Foot	Specify Footage of Each Interval Perforated			(Amount and Kind of Material Used)			Depth
TUBING RECORD				Liner Run <input type="checkbox"/> Yes <input type="checkbox"/> No			
Size	Set At	Packer at					