

5-26-3E *Sub*

STATE CORPORATION COMMISSION OF KANSAS
OIL & GAS CONSERVATION DIVISION
WELL COMPLETION OR RECOMPLETION FORM
ACO-1 WELL HISTORY
DESCRIPTION OF WELL AND LEASE

Operator: License # 5215
Name Lee Phillips Oil Company
Address 125 No. Market, Suite 1532
Wichita, KS 67202
City/State/Zip

Purchaser.....

Operator Contact Person Lee E. Phillips III
Phone 316 264-6392

Contractor: License # 5892
Name Berentz Drilling Company, Inc.

Wellsite Geologist Harold Trapp
Phone (316) 262-7111

Designate Type of Completion
New Well Re-Entry Workover

Oil SWD Temp Abd
 Gas Inj Delayed Op
 Dry Other (Core, Water Supply etc.)

If OWD: old well info as follows:
Operator Oil Property Management
Well Name Cunningham #1
Comp. Date 12-7-67 Old Total Depth 2813

WELL HISTORY

Drilling Method:
 Mud Rotary Air Rotary Cable
8-23-88 8-28-88 8-28-88
Spud Date Date Reached TD Completion Date
3290
Total Depth PBTD

Amount of Surface Pipe Set and Cemented at 213 feet
Multiple Stage Cementing Collar Used? Yes No
If yes, show depth set.....feet
If alternate 2 completion, cement circulated from.....feet depth to.....w/.....SX cmt
Cement Company Name

API NO. 15-015-20,096-A000 DRL 2-7-08

County Butler

SE SW NW Sec 5 26 3 East

2970
4290
Ft North from Southeast Corner of Section
Ft West from Southeast Corner of Section
(Note: Locate well in section plat below)

Cunningham
Lease Name.....Well # 1

Field Name.....

Producing Formation.....

Elevation: Ground 1328 1331 KB.....

Section Plat

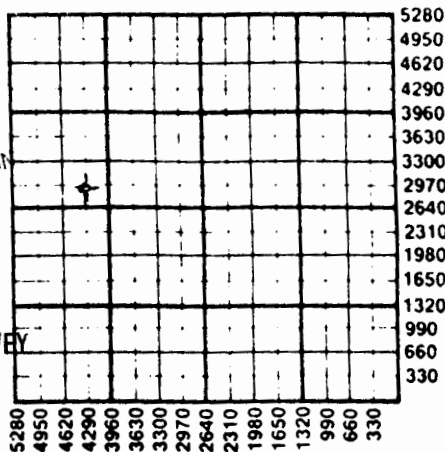

RECEIVED
STATE CORPORATION COMMISSION

OCT 4 1988

CONSERVATION DIVISION
Wichita Kansas

KANSAS GEOLOGICAL SURVEY
WICHITA BRANCH

OCT 07 1988

WATER SUPPLY INFORMATION

Disposition of Produced Water: Disposal
Docket # Repressuring

Questions on this portion of the ACO-1 call:

Water Resources Board (913) 296-3717

Source of Water:
Division of Water Resources Permit #.....

Groundwater.....Ft North from Southeast Corner
(Well)Ft West from Southeast Corner of
Sec Twp Rge East West

Surface Water.....Ft North from Southeast Corner
(Stream, pond etc).....Ft West from Southeast Corner
Sec Twp Rge East West

Other (explain).....
(purchased from city, R.W.D. #)

INSTRUCTIONS: This form shall be completed in triplicate and filed with the Kansas Corporation Commission, 200 Colorado Derby Building, Wichita, Kansas 67202, within 120 days of the spud date of any well. Rule 82-3-130, 82-3-107 and 82-3-106 apply. Information on side two of this form will be held confidential for a period of 12 months if requested in writing and submitted with the form. See rule 82-3-107 for confidentiality in excess of 12 months. One copy of all wireline logs and drillers time log shall be attached with this form. Submit CP-4 form with all plugged wells. Submit CP-111 form with all temporarily abandoned wells.

All requirements of the statutes, rules and regulations promulgated to regulate the oil and gas industry have been fully complied with and the statements herein are complete and correct to the best of my knowledge.

Signature *Alice M. Oaks*

Title Owner Date 9-15-88

Subscribed and sworn to before me this 15 day of September

19..... Notary Public *Alice M. Oaks*

Date Commission Expires May 10, 1992



K.C.C. OFFICE USE ONLY
F Letter of Confidentiality Attached
C Wireline Log Received
C Drillers Timelog Received
Distribution
KCC SWD/Rep NGPA
KGS Plug Other (Specify)

Sec. 5 Twp. 26 Range 3 E

