

WICHITA BRANCH

KANSAS DRILLERS LOG

S. 30 T. 27 R. 22 E W

Loc. SE NE

County Crawford

API No. 15 — 037 — 20,266
County Number

Operator
George A. Hoffman

Address
P. O. Box 483 Chanute, Kansas 66720

Well No. #H-1A Lease Name Albert Elmer

Footage Location
350 feet from (N) (S) line 500 feet from (E) (W) line of Sec.

Principal Contractor Way Drilling Co. Geologist Harold Krueger

Spud Date April 7, 1977 Total Depth 597' P.B.T.D.

Date Completed April 9, 1977 Oil Purchaser Mid-America

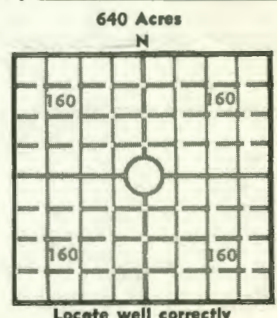

Elev.: Gr. _____
DF _____ KB _____

CASING RECORD

Report of all strings set — surface, intermediate, production, etc.

Purpose of string	Size hole drilled	Size casing set (in O.D.)	Weight lbs/ft.	Setting depth	Type cement	Sacks	Type and percent additives
Surface		6 1/4		30'			
Casing	5 1/4	2"		598'	Portland	85	

LINER RECORD

PERFORATION RECORD

Top, ft.	Bottom, ft.	Sacks cement	Shots per ft.	Size & type	Depth interval
			10 holes	580-589 with 2 1/8 glass jets	
			13 holes from 566-578		
Size 1"	Setting depth 570'	Packer set at			

ACID, FRACTURE, SHOT, CEMENT SQUEEZE RECORD

Amount and kind of material used	Depth interval treated
25 bags Sand with gelled water	588-598 580-596

INITIAL PRODUCTION

Date of first production April 27, 1977	Producing method (flowing, pumping, gas lift, etc.) Pumping
RATE OF PRODUCTION PER 24 HOURS Oil 2 1/2 bbls.	Gas _____ MCF Water 1/2 bbls.
Disposition of gas (vented, used on lease or sold)	Gas-oil ratio _____ CFPB Producing interval (s) 566-678 580-589

INSTRUCTIONS: As provided in KCC Rule 82-2-125, within 90 days after completion of a well, one completed copy of this Drillers Log shall be transmitted to the State Geological Survey of Kansas, 4150 Monroe Street, Wichita, Kansas 67209. Copies of this form are available from the Conservation Division, State Corporation Commission, 3830 So. Meridian (P.O. Box 17027), Wichita, Kansas 66217. Phone AC 316-522-2206. If confidential custody is desired, please note Rule 82-2-125. Drillers Logs will be on open file in the Oil and Gas Division, State Geological Survey of Kansas, Lawrence, Kansas 66044.

Operator **Geo. A. Hoffman** DESIGNATE TYPE OF COMP.: OIL, GAS, DRY HOLE, SWDW, ETC.: **oil**

Well No. **H-1A** Lease Name **Albert Elmer**

S ___ T ___ R ___ E ___ W

WELL LOG

Show all important zones of porosity and contents thereof; cored intervals, and all drill-stem tests, including depth interval tested, cushion used, time tool open, flowing and shut-in pressures, and recoveries.

SHOW GEOLOGICAL MARKERS, LOGS RUN, OR OTHER DESCRIPTIVE INFORMATION.

FORMATION DESCRIPTION, CONTENTS, ETC.	TOP	BOTTOM	NAME	DEPTH
Soil & Rock	0	1		
Clay	1	5		
Lime	5	6		
Sandstone	6	26		
Shale	26	52		
Lime	52	59		
Slate	59	60		
Lime	60	71		
Shale	71	72		
Sand	72	110		
Shale	110	120		
Sand	120	124		
Shale	124	130		
Lime	130	137		
Coal	137	138		
Shale	138	139		
Lime	139	181		
Slate	181	182		
Shale	182	207		
Shale Lt.	207	224		
Shale, Dk.	224	234		
Lime	234	254		
Slate	254	260		
Lime	260	266		
Slate	266	270		
Shale	270	274		
Sand	274	278		
Shale	278	347		
Shale, Dk.	347	390		
Lime	390	391		
Slate	391	395		
Shale Dk W/Lm.	395	414		
Shale	414	417		
Coal	417	419		
Shale	419	424		
Slate	424	427		
Shale	427	479		
Slate	479	485		
Shale	485	547		
Sand	547	549		
XXXX				

USE ADDITIONAL SHEETS, IF NECESSARY, TO COMPLETE WELL RECORD.

Date Received	<i>Geo. A. Hoffman</i>
	Signature
	Owner-Operator
	Title
	<i>May 23, 1977</i>
	Date

H-1A Albert Elmer (Farm)
Geo. A. Hoffman (Operator)
30-27-19E

Shale	549	580
Sand OIL	580	584
Shale	584	596
Coal	596	597
TOTAL DEPTH	597'	