

KANSAS

WELL COMPLETION REPORT AND DRILLER'S LOG

WICHITA BRANCH State Geology

P1 Jul SEP

S. 33 T. 27S R. 22 E
Loc. 700' SL 1100' WL of SW/
County Crawford

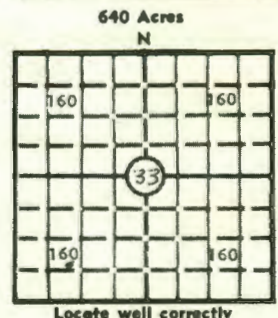

Elev.: Gr. _____
DF _____ KB _____

API No. 15 — 037 — 20,269
County Number

Operator
L & L Oil Company

Address
P.O. Box 13, Benedict, KS 66714

Well No. #7 Lease Name Brodbeck

Footage Location
700' feet from (S) line 1100' feet from (W) line SW/4

Principal Contractor L & L Oil Co. Geologist L. Lamb

Spud Date 4-28-77 Date Completed 8-16-77 Total Depth 610 P.B.T.D.

Directional Deviation Oil and/or Gas Purchaser Square Deal Oil Co.

CASING RECORD

Report of all strings set — surface, intermediate, production, etc.

Purpose of string	Size hole drilled	Size casing set (in O.D.)	Weight lbs./ft.	Setting depth	Type cement	Sacks	Type and percent additives
Surface	9 5/8"	7"		30'	Portland A	11	
Production	6 1/2"	2 7/8"		595'	Portland A	68	

LINER RECORD

PERFORATION RECORD

Top, ft.	Bottom, ft.	Sacks cement	Shots per ft.	Size & type	Depth interval
				Open Hole	

TUBING RECORD

Size	Setting depth	Packer set at
1"	600'	

ACID, FRACTURE, SHOT, CEMENT SQUEEZE RECORD

Amount and kind of material used	Depth interval treated
Fracture - 10,000 lbs of sand, 250 bbl gelled water	595 - 608

RECEIVED STATE CORPORATION COMMISSION

JUL 16 1977

INITIAL PRODUCTION

Date of first production Sept. 10, 1977 Producing method (flowing, pumping, gas lift, etc.) Pumping

CONSERVATION DIVISION Wichita, Kansas

RATE OF PRODUCTION PER 24 HOURS Oil 5 bbls. Gas Water 2 bbls. Gas:oil ratio CFPB

Disposition of gas (vented, used on lease or sold) Producing interval(s)

INSTRUCTIONS: As provided in KCC Rule 82-2-125, within 90 days after completion of a well, one completed copy of this Drillers Log shall be transmitted to the State Geological Survey of Kansas, 4150 Monroe Street, Wichita, Kansas 67209. Copies of this form are available from the Conservation Division, State Corporation Commission, 245 No. Water, Wichita, Kansas 67202. Phone AC 316-522-2206. If confidential custody is desired, please note Rule 82-2-125. Drillers Logs will be on open file in the Oil and Gas Division, State Geological Survey of Kansas, Lawrence, Kansas 66044.

Operator **L & L Oil Company** DESIGNATE TYPE OF COMP.: OIL, GAS, DRY HOLE, SWDW, ETC.: **Oil**

Well No. **#7** Lease Name **Brodbeck**

S33 T 27SR22 E

WELL LOG

Show all important zones of porosity and contents thereof; cored intervals, and all drill-stem tests, including depth interval tested, cushion used, time tool open, flowing and shut-in pressures, and recoveries.

SHOW GEOLOGICAL MARKERS, LOGS RUN, OR OTHER DESCRIPTIVE INFORMATION.

FORMATION DESCRIPTION, CONTENTS, ETC.	TOP	BOTTOM	NAME	DEPTH
Soil		10		
Shale		155		
Lime		195		
Shale		256		
Lime		284		
Shale		370		
Shale/Lime		595		
Oil Sand		608		
Shale		610		

USE ADDITIONAL SHEETS, IF NECESSARY, TO COMPLETE WELL RECORD.

Date Received	<i>Lawrence G. Lamb</i>
	Signature
	Owner
	Title
	Date

53506