

8-27-6E

STATE CORPORATION COMMISSION OF KANSAS OIL & GAS CONSERVATION DIVISION

API NO. 15 - 015-22,517

County Butler

450' FNL, 990' FWL, NW Sec. 8 Twp. 27S. Rge. 6

4830 Ft North from Southeast Corner of Section 4290 Ft West from Southeast Corner of Section

Lease Name Minard Well# 1

Field Name Leon

Producing Formation Mississippian & Viola

Elevation: Ground 1382 KB 1387

WELL COMPLETION OR RECOMPLETION FORM ACO-1 WELL HISTORY

DESCRIPTION OF WELL AND LEASE

Operator: license # 5120 name Range Oil Company, Inc. address 240 Page Court 220 West Douglas City/State/Zip Wichita, Kansas 67202

Operator Contact Person John Washburn Phone (316) 265-6231

Contractor: license # 5124 name Range Drilling Company, Inc.

Wellsite Geologist Joe Baker Phone (316) 265-6231 PUP/PASER Total Petroleum

Designate Type of Completion [X] New Well [] Re-Entry [] Workover

[X] Oil [] Gas [] D [] SWD [] Inj [] Other [] Temp Abd [] Delayed Comp.

if OWWO: old well info as follows: Operator Well Name Comp. Date Old Total Depth

WELL HISTORY

Drilling Method: [X] Mud Rotary [] Air Rotary [] Cable 3-7-84 4-8-84 8-4-84 Spud Date Date Reached TD Completion Date

3137 NONE Total Depth PBTD

Amount of Surface Pipe Set and Cemented at 234 feet

Multiple Stage Cementing Collar Used? [] Yes [X] No

If Yes, Show Depth Set feet

If alternate 2 completion, cement circulated from feet depth to w/ SX cmt

Section Plat

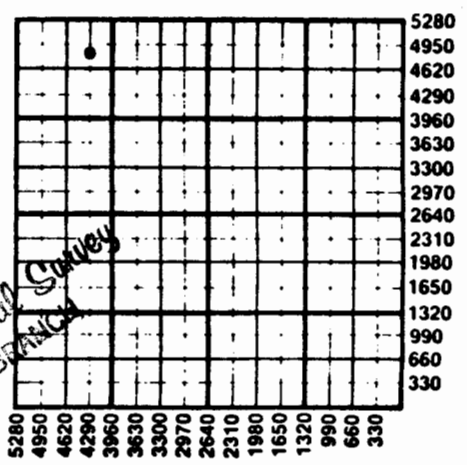

State Geological Survey WICHITA BRANCH

WATER SUPPLY INFORMATION

Source of Water:

Division of Water Resources Permit #

[] Groundwater Ft North From Southeast Corner and (Well) Ft. West From Southeast Corner of Sec Twp Rge [] East [] West

[] Surface Water Ft North From Southeast Corner and (Stream, Pond etc.) Ft West From Southeast Corner Sec Twp Rge [] East [] West

[] Other (explain) (purchased from city, R.W.D.#)

Disposition of Produced Water: [] Disposal [X] Repressuring

Docket # Applied for, Unassigned Range Oil Co., Inc. #4 King "A", Sec. 17-27S-6E

INSTRUCTIONS: This form shall be completed in duplicate and filed with the Kansas Corporation Commission, 200 Colorado Derby Building, Wichita, Kansas 67202, within 90 days after completion or recompletion of any well.

Information on side two of this form will be held confidential for a period of 12 months if requested in writing and submitted with the form.

One copy of all wireline logs and drillers time log shall be attached with this form. Submit CP-4 form with all plugged wells.

Operator Name Range Oil Company, Inc. Lease Name Minard Well# 1 SEC 8 TWP 27S RGE 6 East West

WELL LOG

INSTRUCTIONS: Show important tops and base of formations penetrated. Detail all cores. Report all drill stem tests giving interval tested, time tool open and closed, flowing and shut-in pressures, whether shut-in pressure reached static level, hydrostatic pressures, bottom hole temperature, fluid recovery, and flow rates if gas to surface during test. Attach extra sheet if more space is needed. Attach copy of log.

Drill Stem Tests Taken Yes No
 Samples Sent to Geological Survey Yes No
 Cores Taken Yes No

Formation Description
 Log Sample

Name	Top	Bottom
Lans	1815	(-428)
B/Lans	1974	(-587)
KC	2135	(-748)
BKC	2301	(-914)
Alt	2377	(-1158)
Ck	2545	(-1158)
Bv zn	2705	(-1318)
Mdol	2743	(-1356)
M.Os	2841	(-1454)
Kd	3064	(-1677)
Vi	3135	(-1748)*
RTD	3137	(-1750)
LTD	3138	(-1751)

DST #1 (2736-2752) 30-30-60-60 Blow: wk Rec: 60'
 GIP + 4' HOCM (50% oil) + 80' SOCSWM
 IFP 21-31, ISIP 539, FFP 73-63, FSIP 549,
 T: 101°F

DST #2 (3125-3137) 30-30-60-60 Blow: wk Rec: 3'
 F. O. + 65' SOCSWM (2% oil + 21,000ppm)
 IFP 20-30, ISIP 540, FFP 70-70, FSIP 550,
 T: 106°F

*Sample Top

TUBING RECORD size 2 3/8 EUE set at 3124.7 packer at No Pkr. Liner Run Yes No

Date of First Production 8-3-84 Producing method flowing pumping gas lift Other (explain)

Estimated Production Per 24 Hours	Oil	Gas	Water	Gas-Oil Ratio	Gravity
6	Bbls	0 MCF	92 Bbls	0 CFPB	

Disposition of gas: vented Open hole perforation sold used on lease other (specify) Dually Completed. Commingled

METHOD OF COMPLETION PRODUCTION INTERVAL 3136-3137 & 2746-2752

CASING RECORD new used
 Report all strings set - conductor, surface, intermediate, production, etc.

Purpose of string	size hole drilled	size casing set (in O.D.)	weight lbs/ft.	setting depth	type of cement	# sacks used	type and percent additives
Surface	12 1/2	8 5/8	23	234	Common	160	3% CaCl
Production	7 7/8	4 1/2	9.5	3136	Common	125	10% Salt, 10% GIL, 2% GEL, 1% CaCl, 0.75% F. R.

PERFORATION RECORD

Acid, Fracture, Shot, Cement Squeeze Record

shots per foot	specify footage of each interval perforated	(amount and kind of material used)	Depth
2	2746-2752	250 Gal 15% SGA 100 Gal 15% acid	3136-3137 2746-2752