

KANSAS

WELL COMPLETION REPORT AND DRILLER'S LOG

API No. 15 — 205 — 21,911
County Number

SEP 1 1981
 .S. 15 T. 28 R. 15 E
 W
 Loc. 70' FNL; 165' FEL of SE/4

State Geological Survey
 WICHITA BRANCH

County Wilson

Operator
L & L Oil Company

Address
P.O. Box 13, Benedict, KS. 66714

Well No. #1 Lease Name Baird

Footage Location
70' feet from (N) line 165' feet from (E) line of SE/4

Principal Contractor Company Tools Geologist

Spud Date May 10, 1981 Date Completed May 22, 1981 Total Depth 1085 P.B.T.D.

Directional Deviation Oil and/or Gas Purchaser
Square Deal Oil Co., Inc.

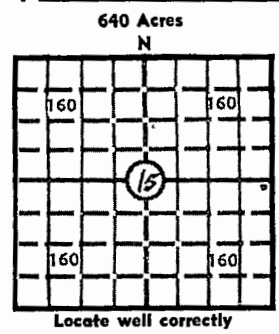

Elev.: Gr. _____
 DF _____ KB _____

CASING RECORD

Report of all strings set — surface, intermediate, production, etc.

Purpose of string	Size hole drilled	Size casing set (in O.D.)	Weight lbs/ft.	Setting depth	Type cement	Sacks	Type and percent additives
Surface	9 5/8"	7"	17#	28'	Portland A	16	
Production	5 1/8"	2 7/8"	6 1/2#	1060'	Portland A	98	

LINER RECORD

PERFORATION RECORD

Top, ft.	Bottom, ft.	Sacks cement	Shots per ft.	Size & type	Depth interval
			2	2 1/8" Alum.	1032' - 1040'

Size	Setting depth	Packer set at
1"	1030'	

ACID, FRACTURE, SHOT, CEMENT SQUEEZE RECORD

Amount and kind of material used	Depth interval treated
Fracture with 80 sacks of sand and 210 bbl gelled water	1032' - 1040'

INITIAL PRODUCTION

Date of first production September 5, 1981 Producing method (flowing, pumping, gas lift, etc.) Pumping

RATE OF PRODUCTION PER 24 HOURS	Oil	Gas	Water
	<u>3</u> bbls.		<u>5</u> bbls.

Disposition of gas (vented, used on lease or sold) _____ Producing interval (s) _____

RECEIVED
 STATE CORPORATION COMMISSION
 JUL 16 1981
 CONSERVATION DIVISION
 Wichita, Kansas

INSTRUCTIONS: As provided in KCC Rule 82-2-125, within 90 days after completion of a well, one completed copy of this Drillers Log shall be transmitted to the State Geological Survey of Kansas, 4150 Monroe Street, Wichita, Kansas 67209. Copies of this form are available from the Conservation Division, State Corporation Commission, 245 No. Water, Wichita, Kansas 67202. Phone AC 316-522-2206. If confidential custody is desired, please note Rule 82-2-125. Drillers Logs will be on open file in the Oil and Gas Division, State Geological Survey of Kansas, Lawrence, Kansas 66044.

Operator L & L Oil Company DESIGNATE TYPE OF COMP.: OIL, GAS, DRY HOLE, SWDW, ETC.: Oil

Well No. 1 Lease Name Baird

S 15 T 28 R 15 E

WELL LOG

Show all important zones of porosity and contents thereof; cored intervals, and all drill-stem tests, including depth interval tested, cushion used, time tool open, flowing and shut-in pressures, and recoveries.

SHOW GEOLOGICAL MARKERS, LOGS RUN, OR OTHER DESCRIPTIVE INFORMATION.

FORMATION DESCRIPTION, CONTENTS, ETC.	TOP	BOTTOM	NAME	DEPTH
Soil		4		
Rock		7		
Lime		44		
Shale		273		
Lime		281		
Shale		470		
Lime		566		
Shale		600		
Lime		674		
Shale		750		
Lime		791		
Shale		819		
Lime		852		
Shale		885		
Sand		899		
Shale/Sand		994		
Shale		1030		
Oil Sand		1042		
Shale		1085		

USE ADDITIONAL SHEETS, IF NECESSARY, TO COMPLETE WELL RECORD.

Date Received	Signature <i>Lawrence G Baird</i>
	Owner
	Title
	Date