

WELL LOG BUREAU - KANSAS GEOLOGICAL SOCIETY.

UNION NATIONAL BANK BLDG, WICHITA, KANSAS

Location. CNE NE

Sec. 15 T. 28 R. 16E.

Casing Record.

County. Wilson

10" Farm. Polson
 20" 8 1/2" 25 Company. Nye and Jones.
 15 1/2" 65/8" 547 Contr.
 12 1/2" 55/16" Comm. 2-21-28

No. 2

Comp. 2-29-28

Total Depth. 875 Shot Quarts Between.

Correspondence Regarding This Well Should Be Referred To.

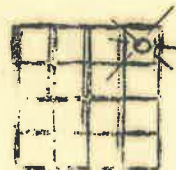

Elevation.

Figures Indicate Bottom of Formations.

Initial Production.

Date Issued. 8-19-33

GAS.

Formation	Depth.
soil	5
lime	11
shale blue	111
lime	153
shale	217
lime	235
shale	250
sand	295 wtr
shale W.	300 HFW
lime	326
shale	340
lime	430
shale	455
lime	543
shale	620
lime	625
shale	645
lime	660
shale	664
lime	683
shale W.	688
sand	698
shale	704
lime	708
shale white	760
lime	765
shale	770
lime	795
shale	825
lime	842
shale	847
lime	857 gas and water
shale blk	862 showing more gas and water
shaly shale	868
shale light	875 TD.