

KANSAS

WELL COMPLETION REPORT AND DRILLER'S LOG

API No. 15 — Crawford County — 037-20-728 Number

S. 34 T. 28 R. 22 NE E

Loc. NE/4 NE/4

County Crawford

Operator Petro American, Inc. Chadwick, Kansas 66720

Address P. O. Box 793

Well No. ONE Lease Name AUGUSTIN

Footage Location 400 feet from (N) line 710 feet from (E) line

Principal Contractor Chase Drilling Inc. Geologist

Spud Date 5-29-81 Date Completed 6-2-81 Total Depth 630 ft. P.B.T.D.

Directional Deviation Oil and/or Gas Purchaser

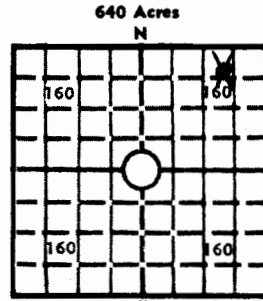

Locate well correctly Elev.: Gr. DF KB

CASING RECORD

Report of all strings set — surface, intermediate, production, etc.

Purpose of string	Size hole drilled	Size casing set (in O.D.)	Weight lbs/ft.	Setting depth	Type cement	Sacks	Type and percent additives
surface pipe	7"	6"	---	115	Class A	---	---
Producing	5 1/2"	2"	---	630	Class A	to surf.	10% salt

LINER RECORD

PERFORATION RECORD

Top, ft.	Bottom, ft.	Sacks cement	Shots per ft.	Size & type	Depth interval

TUBING RECORD

Size	Setting depth	Pecker set at

ACID, FRACTURE, SHOT, CEMENT SQUEEZE RECORD

Amount and kind of material used	Depth interval treated

INITIAL PRODUCTION

Date of first production		Producing method (flowing, pumping, gas lift, etc.)			
RATE OF PRODUCTION PER 24 HOURS	Oil bbls.	Gas MCF	Water bbls.	Gas-oil ratio	CFPB
Disposition of gas (vented, used on lease or sold)			Producing interval(s)		

INSTRUCTIONS: As provided in KCC Rule 82-2-125, within 90 days after completion of a well, one completed copy of this Drillers Log shall be transmitted to the State Geological Survey of Kansas, 4150 Monroe Street, Wichita, Kansas 67209. Copies of this form are available from the Conservation Division, State Corporation Commission, 245 No. Water, Wichita, Kansas 67202. Phone AC 316-522-2206. If confidential custody is desired, please note Rule 82-2-125. Drillers Logs will be on open file in the Oil and Gas Division, State Geological Survey of Kansas, Lawrence, Kansas 66044.

Operator Petro American, Inc. DESIGNATE TYPE OF COMP.: OIL, GAS, DRY HOLE, SWDW, ETC.:

Well No. 1 Lease Name Augustin

S 34 T 28 R 22 ^K/_W

WELL LOG
Show all important zones of porosity and contents thereof; cored intervals, and all drill-stem tests, including depth interval tested, cushion used, time tool open, flowing and shut-in pressures, and recoveries. SHOW GEOLOGICAL MARKERS, LOGS RUN, OR OTHER DESCRIPTIVE INFORMATION.

FORMATION DESCRIPTION, CONTENTS, ETC.	TOP	BOTTOM	NAME	DEPTH
Attached				

USE ADDITIONAL SHEETS, IF NECESSARY, TO COMPLETE WELL RECORD.

Date Received _____
Signature C. J. Stray
Title V.P. Operations
Date July 7/81

34-28-22w

WELL LOG REPORT *Geological Survey*
State

Company PETRO AMERICAN Contractor CHASE DRILLING
WICHITA, BRANCH
Lease Augustin Well # 1 Location 34,35-28-22

Spud Date May 29, 1981 Completion Date June 2, 1981

Casing- Surface Size 7" Depth 0 - 50
Production _____ Depth _____

Seat Nipple _____

FORMATION EVALUATION

Formation	Depth
Clay	0 - 22
Shale	22 - 43
Limestone	43 - 52
Coal	52 - 53
Shale	53 - 55
Limestone - Hard	55 - 75
Shale	75 - 76
Limestone - Hard	76 - 84
Shale	84 - 86
Coal	86 - 87
Shale	87 - 115
Sandy Limestone	115 - 123
Shale	123 - 130
Sandy Shale - odor good	130 - 145
Coal	145 - 146
Shale	146 - 151
Limestone	151 - 169
Shale	169 - 170
Coal	170 - 171
Shale	171 - 174
Limestone	174 - 182
Shale	182 - 278
Coal	278 - 280
Shale & Limestone	280 - 286
Limestone	286 - 287
Shale	287 - 294
Limestone 2' Lime	294 - 296
Shale	296 - 298

WELL LOG REPORT

Company _____ Contractor _____

Lease Augustin # 1 Well # _____ Location _____

Spud Date _____ Completion Date _____

Casing- Surface Size _____ Depth _____
Production _____ Depth _____

Seat Nipple _____

FORMATION EVALUATION

Formation	Depth
Sand ? some odor	298 - 302
Shale	302 - 324
Coal	324 - 325
Shale	325 - 330
Shale	330 - 339
Shale Lime Trace of sand	339 - 350
Lime trace - sand & shale	350 - 355
Shale	355 - 362
Sand - good odor & show	362 - 373
Shale	373 - 391
Limestone	391 - 392
Shale	392 - 450
Limestone	450 - 452
Sandy shale	452 - 459
Shale	459 - 468
limestone - soft with shale	468 - 493
Shale - some lime	493 - 510
Shale & sand No Odor	510 - 518
Sand - some shale	518 - 531
Shale	531 - 535
Coal	535 - 536
Lime & Shale	536 - 540
Shale - with sand lens	540 - 545
Shale	545 - 582
Shale - with sand	582 - 595
Break - Limestone - hard	595 - 604
Mississippi Hard	604 - 630