

15-037-20242

State Geological Survey  
KANSAS BRANCH  
DRILLERS LOG

E2 SW NW NE-KC4

S. 29 T. 28 R. 22 E W  
Loc. 1650' NSL & 625' EWL NE  
County Crawford

API No. 15 — 037 — 20,292  
County Number

Operator  
Morris Stephens

Address  
Walnut, Kansas 66780

Well No. L-4 Lease Name Engel  
#1-4

Footage Location  
1650 feet from (N) (S) line 625 feet from (E) (W) line

Principal Contractor Geologist  
Fidelity Drilling

Spud Date Total Depth P.B.T.D.  
10-12-77 375

Date Completed Oil Purchaser  
10-25-77

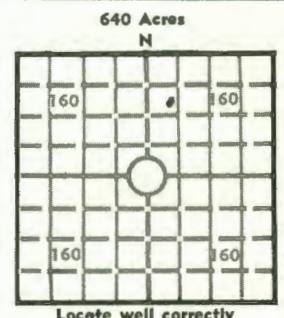

Elev.: Gr. 918  
DF \_\_\_\_\_ KB \_\_\_\_\_

CASING RECORD

Report of all strings set — surface, intermediate, production, etc.

Purpose of string	Size hole drilled	Size casing set (in O.D.)	Weight lbs/ft.	Setting depth	Type cement	Sacks	Type and percent additives
Surface	10"	8"		155'	Reg.	22	
Water Inj.	6" <del>2 3/8"</del>	2 3/8"		354'	Reg.	75	2 sacks Prem gel

LINER RECORD

PERFORATION RECORD

Top, ft.	Bottom, ft.	Sacks cement	Shots per ft.	Size & type	Depth interval

Size	Setting depth	Packer set at
2 3/8"	354	354

ACID, FRACTURE, SHOT, CEMENT SQUEEZE RECORD

Amount and kind of material used	Depth interval treated
None	

INITIAL PRODUCTION

Date of first production Producing method (flowing, pumping, gas lift, etc.)  
Water Inj.

RATE OF PRODUCTION PER 24 HOURS	Oil	Gas	Water	Gas-oil ratio
	bbls.	MCF	bbls.	CFPB

Disposition of gas (vented, used on lease or sold) Producing interval(s)

INSTRUCTIONS: As provided in KCC Rule 82-2-125, within 90 days after completion of a well, one completed copy of this Drillers Log shall be transmitted to the State Geological Survey of Kansas, 4150 Monroe Street, Wichita, Kansas 67209. Copies of this form are available from the Conservation Division, State Corporation Commission, 3830 So. Meridian (P.O. Box 17027), Wichita, Kansas 66217. Phone AC 316-522-2206. If confidential custody is desired, please note Rule 82-2-125. Drillers Logs will be on open file in the Oil and Gas Division, State Geological Survey of Kansas, Lawrence, Kansas 66044.

Operator

Morris Stephens

DESIGNATE TYPE OF COMP.: OIL, GAS, DRY HOLE, SWDW, ETC.:

Well No.

L-4

Lease Name

Engel

Water Injection

S 29 T 28 R 22 E W

WELL LOG

Show all important zones of porosity and contents thereof; cored intervals, and all drill-stem tests, including depth interval tested, cushion used, time tool open, flowing and shut-in pressures, and recoveries.

SHOW GEOLOGICAL MARKERS, LOGS RUN, OR OTHER DESCRIPTIVE INFORMATION.

FORMATION DESCRIPTION, CONTENTS, ETC.	TOP	BOTTOM	NAME	DEPTH
Sand	0	2		
clay	2	12		
shale	12	42		
lime	42	86	40 ft.	
shale	86	129		
sand	129	145	Perce	
shale	145	157		
lime	157	175	20 ft.	
shale	175	182		
lime	182	187	5 ft.	
shale	187	285		
lime	285	288	2 ft.	
shale	288	355		
sand	355	365	Barlowia	
shale	365	375	T.D.	

USE ADDITIONAL SHEETS, IF NECESSARY, TO COMPLETE WELL RECORD.

Date Received

Morris Stephens

Signature

Owner

Title

12-16-77

Date