

State Geological Survey  
WICHITA BRANCH  
KANSAS DRILLERS LOG

IMPORTANT  
Kans. Geo. Survey request  
samples on this well.

S. 33 T. 28 R. 22 <sup>E</sup>/<sub>W</sub>  
Loc. E2 NE SW SE NE-  
KC  
County Crawford

API No. 15 — 037 — 20,211  
County Number

Operator  
Stephens Oil Company  
Address  
Box 140 Walnut, Kansas 66780

Well No. #4 Lease Name Myers

Footage Location  
150 feet from (N) (S) line 150 feet from (E) (W) line

Principal Contractor Geologist

Spud Date 2-9-76 Total Depth 392 P.B.T.D.

Date Completed 2-21-76 Oil Purchaser Mid-America Ref. Co.

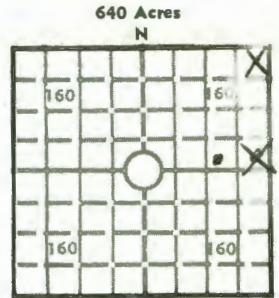

Locate well correctly  
Elev.: Gr. 104.

DF \_\_\_\_\_ KB \_\_\_\_\_

**CASING RECORD**

Report of all strings set — surface, intermediate, production, etc.

Purpose of string	Size hole drilled	Size casing set (in O.D.)	Weight lbs/ft.	Setting depth	Type cement	Sacks	Type and percent additives
<u>Prod.</u>	<u>7"</u>	<u>2 3/8"</u>	<u>3.65</u>	<u>380</u>	<u>Reg.</u>	<u>82</u>	<u>-</u>
<u>Surface</u>	<u>7"</u>	<u>6 1/4"</u>	<u>13</u>	<u>25'</u>	<u>Reg.</u>	<u>5</u>	<u>-</u>
<u>Well pumping through 1" pipe</u>							
<u>Sealing 7 pipe 375'</u>							

**LINER RECORD**

**PERFORATION RECORD**

Top, ft.	Bottom, ft.	Sacks cement	Shots per ft.	Size & type	Depth interval

**TUBING RECORD**

Size	Setting depth	Packer set at
<u>1"</u>	<u>375'</u>	<u>380'</u>

**ACID, FRACTURE, SHOT, CEMENT SQUEEZE RECORD**

Amount and kind of material used	Depth interval treated
<u>Sand Fracture - 47 sacks</u>	<u>380-382'</u>

**INITIAL PRODUCTION**

Date of first production <u>5-1-76</u>	Producing method (flowing, pumping, gas lift, etc.) <u>Pumping</u>		
RATE OF PRODUCTION PER 24 HOURS Oil <u>2</u> bbls.	Gas <u>-</u> MCF	Water <u>-</u> bbls.	Gas-oil ratio <u>-</u> CFPB
Disposition of gas (vented, used on lease or sold)		Producing interval (s) <u>380-382'</u>	

INSTRUCTIONS: As provided in KCC Rule 82-2-125, within 90 days after completion of a well, one completed copy of this Drillers Log shall be transmitted to the State Geological Survey of Kansas, 4150 Monroe Street, Wichita, Kansas 67209. Copies of this form are available from the Conservation Division, State Corporation Commission, 3830 So. Meridian (P.O. Box 17027), Wichita, Kansas 66217. Phone AC 316-522-2206. If confidential custody is desired, please note Rule 82-2-125. Drillers Logs will be on open file in the Oil and Gas Division, State Geological Survey of Kansas, Lawrence, Kansas 66044.

Operator

Stephens Oil Co.

DESIGNATE TYPE OF COMP.: OIL, GAS, DRY HOLE, SWDW, ETC.:

Well No.

4

Lease Name

Meyers

oil

S 33 T 28 S R 22 E W

WELL LOG

Show all important zones of porosity and contents thereof; cored intervals, and all drill-stem tests, including depth interval tested, cushion used, time tool open, flowing and shut-in pressures, and recoveries.

SHOW GEOLOGICAL MARKERS, LOGS RUN, OR OTHER DESCRIPTIVE INFORMATION.

FORMATION DESCRIPTION, CONTENTS, ETC.	TOP	BOTTOM	NAME	DEPTH
Soil	-	3		3
clay	3	15		12
shale	15	77		62
lime	77	115	40 ft.	38
shale	115	180		65
lime	180	201	20 ft.	21
shale	201	208		6
lime	208	214	5 ft.	6
shale	214	313		99
lime	313	315	2 ft.	2
Black shale	315	320		5
shale	320	330		10
Black shale	330	345		15
shale	345	380		35
sand	380	387	Bartlewell	7
Sandy shale	387	392		5

USE ADDITIONAL SHEETS, IF NECESSARY, TO COMPLETE WELL RECORD.

Date Received

Morris Stephens

Signature

Owner

Title

5-13-76

Date

533299