

SE SE NE  
KGS DRL 2023  
NAD 83

KANSAS  
WELL COMPLETION REPORT AND  
DRILLER'S LOG

API No. 15 — Crawford County Number

S. 33 T. 28S R. 22 E  
Loc. 170' NSL 440' WEL N1  
County Crawford

Operator Morris Stephens  
Address Box-140 Walnut, Kansas  
Well No. #5 Lease Name Morris  
Footage Location 2771 FSL  
150' feet from (X) (S) line 440' feet from (E) (X) line  
Principal Contractor Bishop Exploration Geologist  
Start Date \_\_\_\_\_ Date Completed \_\_\_\_\_ Total Depth 428 P.B.T.D. \_\_\_\_\_  
Directional Deviation 12-1-80 Oil and/or Gas Purchaser Producers Group

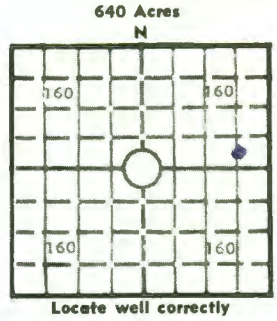

Elev.: Gr. \_\_\_\_\_  
DF \_\_\_\_\_ KB \_\_\_\_\_

CASING RECORD

Report of all strings set — surface, intermediate, production, etc.

| Purpose of string | Size hole drilled | Size casing set (in O.D.) | Weight lbs/ft. | Setting depth | Type cement | Sacks | Type and percent additives |
|-------------------|-------------------|---------------------------|----------------|---------------|-------------|-------|----------------------------|
| Surface           | 8"                | 6 1/4"                    |                | 40'           | Reg.        | 6     | —                          |
|                   | 5 1/2"            | 2 3/4"                    |                | 424'          | Reg.        | 50    | Premium Cement             |

LINER RECORD

PERFORATION RECORD

| Top, ft. | Bottom, ft. | Sacks cement | Shots per ft. | Size & type   | Depth interval |
|----------|-------------|--------------|---------------|---------------|----------------|
|          |             |              | 2             | 1 1/16 G/1000 | 383 - 393      |

TUBING RECORD

| Size | Setting depth | Packer set at |
|------|---------------|---------------|
| 1"   | 377.5         |               |

ACID, FRACTURE, SHOT, CEMENT SQUEEZE RECORD

| Amount and kind of material used               | Depth interval treated |
|--|------------------------|
| 50' 62% - 15% 10                               | 383' - 393'            |
| 309X - 20-40 sand plus - 10 sacks - 10-20 sand | 383 - 393'             |

INITIAL PRODUCTION

Date of first production \_\_\_\_\_ Producing method (flowing, pumping, gas lift, etc.) \_\_\_\_\_  
 RATE OF PRODUCTION PER 24 HOURS  
 Oil \_\_\_\_\_ bbls. Gas \_\_\_\_\_ MCF Water \_\_\_\_\_ bbls. Gas-oil ratio \_\_\_\_\_ CFPB  
 Disposition of gas (vented, used on lease or sold) \_\_\_\_\_ Producing interval(s) 383' - 393'

INSTRUCTIONS: As provided in KCC Rule 82-2-125, within 90 days after completion of a well, one completed copy of this Drillers Log shall be transmitted to the State Geological Survey of Kansas, 4150 Monroe Street, Wichita, Kansas 67209. Copies of this form are available from the Conservation Division, State Corporation Commission, 245 No. Water, Wichita, Kansas 67202. Phone AC 316-522-2206. If confidential custody is desired, please note Rule 82-2-125. Drillers Logs will be on open file in the Oil and Gas Division, State Geological Survey of Kansas, Lawrence, Kansas 66044.

Operator

DESIGNATE TYPE OF COMP.: OIL, GAS,  
DRY HOLE, SWDW, ETC.:

Morris Stephens

Well No.

#5

Lease Name

Myers

Oil

S 33 T 28 R 22 E  
W

## WELL LOG

Show all important zones of porosity and contents thereof; cored intervals, and all drill-stem tests, including depth interval tested, cushion used, time tool open, flowing and shut-in pressures, and recoveries.

SHOW GEOLOGICAL MARKERS, LOGS RUN,  
OR OTHER DESCRIPTIVE INFORMATION.

| FORMATION DESCRIPTION, CONTENTS, ETC. | TOP  | BOTTOM | NAME       | DEPTH |
|---------------------------------------|------|--------|------------|-------|
| clay                                  | 0    | 6      | clay       | 6     |
| lime                                  | 6    | 11.5   | lime       | 5.5   |
| shale                                 | 11.5 | 84     | shale      | 84    |
| lime                                  | 84   | 86     | lime       | 86    |
| shale                                 | 86   | 91     | shale      | 91    |
| lime                                  | 91   | 120    | lime       | 120   |
| shale                                 | 120  | 151    | shale      | 151   |
| sand                                  | 151  | 165    | Pruss      | 165   |
| shale                                 | 165  | 187    | shale      | 187   |
| lime                                  | 187  | 207    | lime       | 207   |
| shale                                 | 207  | 214    | shale      | 214   |
| lime                                  | 214  | 220    | lime       | 220   |
| shale                                 | 220  | 226    | shale      | 226   |
| shale                                 | 226  | 318    | shale      | 318   |
| lime                                  | 318  | 320    | lime       | 320   |
| shale                                 | 320  | 378    | shale      | 378   |
| coal                                  | 378  | 379    | coal       | 379   |
| sand                                  | 379  | 380    | part.      | 380   |
| sand                                  | 380  | 398    | sand-part. | 398   |
| sand-dark                             | 398  | 399    |            | 399   |
| shale                                 | 399  | 428    | shale      | 428   |

USE ADDITIONAL SHEETS, IF NECESSARY, TO COMPLETE WELL RECORD.

Date Received

Morris Stephens

Signature

Owner

Title

1-2-81

Date