

**IMPORTANT**  
 Kans. Geo. Survey request  
 samples on this well.

**KANSAS DRILLERS LOG**

S. 33 T. 28 R. 22 <sup>E</sup>/<sub>W</sub>

Loc. E2 NE

County Crawford

API No. 15 — 037 — 20,212  
County Number

Operator  
Stephens Oil Company

Address  
Box 140 Walnut, Kansas 66780

Well No. #6 Lease Name Myers

Footage Location  
150' feet from (S) line 150' feet from (E) line

Principal Contractor Fultz Drilling Co Geologist

Spud Date 2-29-76 Total Depth 396' P.B.T.D.

Date Completed 5-11-76 Oil Purchaser Mid-America

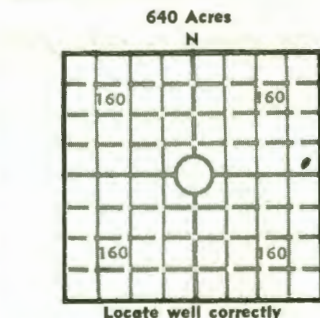

Elev.: Gr. 1060

DF \_\_\_\_\_ KB \_\_\_\_\_

**CASING RECORD**

Report of all strings set— surface, intermediate, production, etc.

| Purpose of string                             | Size hole drilled | Size casing set (in O.D.) | Weight lbs/ft. | Setting depth | Type cement | Sacks | Type and percent additives |
|---|-------------------|---------------------------|----------------|---------------|-------------|-------|----------------------------|
| surface                                       | 7"                |                           |                | 25'           | Reg.        | 5     | —                          |
| casing  | 6 1/4"            | 2 3/8"                    | 3.65           | 382'          | Reg.        | 95    | —                          |
| Well pumping through 1" pipe - seating nipple |                   |                           |                | 375'          |             |       |                            |

**LINER RECORD**

**PERFORATION RECORD**

| Top, ft.             | Bottom, ft.   | Sacks cement  | Shots per ft. | Size & type | Depth interval |
|----------------------|---------------|---------------|---------------|-------------|----------------|
| <b>TUBING RECORD</b> |               |               |               |             |                |
| Size                 | Setting depth | Packer set at |               |             |                |

**ACID, FRACTURE, SHOT, CEMENT SQUEEZE RECORD**

| Amount and kind of material used | Depth interval treated |
|----------------------------------|------------------------|
| Sand Fracture - 53 Sacks         | 382 - 393'             |

**INITIAL PRODUCTION**

|  |   |
|--|---|
| Date of first production<br><u>5-11-76</u>         | Producing method (flowing, pumping, gas lift, etc.)<br><u>Pumping</u>             |
| RATE OF PRODUCTION PER 24 HOURS                    | Oil <u>2</u> bbls. Gas <u>0</u> MCF Water <u>0</u> bbls. Gos-oil ratio _____ CFPB |
| Disposition of gas (vented, used on lease or sold) | Producing interval (s)<br><u>382 - 393'</u>                                       |

**INSTRUCTIONS:** As provided in KCC Rule 82-2-125, within 90 days after completion of a well, one completed copy of this Drillers Log shall be transmitted to the State Geological Survey of Kansas, 4150 Monroe Street, Wichita, Kansas 67209. Copies of this form are available from the Conservation Division, State Corporation Commission, 3830 So. Meridian (P.O. Box 17027), Wichita, Kansas 66217. Phone AC 316-522-2206. If confidential custody is desired, please note Rule 82-2-125. Drillers Logs will be on open file in the Oil and Gas Division, State Geological Survey of Kansas, Lawrence, Kansas 66044.

Operator \_\_\_\_\_ DESIGNATE TYPE OF COMP.: OIL, GAS, DRY HOLE, SWDW, ETC.: \_\_\_\_\_

Well No. #6 Lease Name Myers Oil

S. 33 T. 28 R. 22<sup>E</sup><sub>W</sub>

**WELL LOG**

Show all important zones of porosity and contents thereof; cored intervals, and all drill-stem tests, including depth interval tested, cushion used, time tool open, flowing and shut-in pressures, and recoveries.

SHOW GEOLOGICAL MARKERS, LOGS RUN, OR OTHER DESCRIPTIVE INFORMATION.

| FORMATION DESCRIPTION, CONTENTS, ETC. | TOP   | BOTTOM | NAME     | DEPTH |
|---------------------------------------|-------|--------|----------|-------|
| Sand                                  | 0     | 4      |          | 4     |
| clay                                  | 4     | 20     |          | 16    |
| shale                                 | 20    | 77     |          | 57    |
| Lens                                  | 77    | 114    | 40 ft.   | 37    |
| shale                                 | 114   | 124    |          | 10    |
| Lens                                  | 124   | 126    |          | 2     |
| shale                                 | 126   | 160    |          | 34    |
| sand                                  | 160   | 165    | Perce    | 5     |
| shale                                 | 165   | 183    |          | 18    |
| Lens                                  | 183   | 205    | 20 ft.   | 18    |
| shale                                 | 205   | 211    |          | 6     |
| Lens                                  | 211   | 217    | 5 ft.    | 6     |
| shale                                 | 217   | 315    |          | 98    |
| Lens                                  | 315   | 317    | 2 ft.    | 2     |
| shale                                 | 317   | 377.5  |          | 59.5  |
| coal & sand                           | 377.5 | 378.5  |          | 1     |
| Sand                                  | 378.5 | 380.5  | Barkwell | 2     |
| shale                                 | 380.5 | 383    | "        | 2.5   |
| sand - Brown                          | 383   | 387    | "        | 4     |
| sand - Dark                           | 387   | 393    | "        | 6'    |
| shale -                               | 393   | 396    |          | 3     |

USE ADDITIONAL SHEETS, IF NECESSARY, TO COMPLETE WELL RECORD.

Date Received \_\_\_\_\_

Signature: Morris Stephens

Title: Owner

Date: 5-13-76