

KANSAS

WELL COMPLETION REPORT AND DRILLER'S LOG

State Geological Survey WICHITA BRANCH

S. 34 T. 28 R. 22 E. XX

Loc. E/2 NE/4

County Crawford

API No. 15 Crawford County 15-037-20761 Number

Operator Petro American, Inc.

Address P. O. Box 793 Chanute, Kansas 66720

Well No. A-2 Lease Name Augustin

Footage Location 400 feet from (N) XSL line 300 feet from (E) XSL line

Principal Contractor Chase Drilling Geologist

Spud Date 8-18-81 Date Completed 8-20-81 Total Depth 470 P.B.T.D. 460

Directional Deviation Oil and/or Gas Purchaser

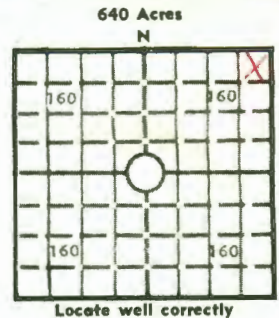

Locate well correctly Elev.: Gr. DF KB

CASING RECORD

Report of all strings set — surface, intermediate, production, etc.

Purpose of string	Size hole drilled	Size casing set (in O.D.)	Weight lbs/ft.	Setting depth	Type cement	Sacks	Type and percent additives
surface	7"	6"	---	80 ft			
production	5 1/2"	2"	---	465 ft	Class A	to surf.	2% Bentonite

LINER RECORD

PERFORATION RECORD

Top, ft.	Bottom, ft.	Sacks cement	Shots per ft.	Size & type	Depth interval

Size	Setting depth	Packer set at

ACID, FRACTURE, SHOT, CEMENT SQUEEZE RECORD

Amount and kind of material used	Depth interval treated

INITIAL PRODUCTION

Date of first production		Producing method (flowing, pumping, gas lift, etc.)			
RATE OF PRODUCTION PER 24 HOURS	Oil bbls.	Gas MCF	Water bbls.	Gas-oil ratio CFPB	
Disposition of gas (vented, used on lease or sold)			Producing interval (s)		

INSTRUCTIONS: As provided in KCC Rule 82-2-125, within 90 days after completion of a well, one completed copy of this Drillers Log shall be transmitted to the State Geological Survey of Kansas, 4150 Monroe Street, Wichita, Kansas 67209. Copies of this form are available from the Conservation Division, State Corporation Commission, 245 No. Water, Wichita, Kansas 67202. Phone AC 316-522-2206. If confidential custody is desired, please note Rule 82-2-125. Drillers Logs will be on open file in the Oil and Gas Division, State Geological Survey of Kansas, Lawrence, Kansas 66044.

Operator Petro American, Inc. DESIGNATE TYPE OF COMP.: OIL, GAS, DRY HOLE, SWDW, ETC.:

Well No. A-2 Lease Name Augustin

S 34 T 28 R 22 E
~~XX~~ E/2 NE/4

WELL LOG
Show all important zones of porosity and contents thereof; cored intervals, and all drill-stem tests, including depth interval tested, cushion used, time tool open, flowing and shut-in pressures, and recoveries. SHOW GEOLOGICAL MARKERS, LOGS RUN, OR OTHER DESCRIPTIVE INFORMATION.

FORMATION DESCRIPTION, CONTENTS, ETC.	TOP	BOTTOM	NAME	DEPTH
see attached				

USE ADDITIONAL SHEETS, IF NECESSARY, TO COMPLETE WELL RECORD.

Date Received	<p style="text-align: right;">Signature</p> <p style="text-align: center;">Vice-President Operations</p> <p style="text-align: right;">Title</p> <p style="text-align: center;">Sept. 3, 1981</p> <p style="text-align: right;">Date</p>
---------------	------------------------------------------------------------------------------------------------------------------------------------------------------------------------------------------------------------------------------------------

WELL LOG REPORT

34-28-22E

Company Petro American, Inc. Contractor Chase Drilling
Lease Augustin Well # A-2 Location _____
Spud Date Aug. 18, 1981 Completion Date Aug. 20, 1981
Surface Size 7" Depth _____
Casing _____ Depth _____

FORMATION EVALUATION

Formation	Depth
Shale	0 - 46
Limestone	46 - 50
Shale	50 - 55
Limestone	55 - 75
Shale	75 - 76
Limestone	76 - 85
Coal	85 - 87
Shale	87 -108
Sandy shale	108 -132
Sand - show gas	132 -145
Coal	145 -146
shale	146 -155
Limestone	155 -171
Coal	171 -174
Shale	174 -180
Limestone	180 -185
Coal	185 -187
Shale	187 -225
Sand stone	225 -240
Shale	240 -296
Limestone	296 -298
Shale - Limestone streaks	298 -305
Sand-gas	305 -335
Shale	335 -356
Shale and sand	356 -367
Coal	367 -368
Shale and sand	368 -370
Sand - good show good odor	370 -381
Shale	381 -470
T. D.	470