

KANSAS DRILLERS LOG *State Geological Survey*
WICHITA, BRANCH

S. 4 T. 28 R. 24 ^E/_W

Loc. 90' W C NW

County Crawford

API No. 15 — 037 — 20,138
County Number

Operator
Cities Service Oil Co.

Address 700 Sutton Place Building Wichita, Kansas 67202

Well No. #2-A Lease Name Rutherford "A"

Footage Location
feet from (N) (S) line feet from (E) (W) line

Principal Contractor EXPLORATION, INC. Geologist MARK YORK

Spud Date 9-11-74 Total Depth 292' P.B.T.D.

Date Completed 9-13-74 Oil Purchaser

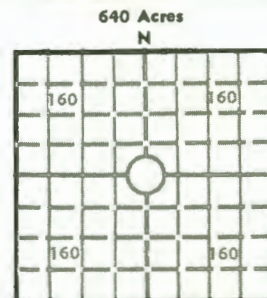

Locate well correctly

Elev.: Gr. 974'

DF _____ KB _____

CASING RECORD

Report of all strings set—surface, intermediate, production, etc.

Purpose of string	Size hole drilled	Size casing set (in O.D.)	Weight lbs/ft.	Setting depth	Type cement	Sacks	Type and percent additives
<u>SURFACE</u>	<u>8 5/8"</u>	<u>7"</u>		<u>20'</u>	<u>DID NOT CEMENT</u>		

LINER RECORD

PERFORATION RECORD

Top, ft.	Bottom, ft.	Sacks cement	Shots per ft.	Size & type	Depth interval

TUBING RECORD

Size	Setting depth	Packer set at

ACID, FRACTURE, SHOT, CEMENT SQUEEZE RECORD

Amount and kind of material used	Depth interval treated

INITIAL PRODUCTION

Date of first production		Producing method (flowing, pumping, gas lift, etc.)			
RATE OF PRODUCTION PER 24 HOURS	Oil	Gas	Water	Gas-oil ratio	
	bbls.	MCF	bbls.	CFPB	
Disposition of gas (vented, used on lease or sold)			Producing interval (s)		

INSTRUCTIONS: As provided in KCC Rule 82-2-125, within 90 days after completion of a well, one completed copy of this Drillers Log shall be transmitted to the State Geological Survey of Kansas, 4150 Monroe Street, Wichita, Kansas 67209. Copies of this form are available from the Conservation Division, State Corporation Commission, 3830 So. Meridian (P.O. Box 17027), Wichita, Kansas 66217. Phone AC 316-522-2206. If confidential custody is desired, please note Rule 82-2-125. Drillers Logs will be on open file in the Oil and Gas Division, State Geological Survey of Kansas, Lawrence, Kansas 66044.

Operator

CITGO

DESIGNATE TYPE OF COMP.: OIL, GAS, DRY HOLE, SWDW, ETC.:

Well No.

2-A

Lease Name

RUTHERFORD "A"

STRAT TEST

S 7 T 28 R 24 E

WELL LOG

Show all important zones of porosity and contents thereof; cored intervals, and all drill-stem tests, including depth interval tested, cushion used, time tool open, flowing and shut-in pressures, and recoveries.

SHOW GEOLOGICAL MARKERS, LOGS RUN, OR OTHER DESCRIPTIVE INFORMATION.

FORMATION DESCRIPTION, CONTENTS, ETC.	TOP	BOTTOM	NAME	DEPTH
ATTACHED				

USE ADDITIONAL SHEETS, IF NECESSARY, TO COMPLETE WELL RECORD.

Date Received



Don E. Taylor

Signature

SUPERVISOR - OIL & GAS SYS.

Title

10-7-74

Date