

KANSAS

WELL COMPLETION REPORT AND DRILLER'S LOG

API No. 15 — 133 — 22,290
County Number

URBANA
 S. 1 T. 295 R. 18 ^E_W
 Loc. 310 EWL 550 SNL NE4
 County Neosho

Operator
Vera Cruz Petroleum

Address
S. 6312 Helena, Spokane, WA 99203

Well No. FX-10 Lease Name Fowler

Footage Location
550 feet from (N) ~~55~~-line 330 feet from (E) (W) line

Principal Contractor H+M Oil Geologist _____

Spud Date 2/10/81 Date Completed 11-15-81 Total Depth 759 P.B.T.D. _____

Directional Deviation _____ Oil and/or Gas Purchaser Koch

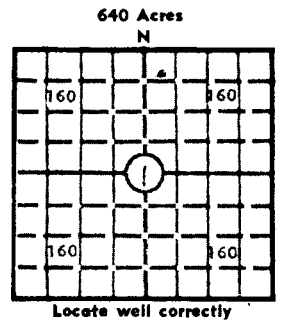

Elev.: Gr. _____
 DF _____ KB _____

CASING RECORD

Report of all strings set — surface, intermediate, production, etc.

Purpose of string	Size hole drilled	Size casing set (in O.D.)	Weight lbs/ft.	Setting depth	Type cement	Sacks	Type and percent additives
Surface	8"	6 5/8	17	60	Portland	15	
Casing	6"	2 7/8	6 1/2	759	"	95	

LINER RECORD

PERFORATION RECORD

Top, ft.	Bottom, ft.	Sacks cement	Shots per ft.	Size & type	Depth interval
			3	2 1/8 Glass	690-710

Size	Setting depth	Packer set at
1 1/2	700	

ACID, FRACTURE, SHOT, CEMENT SQUEEZE RECORD

Amount and kind of material used	Depth interval treated
Water + Sand 8000 #	690-710

INITIAL PRODUCTION

Date of first production 12/15/81 Producing method (flowing, pumping, gas lift, etc.)

RATE OF PRODUCTION PER 24 HOURS	Oil	Gas	Water	Gas-oil ratio
	<u>1/2</u> bbls.	—	<u>3</u> MCF	—

Disposition of gas (vented, used on lease or sold) _____ Producing interval (s) _____

INSTRUCTIONS: As provided in KCC Rule 82-2-125, within 90 days after completion of a well, one completed copy of this Drillers Log shall be transmitted to the State Geological Survey of Kansas, 4150 Monroe Street, Wichita, Kansas 67209. Copies of this form are available from the Conservation Division, State Corporation Commission, 245 No. Water, Wichita, Kansas 67202. Phone AC 316-522-2206. If confidential custody is desired, please note Rule 82-2-125. Drillers Logs will be on open file in the Oil and Gas Division, State Geological Survey of Kansas, Lawrence, Kansas 66044.

Operator
Vera Cruz Pet.

DESIGNATE TYPE OF COMP.: OIL, GAS,
DRY HOLE, SWDW, ETC.:
Oil

Well No.
FX-10

Lease Name
Fowler

S 1 T 29S R 18 ^E/_W

WELL LOG

Show all important zones of porosity and contents thereof; cored intervals, and all drill-stem tests, including depth interval tested, cushion used, time tool open, flowing and shut-in pressures, and recoveries.

SHOW GEOLOGICAL MARKERS, LOGS RUN, OR OTHER DESCRIPTIVE INFORMATION.

FORMATION DESCRIPTION, CONTENTS, ETC.

TOP

BOTTOM

NAME

DEPTH

Shale + Limestone
Oil Sand
Shale

GL 690
690 710
710 TV

Bart

USE ADDITIONAL SHEETS, IF NECESSARY, TO COMPLETE WELL RECORD.

Date Received

E. M. ...
Signature

Geo. ...
Title

1-15-82
Date