

WELL COMPLETION REPORT AND DRILLER'S LOG

API No. 15 — 13.3 — 22,292
 County Number

URB 2244
 S. 1 T. 29 S. R. 18 E. W
 Loc. 515 E 64 L 690 S N L N E 4
 County McOsbo

Operator Vera Cruz Petroleum
 Address S. 6312 Helena
 Well No. FX-12 Lease Name Fowler
 Footage Location
640 feet from (N) (S) line 515 feet from (E) (W) line
 Principal Contractor H+M Oil Geologist _____
 Spud Date 2/15/81 Date Completed 11/15/81 Total Depth 762 P.B.T.D. _____
 Directional Deviation _____ Oil and/or Gas Purchaser Koch

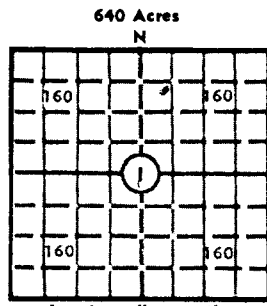

Elev.: Gr. _____
 DF _____ KB _____

CASING RECORD

Report of all strings set — surface, intermediate, production, etc.

Purpose of string	Size hole drilled	Size casing set (in O.D.)	Weight lbs/ft.	Setting depth	Type cement	Sacks	Type and percent additives
Surface	8"	6 5/8	17	60	Portland	12	
Casing	6"	2 7/8	6 1/2	762	"	100	

LINER RECORD

PERFORATION RECORD

Top, ft.	Bottom, ft.	Sacks cement	Shots per ft.	Size & type	Depth interval
			2	2 1/2 Glass	698-708

Size	Setting depth	Packer set at
1"	696	

ACID, FRACTURE, SHOT, CEMENT SQUEEZE RECORD

Amount and kind of material used	Depth interval treated
Water + Sand 8000 #	698-708

INITIAL PRODUCTION

Date of first production 12-15-81 Producing method (flowing, pumping, gas lift, etc.) _____
 RATE OF PRODUCTION PER 24 HOURS
 Oil 1 bbls. Gas — MCF Water 3 bbls. Gas-oil ratio — CFPB
 Disposition of gas (vented, used on lease or sold) _____ Producing interval (s) _____

INSTRUCTIONS: As provided in KCC Rule 82-2-125, within 90 days after completion of a well, one completed copy of this Drillers Log shall be transmitted to the State Geological Survey of Kansas, 4150 Monroe Street, Wichita, Kansas 67209. Copies of this form are available from the Conservation Division, State Corporation Commission, 245 No. Water, Wichita, Kansas 67202. Phone AC 316-522-2206. If confidential custody is desired, please note Rule 82-2-125. Drillers Logs will be on an open file in the Oil and Gas Division, State Geological Survey of Kansas, Lawrence, Kansas 66044.

Operator Vera Cruz Pet DESIGNATE TYPE OF COMP.: OIL, GAS, DRY HOLE, SWDW, ETC.: Oil

Well No. FX-12 Lease Name Fowler

S 1 T 29S R 18 E W

WELL LOG

Show all important zones of porosity and contents thereof; cored intervals, and all drill-stem tests, including depth interval tested, cushion used, time tool open, flowing and shut-in pressures, and recoveries.

SHOW GEOLOGICAL MARKERS, LOGS RUN, OR OTHER DESCRIPTIVE INFORMATION.

FORMATION DESCRIPTION, CONTENTS, ETC.	TOP	BOTTOM	NAME	DEPTH
<p>Shale + Limestone Oil Sand Shale</p>	<p>CL 698 708</p>	<p>698 708 TD</p>	<p>Bart.</p>	

USE ADDITIONAL SHEETS, IF NECESSARY, TO COMPLETE WELL RECORD.

Date Received

M. J. [Signature]
Signature
Asst. Treas.
Title
1-15-82
Date