

IMPORTANT
Kans. Geo. Survey request
samples on this well.

S. 11 T. 29 R. 22 E
W
Loc. SE SW
County Crawford

API No. 15 — 037 — 20,209
County Number

Operator
Francis J. Hayden

Address
Route #2 Girard, Kansas 66743

Well No. #1 Lease Name Francis J. Hayden

Footage Location
165 feet from (N) (S) line 165 feet from (E) (W) line

Principal Contractor Fultz Drilling Co Geologist

Spud Date 1-24-76 Total Depth 200 P.B.T.D.

Date Completed 1-31-76 Oil Purchaser

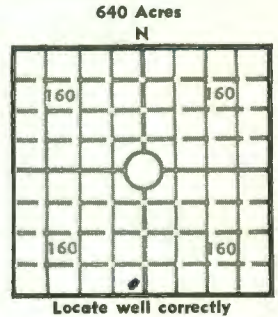

Elev.: Gr. _____
DF _____ KB _____

CASING RECORD

Report of all strings set — surface, intermediate, production, etc.

Purpose of string	Size hole drilled	Size casing set (in O.D.)	Weight lbs/ft.	Setting depth	Type cement	Sacks	Type and percent additives
<u>Surface</u>	<u>8"</u>	<u>7"</u>	<u>20</u>	<u>33</u>	<u>Portland</u>	<u>5</u>	<u>none</u>

LINER RECORD

PERFORATION RECORD

Top, ft.	Bottom, ft.	Sacks cement	Shots per ft.	Size & type	Depth interval

TUBING RECORD

Size	Setting depth	Packer set at
<u>2 3/8</u>	<u>173</u>	<u>173</u>

ACID, FRACTURE, SHOT, CEMENT SQUEEZE RECORD

Amount and kind of material used	Depth interval treated

INITIAL PRODUCTION

Date of first production <u>1-31-76</u>		Producing method (flowing, pumping, gas lift, etc.)			
RATE OF PRODUCTION PER 24 HOURS	Oil	Gas	Water	Gas-oil ratio	
		<u>Constant</u>			
Disposition of gas (vented, used on lease or sold)			Producing interval (s)		
<u>Sufficient amount for house</u>			<u>Constant</u>		

INSTRUCTIONS: As provided in KCC Rule 82-2-125, within 90 days after completion of a well, one completed copy of this Drillers Log shall be transmitted to the State Geological Survey of Kansas, 4150 Monroe Street, Wichita, Kansas 67209. Copies of this form are available from the Conservation Division, State Corporation Commission, 3830 So. Meridian (P.O. Box 17027), Wichita, Kansas 66217. Phone AC 316-522-2206. If confidential custody is desired, please note Rule 82-2-125. Drillers Logs will be on open file in the Oil and Gas Division, State Geological Survey of Kansas, Lawrence, Kansas 66044.

Operator

DESIGNATE TYPE OF COMP.: OIL, GAS, DRY HOLE, SWDW, ETC.:

Well No. # 1

Lease Name Francis Hayden

Gas

S 11 T 29 R 22 E W

WELL LOG

Show all important zones of porosity and contents thereof; cored intervals, and all drill-stem tests, including depth interval tested, cushion used, time tool open, flowing and shut-in pressures, and recoveries.

SHOW GEOLOGICAL MARKERS, LOGS RUN, OR OTHER DESCRIPTIVE INFORMATION.

FORMATION DESCRIPTION, CONTENTS, ETC.	TOP	BOTTOM	NAME	DEPTH
Soil	0	2		
Clay L	2	18		
Shale	18	55		
Lime	55	85	Fort Scott	
Shale	85	157		
Lime	157	165	Oswego	
Lime	165	177	Oswego	
Slate & Shale	177	182	Gas	
Lime	182	190		
Slate & Shale	190	195	Gas	
Shale	195	200	J.D.	
Packer Set 173				

USE ADDITIONAL SHEETS, IF NECESSARY, TO COMPLETE WELL RECORD.

Date Received

1-24-76

x Francis J. Hayden

Signature

owner

Title

2-4-76

Date