

STATE CORPORATION COMMISSION OF KANSAS
OIL & GAS CONSERVATION DIVISION

WELL COMPLETION OR RECOMPLETION FORM
ACO-1 WELL HISTORY

DESCRIPTION OF WELL AND LEASE

Operator: License # 5472
Name Hoppe Oil & Gas Company, Inc.
Address 2400 N. Woodlawn, Ste. #211
City/State/Zip Wichita, Kansas, 67220

Purchaser Koch Oil Company
P. O. Box 2256, Wichita, Ks. 67201

Operator Contact Person Rick A. Hoppe
Phone 316/683-0766

Contractor: License # 5676
Name Edco Drilling, Inc.

Wellsite Geologist Rick A. Hoppe
Phone 316/683-0766

Designate Type of Completion

- New Well Re-Entry Workover
- Oil SWD Temp Abd
- Gas Inj Delayed Comp.
- Dry Other (Core, Water Supply etc.)

If OWWO: old well info as follows:

Operator
Well Name
Comp. Date Old Total Depth

WELL HISTORY

Drilling Method:

- Mud Rotary Air Rotary Cable

12/9/85 12/14/85 2/5/86
Spud Date Date Reached TD Completion Date

2360
Total Depth PBDT

Amount of Surface Pipe Set and Cemented at 62.32 feet
Multiple Stage Cementing Collar Used? Yes No
If yes, show depth set.....feet
If alternate 2 completion, cement circulated from 2360 feet depth to Surface/350 SX cmt

INSTRUCTIONS: This form shall be completed in duplicate and filed with the Kansas Corporation Commission, 200 Colorado Derby Building, Wichita, Kansas 67202, within 90 days after completion or recompletion of any well. Rule 82-3-130 and 82-3-107 apply.
Information on side two of this form will be held confidential for a period of 12 months if requested in writing and submitted with the form. See rule 82-3-107 for confidentiality in excess of 12 months.
One copy of all wireline logs and drillers time log shall be attached with this form. Submit CP-4 form with all plugged wells. Submit CP-111 form with all temporarily abandoned wells.

All requirements of the statutes, rules and regulations promulgated to regulate the oil and gas industry have been fully complied with and the statements herein are complete and correct to the best of my knowledge.

Signature [Signature]
Title Vice President / Geologist Date 4/1/86

Subscribed and sworn to before me this 1st day of April 1986.
Notary Public [Signature]

Date Commission Expires 4-28-87

Fayo L. Braley
NOTARY PUBLIC
State of Kansas
My Appt. Exp: 4-28-87

API NO. 15-049-21,998
County Elk
G.S./2-SE-SE... Sec. 15 Twp. 30S Rge. 10...
330 Ft North from Southeast Corner of Section
660 Ft West from Southeast Corner of Section
(Note: Locate well in section plat below)
Lease Name Bauder Well # C.#4
Field Name Mills
Producing Formation Mississippi
Elevation: Ground 1051 KB 1056

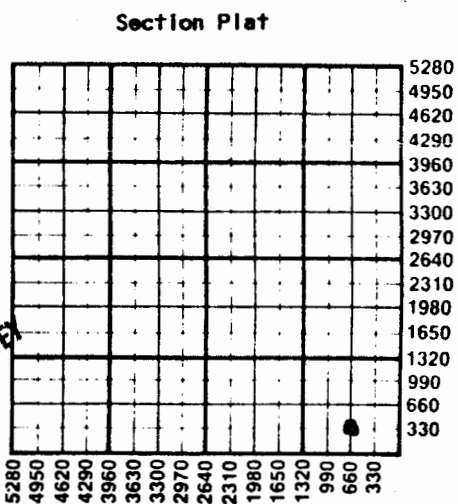

APR 21 1986
STATE CORPORATION COMMISSION
WICHITA BRANCH

WATER SUPPLY INFORMATION
Disposition of Produced Water: Disposal Repressuring
Docket # CR-8832 (C-22,224)

Questions on this portion of the ACO-1 call:
Water Resources Board (913) 296-3717
Source of Water:
Division of Water Resources Permit #.....
 Groundwater.....Ft North from Southeast Corner (Well)Ft West from Southeast Corner of Sec Twp Rge East West
 Surface Water..330 Ft North from Southeast Corner (Stream, pond etc) 1980 Ft West from Southeast Corner Sec 15 Twp 30S Rge 10 East West
FARM POND WATER
 Other (explain).....
(purchased from city, R.W.D. #)

K.C.C. OFFICE USE ONLY
F Letter of Confidentiality Attached
C Wireline Log Received
C Drillers Timelog Received
Distribution
 KCC SWD/Rep NGPA
 KGS Plug Other (Specify)

APR 18 1986
STATE CORPORATION COMMISSION
CONSERVATION DIVISION
Wichita, Kansas

Sec. 15 Twp. 30S Rge. 10E

Operator Name ..Hoppa Oil & Gas Company, Inc..... Lease Name.....Bauder.....Well #...C.#4

Sec...15... Twp...30S... Rge...10... East West County.....Elk.....

WELL LOG

INSTRUCTIONS: Show important tops and base of formations penetrated. Detail all cores. Report all drill stem tests giving interval tested, time tool open and closed, flowing and shut-in pressures, whether shut-in pressure reached static level, hydrostatic pressures, bottom hole temperature, fluid recovery, and flow rates if gas to surface during test. Attach extra sheet if more space is needed. Attach copy of log.

Drill Stem Tests Taken Yes No
 Samples Sent to Geological Survey Yes No
 Cores Taken Yes No

Formation Description
 Log Sample

15-30S-10E
 Bauder C #A

Name	Top	Bottom
Mississippi Chert Cht, bl-gy mot to blk, fos, frsh, shp.	2004	2006
Miss. Dolomite Dolo, gy to crm-bn, mot. lmy, med xl w/fr to gd fn pin-pt por. gd sh FO in pin-pt por. Cht, wh to crm, pyr, trip, fn pin-pt. por w/gd shw FO.	2006	2016
Miss. Lime Ls, bn to cum-bn, fn xl, p to fn inter-xl por, frly dns, hd, sh FO, some App dd.	2016	
Arbuckle Ls, Crm-tan, fnxl, p vis por, frly dnse, hd. No shw.	2041	

*Cement for long string used:
 200 sacks Howcolite
 50 sacks Class A w/2% Gel and 2% CaCl
 100 sacks 50/50 poz w/2% caCl
 25 Gal. Latex mixed w/Class A and 50/50 Poz.

CASING RECORD <input type="checkbox"/> New <input type="checkbox"/> Used							
Report all strings set-conductor, surface, intermediate, production, etc.							
Purpose of String	Size Hole Drilled	Size Casing Set (in O.D.)	Weight Lbs/Ft.	Setting Depth	Type of Cement	#Sacks Used	Type and Percent Additives
..Surface.....	..12 1/4..7".....62.32..	Portland	403% CaCl.
..Production...6 1/4..4 1/2".....	*See Above

PERFORATION RECORD		Acid, Fracture, Shot, Cement Squeeze Record	
Shots Per Foot	Specify Footage of Each Interval Perforated	(Amount and Kind of Material Used)	Depth
.....Two.....2006 - 2014.....500 Gal. Mud Acid.....2006-14
.....1000 Gal. Mud 202.....2006-14

TUBING RECORD	Size	Set At	Packer at	Liner Run	<input type="checkbox"/> Yes <input type="checkbox"/> No
	2 3/8"	1991			

Date of First Production	Producing Method
Feb. 5, 1986	<input type="checkbox"/> Flowing <input checked="" type="checkbox"/> Pumping <input type="checkbox"/> Gas Lift <input type="checkbox"/> Other (explain).....

Estimated Production Per 24 Hours	Oil	Gas	Water	Gas-Oil Ratio	Gravity
	18 Bbls	None MCF	55 Bbls	CFPB	36 ⁰

METHOD OF COMPLETION : Production Interval

Disposition of gas: Vented Open Hole Perforation
 Sold Other (Specify)2006-2014.....
 Used, on Lease Dually Completed
 None Commingled

15-30S-10E