

KANSAS DRILLERS LOG

State Geological Survey
WICHITA, BRANCH

11-31-20E
JUL

API No. 15 — County Number

S. 11 T. 31 R. 20^E
Loc. NE $\frac{1}{4}$, NE $\frac{1}{4}$, NE $\frac{1}{4}$, SE $\frac{1}{4}$
County Labette

Operator
Missouri Lead-Zinc Co.

Address
1705 N. Walnut, Pittsburg, Ks. 66762

Well No. 1 Lease Name J.F. Baker

Footage Location
2600 feet from (N) line 100 feet from (E) line

Principal Contractor Joy Spradling Drilling Geologist E.H. Hare

Spud Date 1/27/78 Total Depth 925' P.B.T.D.

Date Completed 1/29/78 Oil Purchaser

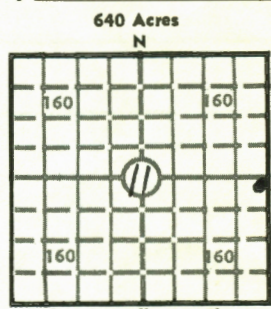

640 Acres
N
Locate well correctly
Elev.: Gr. +880 topog.
DF _____ KB _____

CASING RECORD

Report of all strings set — surface, intermediate, production, etc.

Purpose of string	Size hole drilled	Size casing set (in O.D.)	Weight lbs/ft.	Setting depth	Type cement	Sacks	Type and percent additives
Surface	9"	7"		21'	Portland		

LINER RECORD

PERFORATION RECORD

Top, ft.	Bottom, ft.	Sacks cement	Shots per ft.	Size & type	Depth interval

Size	Setting depth	Packer set at

ACID, FRACTURE, SHOT, CEMENT SQUEEZE RECORD

Amount and kind of material used	Depth interval treated

INITIAL PRODUCTION

Date of first production		Producing method (flowing, pumping, gas lift, etc.)			
RATE OF PRODUCTION PER 24 HOURS	Oil	Gas	Water	Gas-oil ratio	CFPB
	bbis.	MCF	bbis.		
Disposition of gas (vented, used on lease or sold)			Producing interval (s)		

RECEIVED
STATE CORPORATION COMMISSION

MAY 29 1979

CONSERVATION DIVISION
WICHITA

INSTRUCTIONS: As provided in KCC Rule 82-2-125, within 90 days after completion of a well, one completed copy of this Drillers Log shall be transmitted to the State Geological Survey of Kansas, 4150 Monroe Street, Wichita, Kansas 67209. Copies of this form are available from the Conservation Division, State Corporation Commission, 3830 So. Meridian (P.O. Box 17027), Wichita, Kansas 66217. Phone AC 316-522-2206. If confidential custody is desired, please note Rule 82-2-125. Drillers Logs will be on open file in the Oil and Gas Division, State Geological Survey of Kansas, Lawrence, Kansas 66044.

Operator Missouri Lead-Zinc Co.		DESIGNATE TYPE OF COMP.: OIL, GAS, DRY HOLE, SWDW, ETC.: dry
Well No. 1	Lease Name J.F. Baker	
S 11 T 31 R 20 ^E		

WELL LOG

Show all important zones of porosity and contents thereof; cored intervals, and all drill-stem tests, including depth interval tested, cushion used, time tool open, flowing and shut-in pressures, and recoveries.

SHOW GEOLOGICAL MARKERS, LOGS RUN, OR OTHER DESCRIPTIVE INFORMATION.

FORMATION DESCRIPTION, CONTENTS, ETC.	TOP	BOTTOM	NAME	DEPTH
Overburden	0	12		
Shale	12	18		
Lime	18	36		
Shale	36	39		
Lime	39	41		
Shale	41	105		
Lime	105	122		
Shale	122	130		
Lime	130	142		
Shale	142	594		
Lime & chert - Mississippian	594	895		
Shale, green - Northview gas in Miss. Chats	895	905		
Lime	905	915		
Arbuckle dolomite	915	925		
Water at 720', approx. 30 gpm				
" " 740', " 200 gpm				
Tri-cone at 740' to 925'				

USE ADDITIONAL SHEETS, IF NECESSARY, TO COMPLETE WELL RECORD.

Date Received	Signature
	Title
	Date

685175

11-31-906