

State Geological Survey
WICHITA BRANCH

3-31-NE 31 R. 21E P1

KANSAS DRILLERS LOG

S. 3 T. 31 R. 21E

API No. 15 — 099 — 21,125
County Number

Loc. NE SW

Operator
Hickory Creek Oil Co.

RECEIVED
STATE CORPORATION COMMISSION

County **LALETTE**

Address
Box 379, **Parsons, KS 67357**

AUG 15 1983

Well No. 43 Lease Name **Devlin**

CONSERVATION DIVISION
Wichita, Kansas

Footage Location
2475 feet from (N) (S) line 1485 feet from (E) (W) line

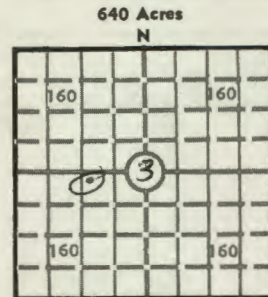

Locate well correctly
Elev.: Gr. 837.32'

Principal Contractor **VW & B Drilling** Geologist **M. R. Gray**

Spud Date 2-16-80 Total Depth 301 P.B.T.D.

Date Completed 2-19-80 Oil Purchaser **Eureka Crude Purchasing**

DF _____ KB _____

CASING RECORD

Report of all strings set — surface, intermediate, production, etc.

Purpose of string	Size hole drilled	Size casing set (in O.D.)	Weight lbs/ft.	Setting depth	Type cement	Sacks	Type and percent additives
Surface	9"	7"	20lbs	47'	portland	5	
Production	6½"	4½"	9 lbs	285'	portland	32	

LINER RECORD

PERFORATION RECORD

Top, ft.	Bottom, ft.	Sacks cement	Shots per ft.	Size & type	Depth interval
			1	80 g. WHC	167-174
			1	80 g. WHC	179-183
			1	80 g. WHC	187-190

TUBING RECORD

ACID, FRACTURE, SHOT, CEMENT SQUEEZE RECORD

Amount and kind of material used	Depth interval treated
X-linked gelled water	10,000# sand
	167-190

INITIAL PRODUCTION

Date of first production <u>7-80</u>	Producing method (flowing, pumping, gas lift, etc.)			
RATE OF PRODUCTION PER 24 HOURS	Oil <u>1.5</u> bbls.	Gas _____ MCF	Water <u>19</u> bbls.	Gas-oil ratio _____ CFPB
Disposition of gas (vented, used on lease or sold)			Producing interval (s) Skinner sandstone	

INSTRUCTIONS: As provided in KCC Rule 82-2-125, within 90 days after completion of a well, one completed copy of this Drillers Log shall be transmitted to the State Geological Survey of Kansas, 4150 Monroe Street, Wichita, Kansas 67209. Copies of this form are available from the Conservation Division, State Corporation Commission, 3830 So. Meridian (P.O. Box 17027), Wichita, Kansas 66217. Phone AC 316-522-2206. If confidential custody is desired, please note Rule 82-2-125. Drillers Logs will be on open file in the Oil and Gas Division, State Geological Survey of Kansas, Lawrence, Kansas 66044.

Operator
Hickory Creek Oil Co. DESIGNATE TYPE OF COMP. OIL, GAS,
DRY HOLE, SWDW, ETC.:

Well No. # 43 Lease Name W. Devlin

S 3 T 31 R 21 ^E ~~W~~ NE, SW

WELL LOG

Show all important zones of porosity and contents thereof; cored intervals, and all drill-stem tests, including depth interval tested, cushion used, time tool open, flowing and shut-in pressures, and recoveries.

SHOW GEOLOGICAL MARKERS, LOGS RUN, OR OTHER DESCRIPTIVE INFORMATION.

FORMATION DESCRIPTION, CONTENTS, ETC.	TOP	BOTTOM	NAME	DEPTH
Top Soil	0	1		
Gray Clay	1	6		
Yellow Clay	6	15		
Gray Clay	15	18		
River Gravel	18	20		
Lime	20	26		
Dk. Shale	26	30		
Blk. Shale	30	33		
Lime	33	45		
Blk. Shale	45	49		
Lt. Shale	49	60		
Med. Shale	60	136		
Med. Shale	136	145		
Lt. Shale	145	149		
Dk. Shale	149	155		
Lt. Shale - start core @ 161'	155	161		
Top of sand @ 165'	161	165		
Sandstone	165	168		
Shale	168	170		
Sandstone	170	174		
Shale	174	187		
Sandstone	187	190		
Shale	190	194		
Sandstone	194	195		
Shale	195	198		
Sandstone - end of core @ 261'	198	261		
Coal & Sand	261	269		
Dk. Shale	269	273		
Lt. Shale	273	282		
Med. Shale	282	287		
Lt. Shale	287	291		
Red Shale	291	292		
Lt. Shale	292	295		
Green Shale	295	301		

USE ADDITIONAL SHEETS, IF NECESSARY, TO COMPLETE WELL RECORD.

Date Received	<p style="text-align: right;"><i>[Signature]</i> Signature</p> <p style="text-align: center;">Operations Manager Title</p> <p style="text-align: center;">August 12, 1983 Date</p>
----------------------	--

2-31-91E