

KANSAS

3-31-21E Und. p1

WELL COMPLETION REPORT AND DRILLER'S LOG

S. 3 T. 31 R. 21 E. ~~W~~X

API No. 15 — 099 — 21,139  
County Number

Loc. NE SW

County Labette

Operator Hickory Creek Oil Co.

RECEIVED STATE CORPORATION COMMISSION

Address Box 379, Parsons, Ks. 67357

Well No. # 49. Lease Name W.. Devlin

AUG 15 1983

Footage Location 1815 feet from (N) (S) line 1485 feet from (E) (W) line

CONSERVATION DIVISION Wichita, Kansas

Principal Contractor VW & B Drilling Geologist M. R. Gray

Spud Date 3-4-80 Date Completed 3-6-80 Total Depth 301' P.B.T.D.

Directional Deviation Oil and/or Gas Purchaser Eureka Crude Purchasing

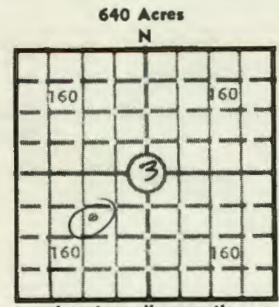

Elev.: Gr. 838.12'

DF \_\_\_\_\_ KB \_\_\_\_\_

State Geological Survey WICHITA BRANCH

CASING RECORD

Report of all strings set — surface, intermediate, production, etc.

Purpose of string	Size hole drilled	Size casing set (in O.D.)	Weight lbs/ft.	Setting depth	Type cement	Sacks	Type and percent additives
Surface	9"	7"	20 lbs	47'	portland	4	
Production	6 1/2"	4 1/2"	9 lbs	285'	portland	35	1 sk prem gel

LINER RECORD

PERFORATION RECORD

Top, ft.	Bottom, ft.	Sacks cement	Shots per ft.	Size & type	Depth interval
			2	80g. WHC	182.5 - 187

Size	Setting depth	Packer set at

ACID, FRACTURE, SHOT, CEMENT SQUEEZE RECORD

Amount and kind of material used	Depth interval treated
X-linked gel 10,000# sand	182.5 - 187'

INITIAL PRODUCTION

Date of first production 8-80	Producing method (flowing, pumping, gas lift, etc.)
RATE OF PRODUCTION PER 24 HOURS	Oil 3 bbls. Gas _____ MCF Water 30 bbls. Gas-oil ratio _____ CFPB
Disposition of gas (vented, used on lease or sold)	Producing interval (s) Skinner sandstone

INSTRUCTIONS: As provided in KCC Rule 82-2-125, within 90 days after completion of a well, one completed copy of this Drillers Log shall be trans-

Operator Hickory Creek Oil Co. DESIGNATE TYPE OF COMP. OIL, GAS,  
 DRY HOLE, SWDW, ETC.:

Well No. # 49 Lease Name W. Devlin

S 3 T 31 R 21 <sup>E</sup><sub>W</sub> NE, SW  
 XXX

**WELL LOG**

Show all important zones of porosity and contents thereof; cored intervals, and all drill-stem tests, including depth interval tested, cushion used, time tool open, flowing and shut-in pressures, and recoveries.

SHOW GEOLOGICAL MARKERS, LOGS RUN, OR OTHER DESCRIPTIVE INFORMATION.

FORMATION DESCRIPTION, CONTENTS, ETC.	TOP	BOTTOM	NAME	DEPTH
Top Soil	0	1		
Gray Clay	1	10		
Yellow Clay	10	16		
River Gravel	16	17		
Lime	17	31		
Med. Shale	31	32		
Blk. Shale	32	37		
Lt. Shale	37	38		
Lime	38	51		
Blk. Shale	51	56		
Lt. Shale	56	61		
Lime	61	63		
Sand (gas)	63	71		
Med. Shale	71	140		
Dk. Shale	140	146		
Med. Shale	146	157		
Lime	157	158		
Med. Shale	158	164		
Lt. Shale	164	174		
Med. Shale- Start Core 182	174	182		
Stop Core 270				
Bartlesville Sand	182	256		
Lt. Shale	256	265		
Coal	265	266		
Med. Shale	266	273		
Lt. Shale	273	282		
Med. Shale	282	290		
Lt. Shale	290	301		

USE ADDITIONAL SHEETS, IF NECESSARY, TO COMPLETE WELL RECORD.

Date Received	Signature <u>[Signature]</u>
	Operations Manager
	Title
	Date <u>August 12, 1983</u>

3-31-91E