

34-31-6E

KANSAS

State Geological Survey
WICHITA BRANCH

WELL COMPLETION REPORT AND
DRILLER'S LOG

S. 34 T. 31 R. 6 E
XX

API No. 15 — 035 — 22,515
County Number

Loc. SE c
County COWLEY

Operator
DUPONT OIL CO.

Address
660 Edgewater Rd., Wichita, KS 67230

Well No. 1 Lease Name Gatton

Footage Location
330 feet from ~~400~~ (S) line 330 feet from (E) ~~330~~ line

Principal Contractor Edco Drlg. Co. Geologist Mervyn Mace

Spud Date 5-12-80 Date Completed 5-17-80 Total Depth 2600 P.B.T.D.

Directional Deviation Oil and/or Gas Purchaser Clear Creek -Oil; Cities-Gas

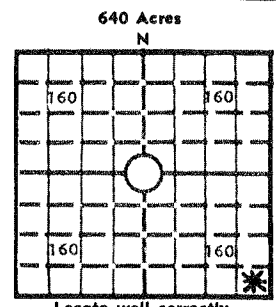

Locate well correctly
Elev.: Gr. 1336
DF KB 1341

CASING RECORD

Report of all strings set — surface, intermediate, production, etc.

Purpose of string	Size hole drilled	Size casing set (in O.D.)	Weight lbs/ft.	Setting depth	Type cement	Sacks	Type and percent additives
Surface		8 5/8		200			
Production		4 1/2		2600			

LINER RECORD

PERFORATION RECORD

Top, ft.	Bottom, ft.	Sacks cement	Shots per ft.	Size & type	Depth interval
			2		2510-40

TUBING RECORD

Size	Setting depth	Packer set at

ACID, FRACTURE, SHOT, CEMENT SQUEEZE RECORD

Amount and kind of material used	Depth interval treated
250 GA. Frac'd w 1000 BW + Sd.	2510-40

INITIAL PRODUCTION

Date of first production	Producing method (flowing, pumping, gas lift, etc.) Pumping
RATE OF PRODUCTION PER 24 HOURS	Oil 30 bbls. Gas 17.4 MCF Water 100 bbls. Gas-oil ratio 580 CFPB
Disposition of gas (vented, used on lease or sold) Vented at first. Now sold to Cities Ser. Gas Co.	Producing interval (s) 2510-40

INSTRUCTIONS: As provided in KCC Rule 82-2-125, within 90 days after completion of a well, one completed copy of this Drillers Log shall be transmitted to the State Geological Survey of Kansas, 4150 Monroe Street, Wichita, Kansas 67209. Copies of this form are available from the Conservation Division, State Corporation Commission, 245 No. Water, Wichita, Kansas 67202. Phone AC 316-522-2206. If confidential custody is desired, please note Rule 82-2-125. Drillers Logs will be on open file in the Oil and Gas Division, State Geological Survey of Kansas, Lawrence, Kansas 66044.

Operator
DuPONT OIL CO.

DESIGNATE TYPE OF COMP.: OIL, GAS,
DRY HOLE, SWDW, ETC.:

Well No. 1 Lease Name Gatton

Oil & Gas

S 34 T 31 R 6 E
XX

WELL LOG

Show all important zones of porosity and contents thereof; cored intervals, and all drill-stem tests, including depth interval tested, cushion used, time tool open, flowing and shut-in pressures, and recoveries.

SHOW GEOLOGICAL MARKERS, LOGS RUN,
OR OTHER DESCRIPTIVE INFORMATION.
SAMPLE TOPS

FORMATION DESCRIPTION, CONTENTS, ETC.	TOP	BOTTOM	NAME	DEPTH
			LAYTON	2162
			KANSAS CITY	2289
			CLEVELAND	2473
			Altamont	2534

USE ADDITIONAL SHEETS, IF NECESSARY, TO COMPLETE WELL RECORD.

Date Received

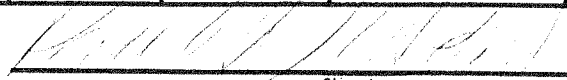

Signature

OPERATOR & PART OWNER

Title

JUNE 26, 1981

Date

34-31-9E