

KANSAS

State Geological Survey
WICHITA BRANCH

34-31-6E

WELL COMPLETION REPORT AND
DRILLER'S LOG

API No. 15 — 035 — 22,812
County Number

S. 34 T. 31 R. 6E E W
Loc. NE SW SE
County Cowley

Operator DuPont Oil Co.

Address 660 Edgewater Road, Wichita, Kansas 67230

Well No. 6 Lease Name Gatton

Footage Location 2310
feet from (N) (X) line 1650 feet from (E) (W) line

Principal Contractor Edco Drilling Co. Geologist Mervyn Mace

Spud Date 5-10-81 Date Completed 5-15-81 Total Depth 2640 P.B.T.D.

Directional Deviation Oil and/or Gas Purchaser Clear Creek Oil; Cities Service

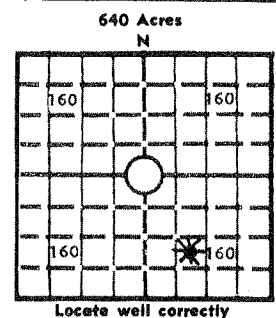

Elev.: Gr. 1354
DF KB 1359

CASING RECORD

Report of all strings set — surface, intermediate, production, etc.

Purpose of string	Size hole drilled	Size casing set (in O.D.)	Weight lbs/ft.	Setting depth	Type cement	Sacks	Type and percent additives
Surface	12 1/4	8 5/8		174			
Production	7 7/8	4 1/2		2640			

LINER RECORD

PERFORATION RECORD

Top, ft.	Bottom, ft.	Sacks cement	Shots per ft.	Size & type	Depth interval
			2		2552-80

TUBING RECORD

Size	Setting depth	Packer set at

ACID, FRACTURE, SHOT, CEMENT SQUEEZE RECORD

Amount and kind of material used	Depth interval treated
250 GA; Frac'd w/1000 BW + sd	2552-80

INITIAL PRODUCTION

Date of first production	Producing method (flowing, pumping, gas lift, etc.) Pumping					
RATE OF PRODUCTION PER 24 HOURS	Oil 45 bbls.	Gas 26.1 MCF	Water 105 bbls.	Gas-oil ratio 580	CFPB	
Disposition of gas (vented, used on lease or sold) Vented at first. Now sold to Cities Service Gas Co.			Producing interval (s) 2552-80			

INSTRUCTIONS: As provided in KCC Rule 82-2-125, within 90 days after completion of a well, one completed copy of this Drillers Log shall be transmitted to the State Geological Survey of Kansas, 4150 Monroe Street, Wichita, Kansas 67209. Copies of this form are available from the Conservation Division, State Corporation Commission, 245 No. Water, Wichita, Kansas 67202. Phone AC 316-522-2206. If confidential custody is desired, please note Rule 82-2-125. Drillers Logs will be on open file in the Oil and Gas Division, State Geological Survey of Kansas, Lawrence, Kansas 66044.

Operator DuPont Oil Co. DESIGNATE TYPE OF COMP.: OIL, GAS, DRY HOLE, SWDW, ETC.:

Well No. 6 Lease Name Gatton Oil & Gas

S 34 T 31 R 6E W

WELL LOG
 Show all important zones of porosity and contents thereof; cored intervals, and all drill-stem tests, including depth interval tested, cushion used, time tool open, flowing and shut-in pressures, and recoveries.
 SHOW GEOLOGICAL MARKERS, LOGS RUN, OR OTHER DESCRIPTIVE INFORMATION.
 Log Tops

FORMATION DESCRIPTION, CONTENTS, ETC.	TOP	BOTTOM	NAME	DEPTH
			Layton	2209
			Kansas City	2335
			Cleveland	2540
			Altamont	2580

USE ADDITIONAL SHEETS, IF NECESSARY, TO COMPLETE WELL RECORD.

Date Received _____

Signature _____
 Operator & Part Owner
 Title _____
 June 26, 1981.
 Date _____

34-31-6E